

FastTest[®]

Your Productivity Connection

*PRESSURE TESTING
AND PROCESSING IN*
**Refrigeration
Applications**



FastTest[®]
Your Productivity Connection

INTRODUCTION

FasTest Refrigeration ...

FasTest is a dedicated and innovative developer of advanced connection tools that are easier, safer and more reliable while dramatically lowering your operating costs. Since 1985 **FasTest** is recognized for having proven, dependable refrigeration process connectors with industry leading designs for superior performance for industry leading manufacturers.

Used by major manufactures of air conditioners, heat pumps, ice machines and coolers, **FasTest** process connectors have become the standard for safe and reliable connection requirements. Ergonomic designs and easy maintenance makes **FasTest** the industry preferred connector source.



The CoreMax Advantage ...



Imagine a system with no process tubes or Schrader Valves, no online pinching and brazing operation and no leaky valves. **FasTest**, the innovator of the highest quality and safest connectors in the industry has done it again. The **CoreMax** System has been designed to reduce evacuation times, improve quality, provide greater throughput, with less maintenance costs makes it all possible. Currently being used throughout the industry. **CoreMax** has proven to improve vacuum to maximize SEER rating, improved sealing to maximize first-pass yield and reduce manufacturing costs.

Learn more about that **CoreMax** System by visiting www.fastestinc.com or call 800-444-2373 for a free process evaluation.

Learn More at www.fastestinc.com ...

- Choose a connector that's right for your application
- Find a distributor near you
- Purchase replacement seals and repair kits
- Watch demonstrational videos
- Access our ReConnect connector refurbishment/replacement program
- Follow us in real time



CONNECTOR SELECTION GUIDE

CoreMax High Flow Refrigerant Valve and Related Components



Pages 4 - 8

"FN" FasMate Series for Internal Threads



Pages 9 - 17

"JNL" & "JXL" Series, Grip and Seal Smooth Tube Connectors



Pages 18 - 22

CoreMax

FasMate

JNL - JXL

ST - XT

MBE - MRE

RQD

TwistMate

"ST" & "XT" Series, Grip and Seal Smooth and Formed Tubes



Pages 23 - 24

"MBE" & "MRE" for Expanded Tubes



Page 25

RQD for Connecting Under Pressure to Process Tips



Pages 26 -27

"MIT" & "MET" TwistMate Series Twist to Connect - Threads



Pages 28 - 33

Application Evaluation Form
 ReConnect Refurbishment Program
 Warranty

Page 34

Page 35

Page 35

CoreMax®

FasTest's CoreMax is revolutionizing the manufacturing of refrigeration systems with reduced evacuation times, improved quality, greater throughput and less maintenance costs. The **CoreMax** system eliminates process tubes and Schrader valves and provides a variety of benefits depending on how you implement.



Lowest Tool Cost and Easy to Implement

Processing through the high flow **CoreMax** valve is as fast as most 1/4" process tubes and connectors. Therefore with the additional flow, and dramatically better sealing it is possible to process directly through the valve. The valve is installed at the beginning of the refrigeration unit's assembly and a **SnapMate** connector is used at every manufacturing station.

Processing refrigerant through the seat with the **CoreMax** valve removed is the **FasTest** way to evacuate and charge refrigeration systems. Processing through the seat allows for the greatest flow and therefore the shortest processing time. At the evacuation stations the Core Insertion tool is used to first evacuate the unit and then insert the **CoreMax** valve when evacuation is complete. A **SnapMate** connector or a charge gun connector is then used at the charging station.

Improved Field Service

The **CoreMax** System is compatible with commonly used service connectors and caps. The **CoreMax** valve uses the same thread, taper and sealing surface as standard refrigeration access valves. Service technicians do not need to buy special tools, but with evacuation rates as fast as

most 1/4" process tubes and connectors they will want to. Using the **SnapMate** Service connector with the **CoreMax** high-flow access valve allows field evacuation rates to be as fast as production rates, dramatically reducing service times.

Features and Benefits

- Elimination of costs and leaks associated with process tubes and Schrader valves
- Increased flow rate for greater throughput
- Dramatically improved sealing for increased first-pass yield
- Improved vacuum quality to maximize SEER rating
- Designed for CFC and non-CFC refrigerants
- Ergonomic production-ready tooling
- Compatibility with industry standard field service tools
- Faster processing and fewer evacuation stations

Applications

- Refrigerators
- Ice Machines
- Freezers
- Commercial Air Conditioners
- Residential Air Conditioners
- Mobile Air Conditioners
- Refrigeration Cases
- Water Coolers

THE COREMAX SYSTEM



SCCA07H

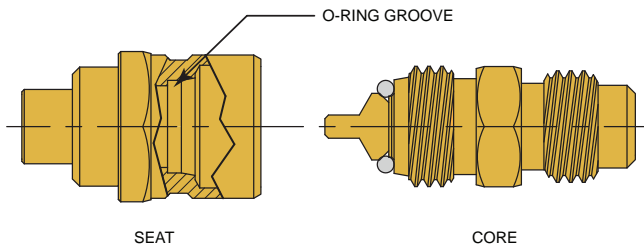

SCCA07H - CoreMax Valve Core

The **CoreMax** valve core provides over 5 times greater flow than common refrigeration access valves along with dramatically better sealing (see chart below).

Comparison of Relative Flow Rates

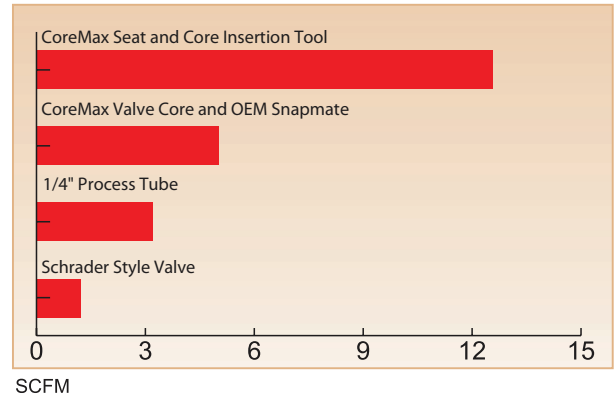

Schrader style access valves have two leak paths and poor tolerance control making them prone to leaks. They have a sleeve seal between the valve core and the seat and an additional elastomer seal on the valve.

The **CoreMax** valve core uses one elastomer to seal both the valve and the seat and also has a metal to metal seal

for redundancy on the seat. The valve core pin positioning is manufactured to exacting tolerances for consistent sealing and valve opening. For use with existing service tools and aps, it has the same (7/16-20) thread, taper, and sealing surface as commonly used on refrigeration valves. (ANSI/ARI standard 720-2002).

CoreMax Seat Styles

The **CoreMax** seat is critical to the integration system design. The seat is designed with gripping and sealing surfaces that work with the variety of **CoreMax** tools.

The seat comes in a variety of styles shown below with others available on request.



Stub Tube



Saddle Mount



Panel Mount



NPT Mount

SCH0730A01 1/4" Tube	SCH0730B03 for 0.225" hole	SCH0730C03 1/4" Tube, Threaded	SCH0730E01 1/4" Threaded
SCH0730A02 5/16" Tube	SCH0730B04 for 0.250" hole	SCH0730C02 5/16" Tube, Threaded	
SCH0730A03 3/8" Tube	SCH0730B01 for 0.313" hole	SCH0730C04 3/8" Tube, Threaded	
	SCH0730B02 for 0.375" hole		

THE COREMAX TOOLS

SCP062H - SnapMate OEM



A versatile, high flow, internally valved connector used at every station for easiest implementation

The **SnapMate** OEM is a sleeve operated connector designed to connect to the **CoreMax** valve in a production environment. It grips at the base of the **CoreMax** valve (not on the threads) to prevent damage to the threads. The grips are made of stainless steel for wear resistance and long life. The **SnapMate** is internally valved and automatically opens flow on connection and closes when disconnected.

Application

Used at every station where the **CoreMax** valve is installed. Pressures up to 700 psi.

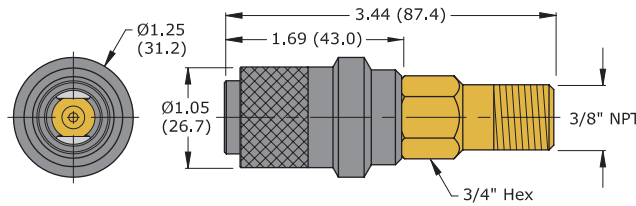

SCFT10 - Core Valve Insertion Tool



This tool is the highest flow for evacuation

The Valve Core Insertion Tool is a sleeve actuated connector that is used to first evacuate the system and then insert the **CoreMax** valve core without loss of vacuum. It connects and seals to the seat and has a 3/8" termination. Flow rates are greater than process tubes of the same size.

Application

Used for evacuation stations to achieve the maximum flow and therefore the shortest processing time. The final step with this tool is the insertion of the **CoreMax** valve prior to the unit moving to the charging station. Pressures up to 700 psi.

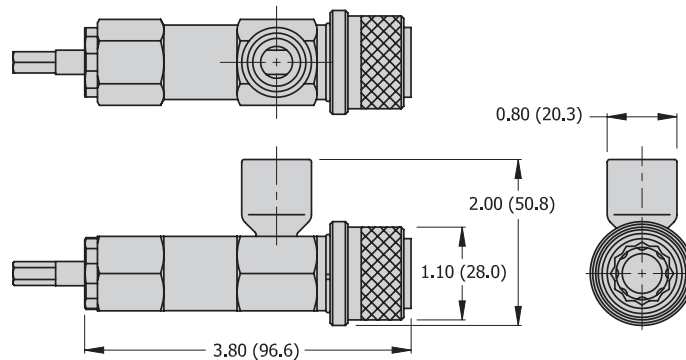

THE COREMAX TOOLS

CoreMax

SCM062W - MBE Connector



Use to fine tune your process

The MBE connector is a sleeve actuated non-valved connector that can be used with or without the **CoreMax** valve installed. The MBE grips onto the seat and has a 3/8" NPT termination. Test pressure interlocks prevent sleeve actuation under pressure.

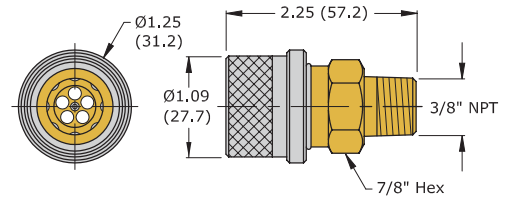

Application

With the **CoreMax** valve core installed the MBE is used primarily at the evacuation station for shorter evacuation times. When the **CoreMax** valve core is not installed the MBE is used for burst and pressure testing. Pressures up to 700 psi.

SCFT20A - Valve Removal Tool



Sleeve actuated tool allows removal and replacement of CoreMax valve core without loss of refrigerant

Application

Used to remove and replace **CoreMax** valve core in charged units. Pressures up to 600 psi.

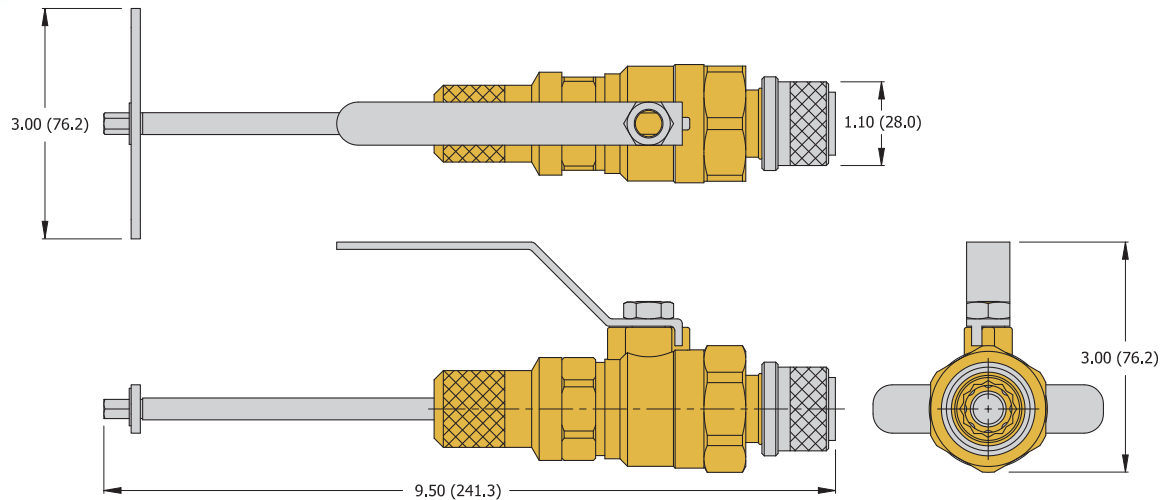

SCTA07H - SnapMate Service High Flow Service Connector



SnapMate connectors are designed to provide quick connections to **CoreMax** valve cores as well as standard access valves

The collets grip on the threads and are made of brass. The sleeve is hardened steel. The **SnapMate** connector is specifically designed for the service industry. It provides quick and easy connections to all 7/16-20, 45° flare access valves. Pressures up to 625 psi.

Application

Used by HVAC service technicians to evacuate and charge refrigerant during field service.

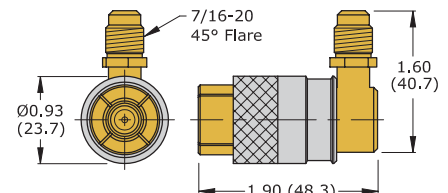

THE COREMAX TOOLS

SCL321 - CoreMax Seal Oiler



The *CoreMax* seal oiler and reservoir for proper seal lubrication

Application

Used during manufacturing to ensure proper lubrication to the *CoreMax* core prior to torquing into the *CoreMax* seat.

SCFTP02 - Torque Gun



Inserts valve core directly to seat or works with insertion tool

The torque gun is a pneumatic tool used to install the properly torque the *CoreMax* valve core into the seat. The “hold and drive” design prevents stress on the brazed joint of the seat.

Application

Used to pneumatically torque the *CoreMax* valve core into the seat.

SCFTM01 - Torque Wrench



Presets to 8 ft/lbs to install and properly torque the *CoreMax* valve core into the seat

Application

Used to manually torque the *CoreMax* valve core into the seat.

Technology Overview

FasTest's patented squeeze lever actuation and split collet design of the **FasMate FN Series** connectors provide an instant connection that can significantly decrease the time needed for pressure and vacuum testing, filling, flushing and performance testing.

The squeeze lever / split collet operation uses no thread sealant, no wrench tightening and will not damage the port threads. Its rugged design is ideal for production use and offers the following actuations methods: squeeze lever, pneumatic pilot or pneumatic thumb valve.

FasMate

Features and Benefits

FasMate "FN" Series



- Instant connection to internal threaded ports
- Seals to 5000 psi for pneumatic / hydraulic testing
- Safe, reliable, leak tight connections
- Eliminate thread or product damage, sealants and wrench tightening
- Durable stainless steel construction
- Available in multiple thread profiles
- Designed and made in the USA

Modular Design for Multiple Applications

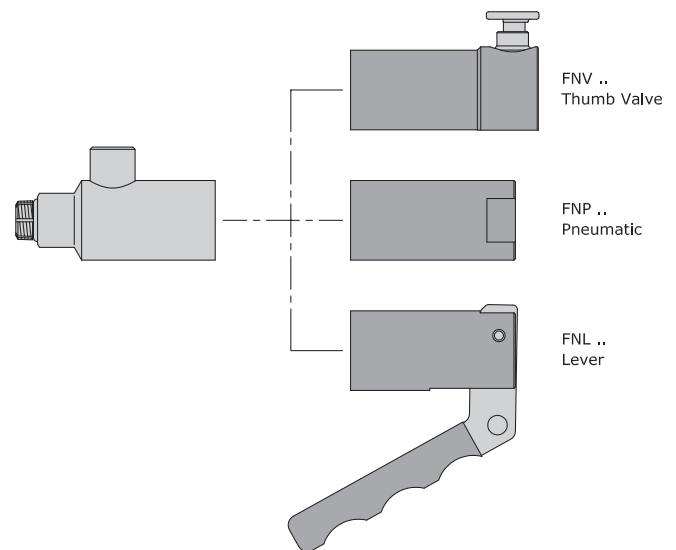

The innovative modular design of the connectors allows the technician to change the method of actuation by simply unscrewing the rear portion of the connector and replacing it with the desired form of actuation.

This feature provides flexibility to accommodate changes in the manufacturing processes, production increases and operator use preference. An additional advantage is the ease of field service for these components should they become damaged or require maintenance.

FasMate Technology

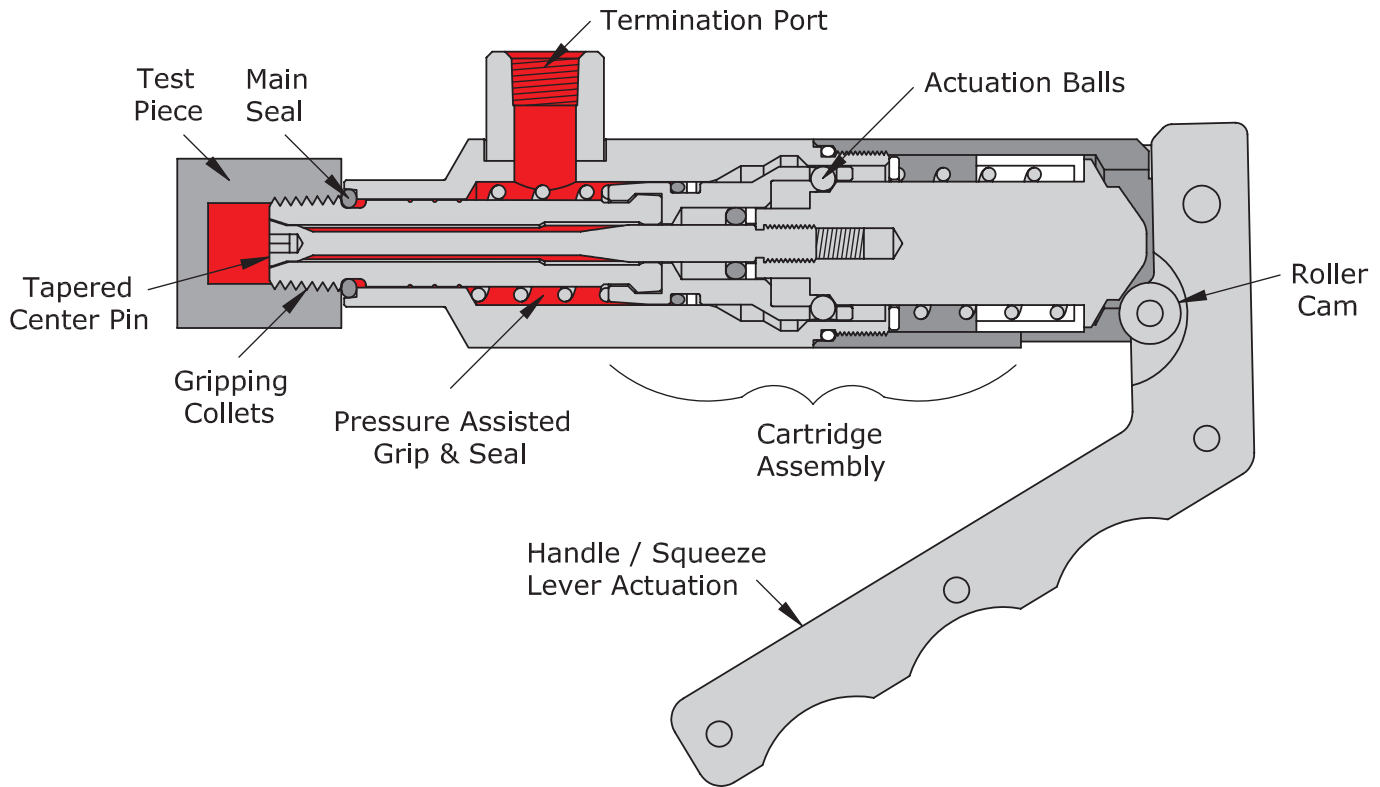

A Look Inside the Technology

The Lever actuator uses a rugged roller cam mechanism, that when squeezed, moves the Cartridge Assembly forward. As the Cartridge Assembly moves, so does the Gripping Collets and Tapered Center Pin. The Gripping Collets and Tapered Center Pin move independently due to an innovative Actuation Ball method unique to **FasTest**. This innovative actuation ball technology significantly reduces the effort needed to squeeze the lever. When the lever is released, the gripping collets expand into the port.

As media pressure increases, the sealing and connection force increases. This Pressure Assisted Grip & Seal feature ensures a leak free connection.

Grip and Seal Technology

The **FasMate** family of products use an innovative collapsing collet with tapered center pin that together locks the connector to the port. As pressure increases, it becomes difficult to impossible to accidentally or inadvertently disconnect from the port*. The expanding collets and pressure assisted sealing concept makes a leak free connection with no thread sealants, no wrench tightening and no product damage.

* For more information about the Pressure Assisted Grip & Seal feature, and how it may apply to your specific application, please contact FasTest, Inc.

Proven Design

FasTest has years of designing and manufacturing innovative connection technology. The **FN Series** has been extensively field tested for durability, safety, ease of use and operator comfort. Service parts are readily available for fast maintenance or repairs in the field. Regular maintenance of seals and parts will result in the **FN Series** providing years of reliable service.

FasMate Part Number Key

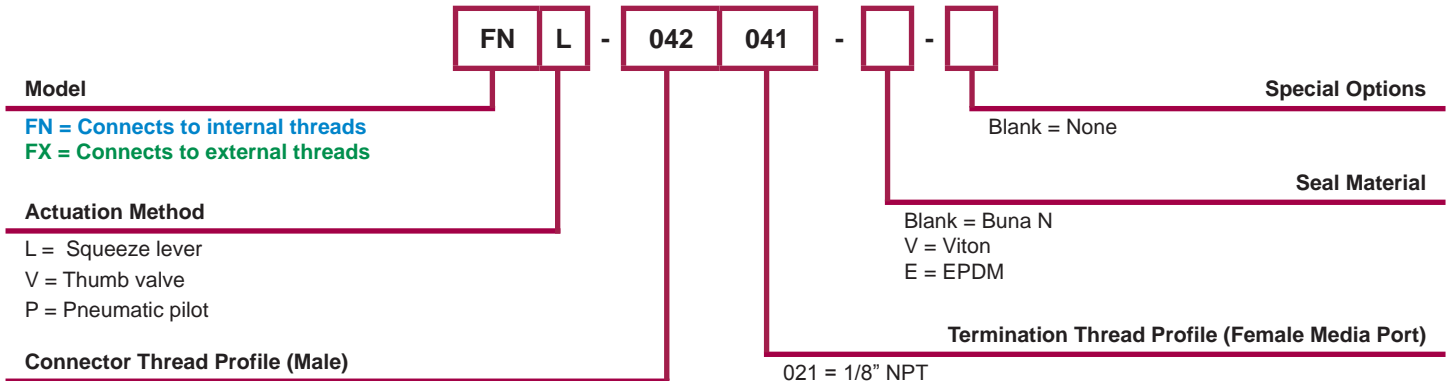

- Connector Thread Profile (Male)**
- 022 = 1/8" NPT
 - 042 = 1/4" NPT
 - 062 = 3/8" NPT
 - 082 = 1/2" NPT
 - 026 = 1/8" BSPP
 - 046 = 1/4" BSPP
 - 066 = 3/8" BSPP
 - 086 = 1/2" BSPP
 - 044 = - 4 SAE
 - 054 = - 5 SAE
 - 064 = - 6 SAE
 - 084 = - 8 SAE
 - 108 = M10 x 1.0
 - 128 = M12 x 1.5
 - 148 = M14 x 1.5
 - 168 = M18 x 1.5
 - 208 = M20 x 1.5
 - 228 = M22 x 1.5

- Termination Thread Profile (Female Media Port)**
- 021 = 1/8" NPT
 - 041 = 1/4" NPT
 - 061 = 3/8" NPT
 - 081 = 1/2" NPT

- - Connects to internal threads
- - Connects to external threads



For additional sizes and models for external threads (FX), consult factory.

Notes:

Part Number Keys are to assist in IDENTIFICATION ONLY.
Verify new part numbers with factory; some configurations are not possible.

FasMate® - Lever, Thumb Valve and Automated Connectors

CONNECTORS FOR INTERNAL (FEMALE) THREADS



- Instant connections from vacuum to 5000 psi eliminate tape, sealants and wrenches
- Compatible to NPT, SAE O-Ring, BSPP and ISO O-Ring threads
- No damage to threaded parts
- Durable stainless steel construction



For additional sizes and models for external threads (FXL), consult factory.

Lever Actuated - NPT Threads

Part Number	Connects to	Rated PSI	Term Thread	Term Diameter	Body Size	Housing Material	Seal Material	Repair Kit	Main Seals Package (5)
FNL-022021	1/8" NPT	Vacuum to 5000	1/8" NPT	0.60 (15.3)	BS1	Aluminum & Stainless Steel	Buna N	RFN022021	S1108-B70
FNL-042041	1/4" NPT		1/4" NPT	0.75 (19.1)	BS2			RFN042041	S21250327-B60
FNL-062061	3/8" NPT		3/8" NPT	0.90 (22.9)	BS3			RFN062061	S1112-B70
FNL-082081	1/2" NPT		1/2" NPT	1.10 (28.0)	BS4			RFN082081	S1208-B70

Note: Dimensions are in inches (mm).

FasMate® - Lever, Thumb Valve and Automated Connectors

BS1 AND BS2

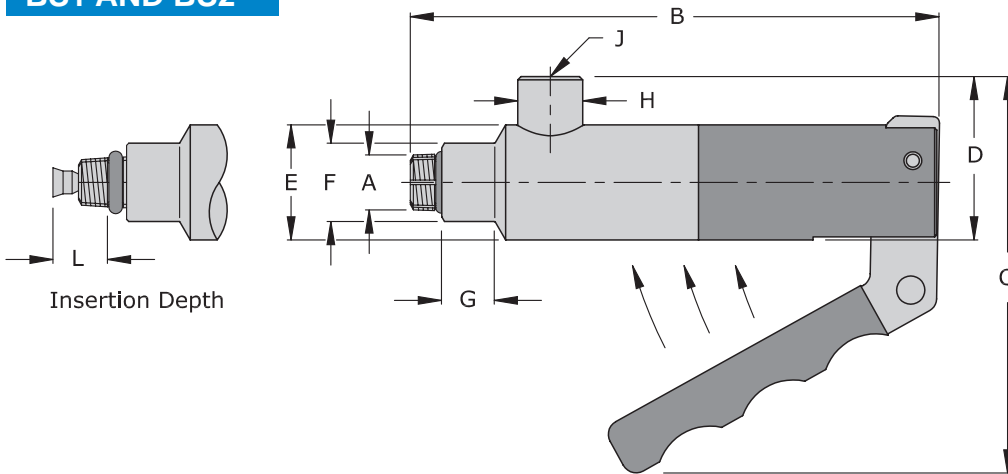

Dim	BS1	BS2
A	See Connects to	
B	4.80 (122.0)	5.00 (127.0)
C	3.70 (94.0)	4.00 (101.6)
D	1.50 (38.1)	1.70 (43.2)
E	1.06 (27.0)	1.06 (27.0)
F	0.65 (16.6)	0.72 (18.3)
G	0.50 (12.7)	0.50 (12.7)
H	0.60 (15.3)	0.75 (19.1)
J	1/8" NPT	1/4" NPT
L	0.55 (14.0)	0.67 (17.1)

FasMate

BS3

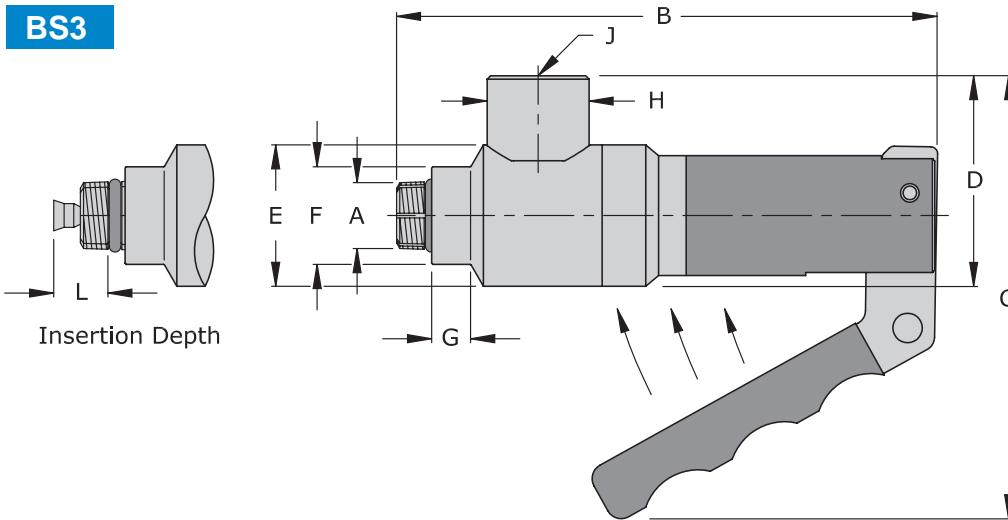

Dim	BS3
A	See Connects to
B	5.00 (127.0)
C	3.90 (99.1)
D	1.86 (47.3)
E	1.25 (31.8)
F	0.86 (21.9)
G	0.35 (8.9)
H	See Term Diameter
J	See Term Thread
L	0.67 (17.1)

BS4

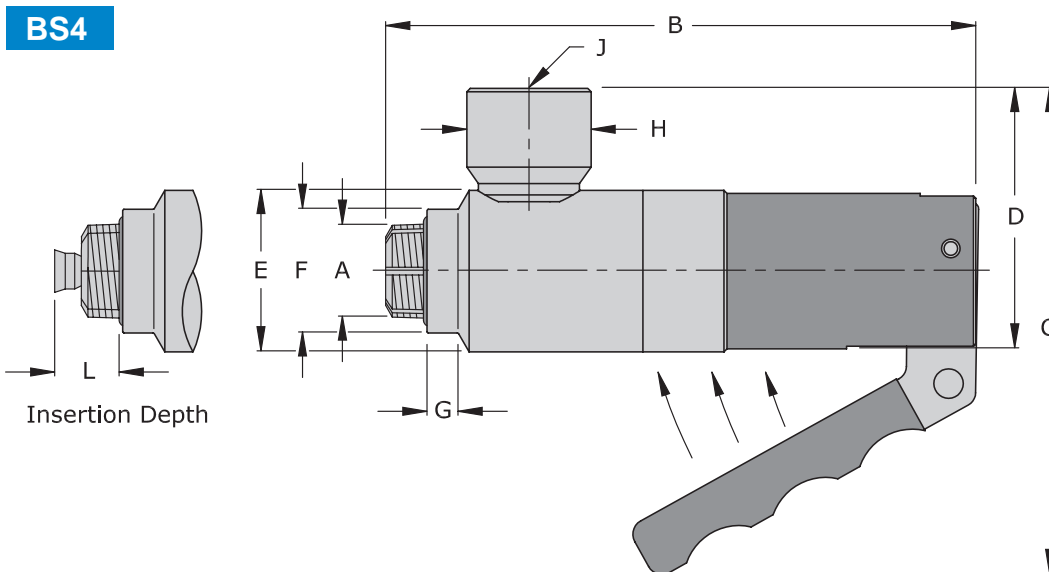

Dim	BS4
A	See Connects to
B	5.27 (133.9)
C	4.40 (111.8)
D	2.33 (59.2)
E	1.43 (36.4)
F	1.09 (27.7)
G	0.27 (6.9)
H	See Term Diameter
J	See Term Thread
L	0.76 (19.4)

FasMate® - Lever, Thumb Valve and Automated Connectors

CONNECTORS FOR INTERNAL (FEMALE) THREADS



- Instant connections from vacuum to 5000 psi eliminate tape, sealants and wrenches
- Compatible to NPT, SAE O-Ring, BSPP and ISO O-Ring threads
- No damage to threaded parts
- Durable stainless steel construction



For additional sizes and models for external threads (FXV), consult factory.

Thumb Valve Actuated - NPT Threads

Part Number	Connects to	Rated PSI	Term Thread	Term Diameter	Body Size	Housing Material	Seal Material	Repair Kit	Main Seals Package (5)
FNV-022021	1/8" NPT	Vacuum to 5000	1/8" NPT	0.60 (15.3)	BS1	Aluminum & Stainless Steel	Buna N	RFN022021	S1108-B70
FNV-042041	1/4" NPT		1/4" NPT	0.75 (19.1)	BS2			RFN042041	S21250327-B60
FNV-062061	3/8" NPT		3/8" NPT	0.90 (22.9)	BS3			RFN062061	S1112-B70
FNV-082081	1/2" NPT		1/2" NPT	1.10 (28.0)	BS4			RFN082081	S1208-B70

Note: Dimensions are in inches (mm).

FasMate® - Lever, Thumb Valve and Automated Connectors

BS1 AND BS2

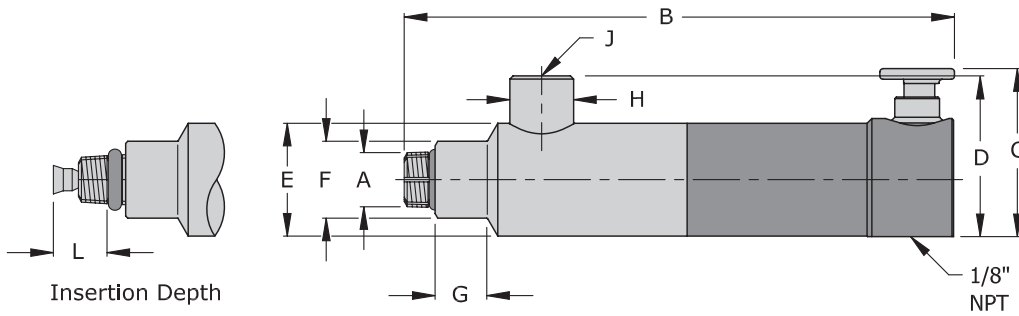

Dim	BS1	BS2
A	See Connects to	
B	5.13 (130.4)	5.21 (132.4)
C	1.58 (40.2)	1.58 (40.2)
D	1.50 (38.1)	1.70 (43.2)
E	1.06 (27.0)	1.06 (27.0)
F	0.65 (16.6)	0.72 (18.3)
G	0.50 (12.7)	0.50 (12.7)
H	0.60 (15.3)	0.75 (19.1)
J	1/8" NPT	1/4" NPT
L	0.55 (14.0)	0.67 (17.1)

FasMate

BS3

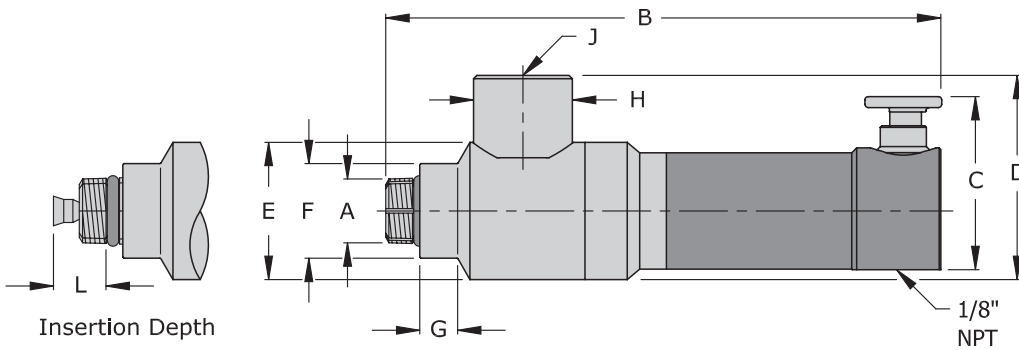

Dim	BS3
A	See Connects to
B	5.05 (128.3)
C	1.58 (40.2)
D	1.86 (47.3)
E	1.25 (31.8)
F	0.86 (21.9)
G	0.35 (8.9)
H	See Term Diameter
J	See Term Thread
L	0.67 (17.1)

BS4

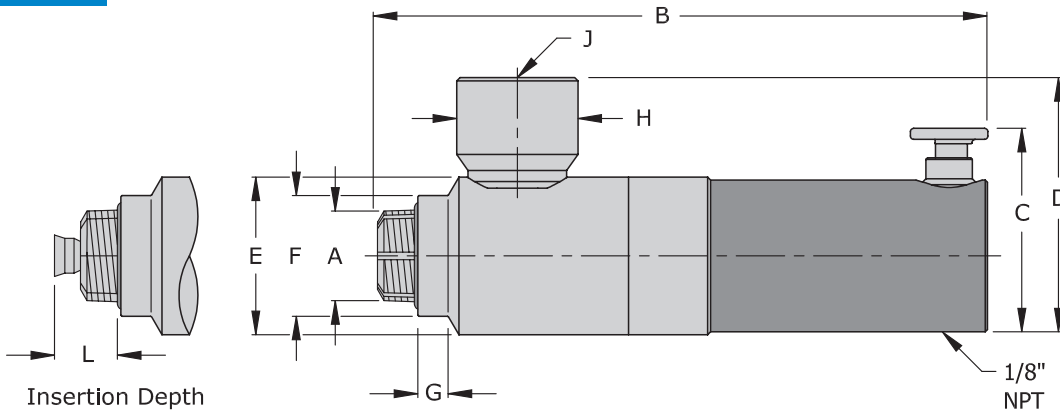

Dim	BS4
A	See Connects to
B	5.27 (133.9)
C	1.85 (47.0)
D	2.33 (59.2)
E	1.43 (36.4)
F	1.09 (27.7)
G	0.27 (6.9)
H	See Term Diameter
J	See Term Thread
L	0.76 (19.4)

FasMate® - Lever, Thumb Valve and Automated Connectors

CONNECTORS FOR INTERNAL (FEMALE) THREADS



- Instant connections from vacuum to 5000 psi eliminate tape, sealants and wrenches
- Compatible to NPT, SAE O-Ring, BSPP and ISO O-Ring threads
- No damage to threaded parts
- Durable stainless steel construction



For additional sizes and models for external threads (FXP), consult factory.

Pneumatic Actuated - NPT Threads

Part Number	Connects to	Rated PSI	Term Thread	Term Diameter	Body Size	Housing Material	Seal Material	Repair Kit	Main Seals Package (5)
FNP-022021	1/8" NPT	Vacuum to 5000	1/8" NPT	0.60 (15.3)	BS1	Aluminum & Stainless Steel	Buna N	RFN022021	S1108-B70
FNP-042041	1/4" NPT		1/4" NPT	0.75 (19.1)	BS2			RFN042041	S21250327-B60
FNP-062061	3/8" NPT		3/8" NPT	0.90 (22.9)	BS3			RFN062061	S1112-B70
FNP-082081	1/2" NPT		1/2" NPT	1.10 (28.0)	BS4			RFN082081	S1208-B70

Note: Dimensions are in inches (mm).

FasMate® - Lever, Thumb Valve and Automated Connectors

BS1 AND BS2

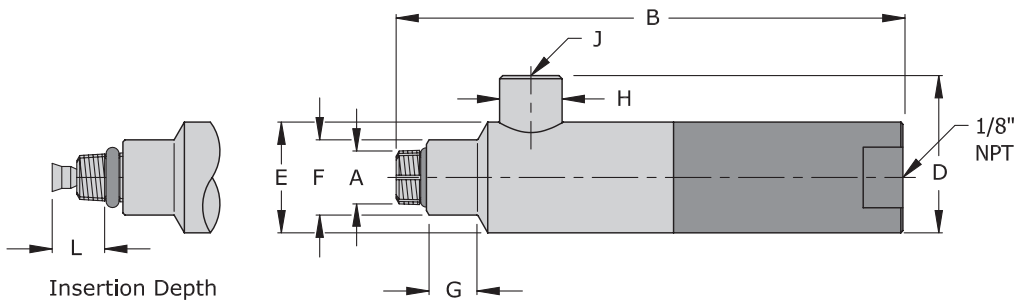

Dim	BS1	BS2
A	See Connects to	
B	4.90 (124.5)	5.00 (127.0)
C	N/A	N/A
D	1.50 (38.1)	1.70 (43.2)
E	1.06 (27.0)	1.06 (27.0)
F	0.65 (16.6)	0.72 (18.3)
G	0.50 (12.7)	0.50 (12.7)
H	0.60 (15.3)	0.75 (19.1)
J	1/8" NPT	1/4" NPT
L	0.55 (14.0)	0.67 (17.1)

FasMate

BS3

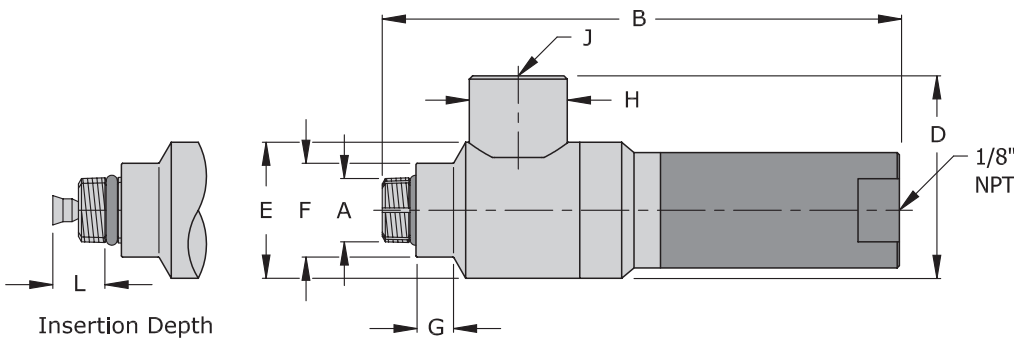

Dim	BS3
A	See Connects to
B	4.80 (122.0)
C	N/A
D	1.86 (47.3)
E	1.25 (31.8)
F	0.86 (21.9)
G	0.35 (8.9)
H	See Term Diameter
J	See Term Thread
L	0.67 (17.1)

BS4

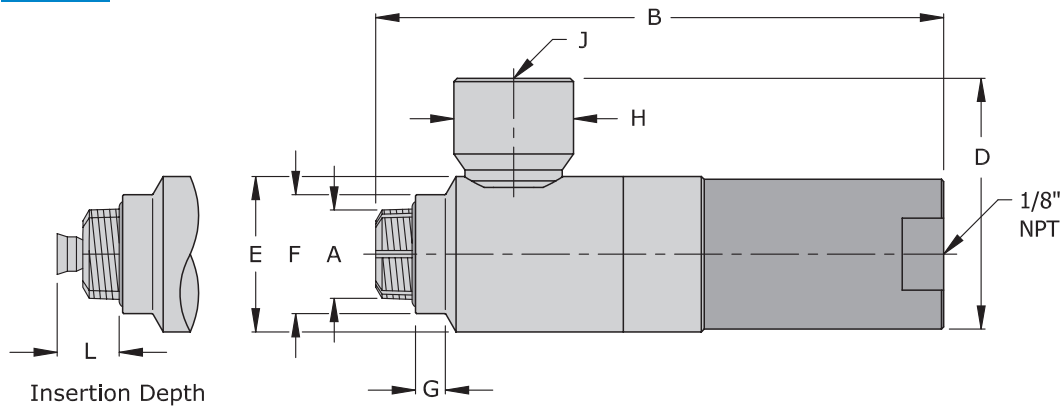

Dim	BS4
A	See Connects to
B	5.34 (135.7)
C	N/A
D	2.33 (59.2)
E	1.43 (36.4)
F	1.09 (27.7)
G	0.27 (6.9)
H	See Term Diameter
J	See Term Thread
L	0.76 (19.4)

“JNL” and “JXL” - Smooth Tube Connectors

Technology Overview

The **NuJaws Series** provides quick and effortless connections for tubing especially copper, steel and aluminum tubes that are used with refrigerant based products. The unique collet gripping and sealing design provides unmatched sealing reliability and resists removal under pressure.

Both connector series utilize a singular seal which can be quickly replaced at your work center to minimize downtime, maintenance and tool inventory. Neoprene seals are standard for refrigerant based applications, but are available with any elastomer required for your application.



JXL0 and JXL1 Series



JNL0 and JNL1 Series



JNL2 Series



“JNL” Connectors for Internal Tubes and Bores



“JXL” Connectors for External Tubes

“JNL” and “JXL” - Smooth Tube Connectors

Features and Benefits

- Pressures to 1000 psi for manual connections*
- Resists removal under pressure
- Reliable, pressure enhanced sealing
- Quick and easy seal replacement
- Vacuum to 10 millitorr (micron)
- Temperature range from -40°F to 250°F
- Body - Anodized aluminum with Delrin handle
- Gripping Collets - Stainless steel snap rings, collets and springs
- Main Seal - Neoprene (others available on request)

JNL Series



JXL Series



*JNL pressure rating based on test piece having a surface finish greater than 16rms and a hardness of no more than 95 Rb to grip and seal at the rated pressure. A surface finish of 8rms may be acceptable if the test piece has a hardness no greater than 40 Rb.

*JXL pressure rating based on metal test piece not exceeding 30 Rockwell C hardness. As a general guideline, surface must be 5 micro inches or greater. Surfaces less than 5 micro inches not recommended.

JNL - JXL

“JNL” and “JXL” - Smooth Tube Connectors

FASTEST “JNL” SERIES - CONNECTORS FOR INTERNAL TUBE GRIP & SEAL APPLICATIONS

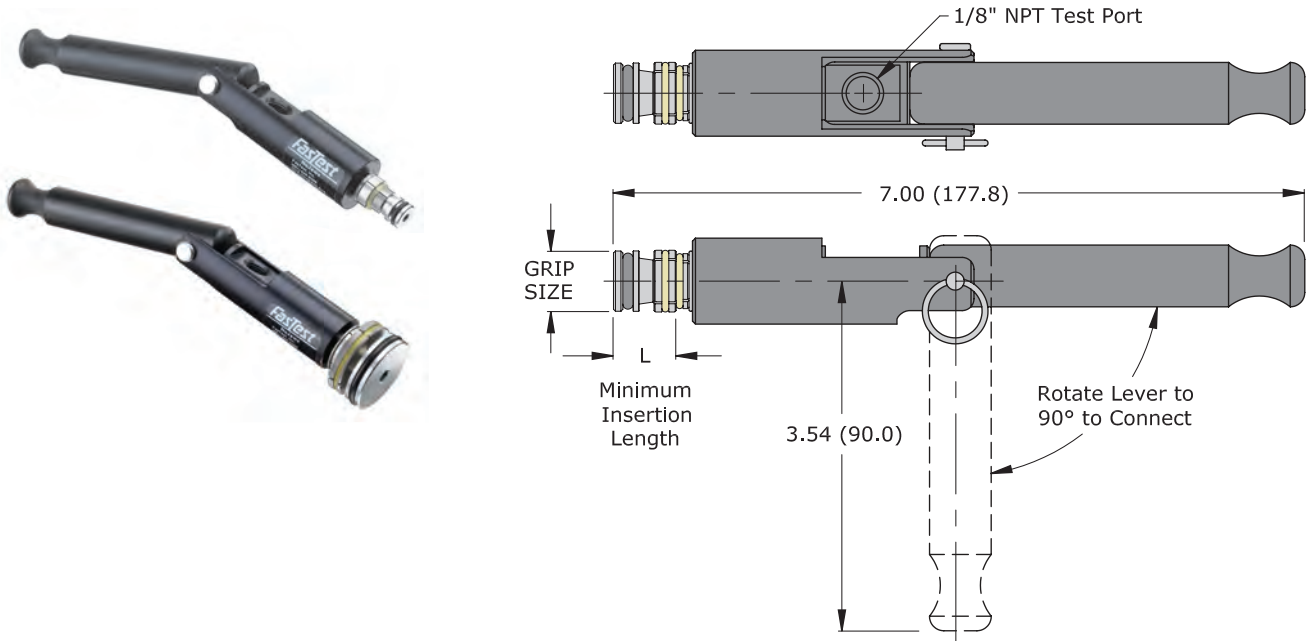

JNL0 and JNL1 - Lever Actuated Connectors for Internal Tubes / Bores

Part Number	Grip Size (+0.010”/-0.010”)	Rated PSI*	Flow Diameter	Dim L	Housing Materials	Seal Material	Main Seals Package (5)
JNL0-0375H	0.375”	Vacuum to 1000	0.11 (2.8)	0.53 (13.5)	Aluminum, Stainless Steel and Delrin	Neoprene	SN0-0375H
JNL0-0500H	0.500”		SN0-0500H				
JNL1-0590	0.590”		SN1-0590				
JNL1-0625	0.625”		SN1-0625				
JNL1-0750	0.750”		SN1-0750				
JNL1-0785	0.785”		SN1-0785				
JNL1-0875	0.875”		SN1-0875				

* Pressure rating based on the test piece having a surface finish greater than 16 rms and a hardness of no more than 95 Rb to grip and seal at the rated pressure. A surface finish of 8 rms may be acceptable if the test piece has a hardness no greater than 40 Rb.

Note: Dimensions are in inches (mm).

“JNL” and “JXL” - Smooth Tube Connectors

FASTEST “JNL” SERIES - CONNECTORS FOR INTERNAL TUBE GRIP & SEAL APPLICATIONS

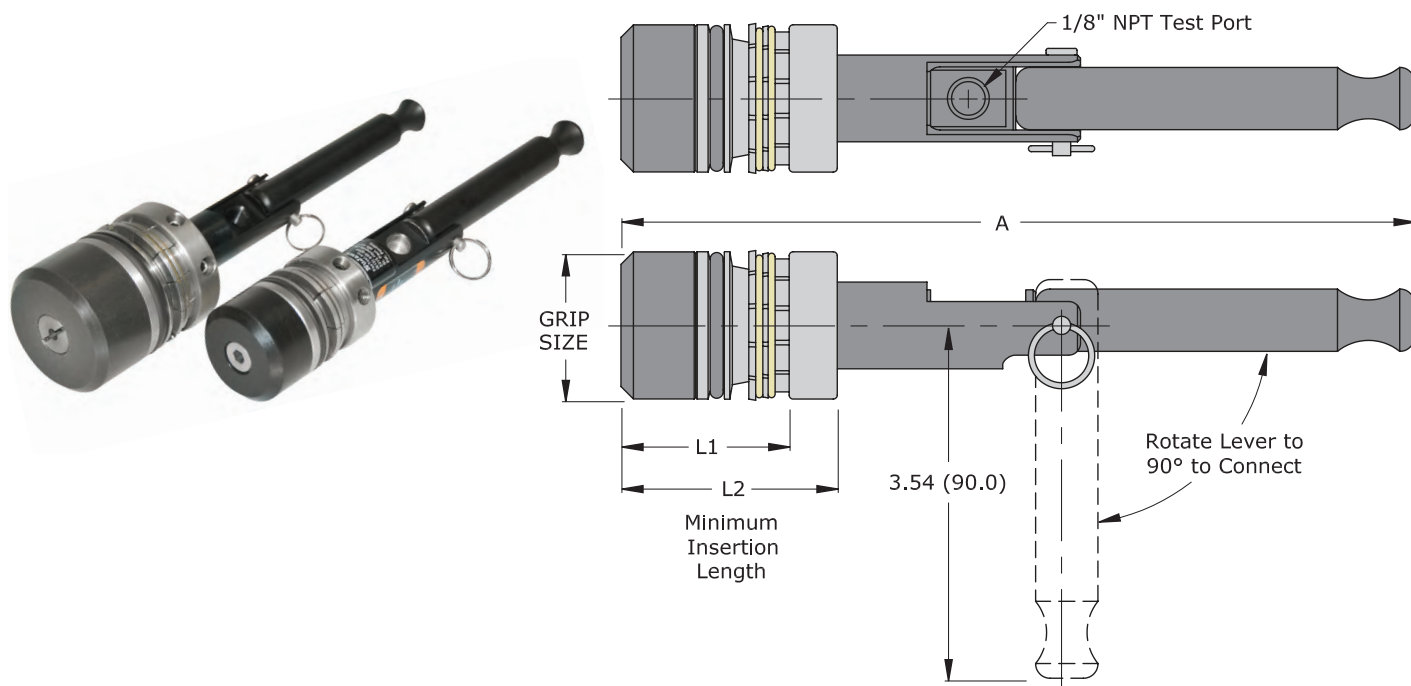

JNL - JXL

JNL2 - Lever Actuated Connectors for Internal Tubes / Bores

Part Number	Grip Size (+0.030"/-0.010")	Rated PSI*	Flow Diameter	Dim A	Dim L1	Dim L2	Housing Materials	Seal Material	Main Seals Package (5)
JNL2-1000	1.000"	Vacuum to 750	0.17 (4.3)	7.18 (182.4)	1.31 (33.3)	1.39 (35.4)	Aluminum, Stainless Steel and Delrin	Neoprene	Consult Factory
JNL2-1125	1.125"			7.30 (185.5)	1.44 (36.6)	1.51 (38.4)			
JNL2-1250	1.250"		0.17 (4.3)	7.84 (199.2)	1.56 (39.7)	2.05 (52.1)			
JNL2-1375	1.375"			7.91 (201.0)	1.69 (43.0)	2.12 (53.9)			
JNL2-1500	1.500"		0.17 (4.3)	8.09 (205.5)	1.81 (46.0)	2.30 (58.5)			
JNL2-1625	1.625"								

* Pressure rating based on the test piece having a surface finish greater than 16 rms and a hardness of no more than 95 Rb to grip and seal at the rated pressure. A surface finish of 8 rms may be acceptable if the test piece has a hardness no greater than 40 Rb.

Note: Dimensions are in inches (mm).

“JNL” and “JXL” - Smooth Tube Connectors

FASTEST “JXL” SERIES - CONNECTORS FOR EXTERNAL TUBE GRIP & SEAL APPLICATIONS

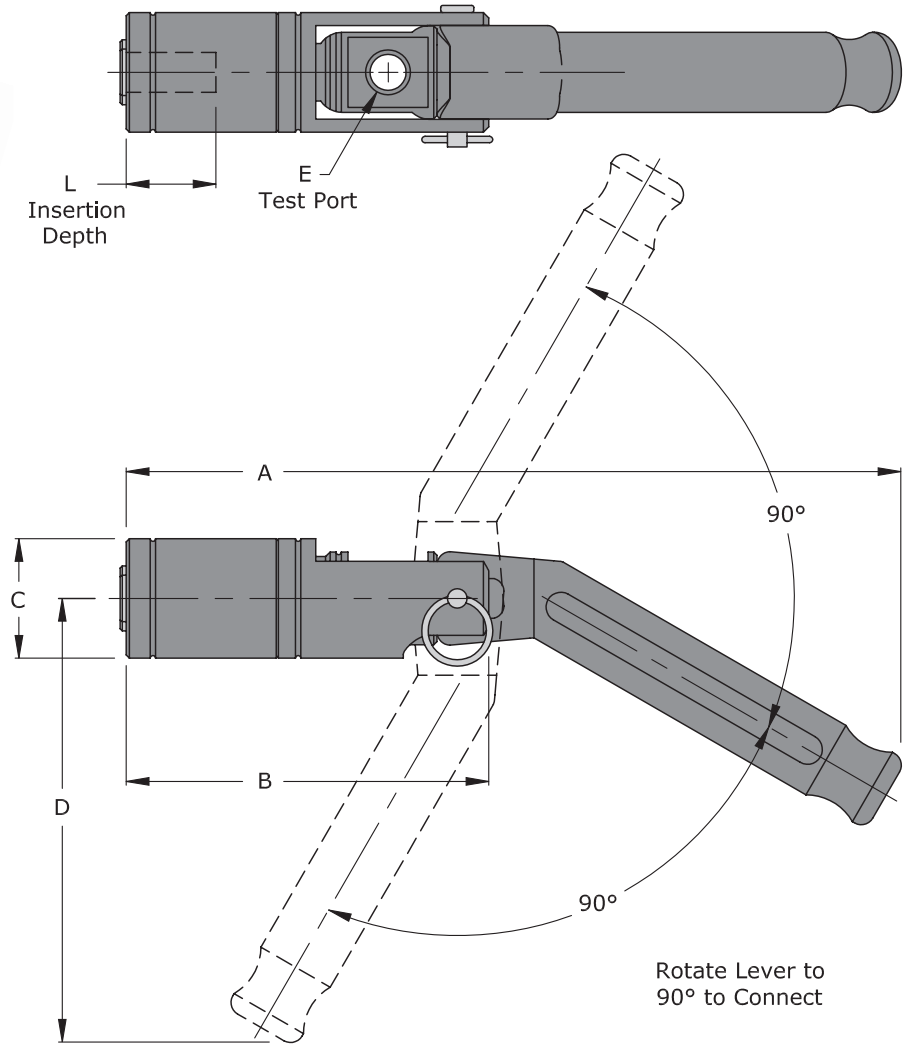

JXL0 and JXL1 - Lever Actuated Connectors for External Tubes

Part Number	Grip Size (±0.010")	Rated PSI*	Dim A	Dim B	Dim C	Dim D	Dim E	Dim L	Max. Flow Ø	Housing Materials	Seal Material	Main Seals Package (5)
JXL0-0250	0.250"	Vacuum to 1000	7.27 (184.7)	3.42 (86.9)	1.13 (28.8)	4.22 (107.2)	1/8" NPT	0.85 (21.6)	0.24 (6.0)	Aluminum, Stainless Steel and Delrin	Neoprene	SXL0-0250
JXL0-0312	0.312"											SXL0-0312
JXL0-0375	0.375"											SXL0-0375
JXL0-0500	0.500"		7.27 (184.7)	3.42 (86.9)	1.62 (41.2)	4.22 (107.2)	1/4" NPT	0.85 (21.6)	0.27 (6.8)			SXL0-0500
JXL1-0625	0.625"											SXL0-0625
JXL1-0750	0.750"											SXL0-0750
JXL1-0875	0.875"											SXL0-0875

* Pressure rating based on metal test piece not exceeding 30 Rockwell C hardness. As a general guideline, surface must be 5 micro inches or greater. Surfaces less than 5 micro inches not recommended.

Note: Dimensions are in inches (mm).

“ST” and “XT” - Smooth & Formed Tube Connectors

Technology Overview

The **ST Series** connectors make reliable, leak tight connections with straight tubes for evacuation or pressure applications such as leak testing, proof testing and processing. The ergonomic sliding sleeve operation makes an instant connection that is further enhanced by pressure and without operator adjustments.

Rugged, heat treated steel components provide excellent resistance to mechanical handling damage but are not recommended for water dunk applications. The mating seal is radially squeezed around the tube upon connection and it is easily replaced without disassembly. The unique collet locking mechanism resists removal under pressure for added safety.

The **XT Series** connectors provide quick and effortless connections for expanded tubing especially copper, steel, and aluminum tubes that are used with refrigerant based products. These connectors utilize redundant seals on the inside of the tube, which is enhanced by pressure, and a sleeve lock which resists removal under pressure and requires no operator adjustments.

The XT's are manufactured from hardened steel material with seals that can be quickly replaced, without disassembly, at your work center minimizing down-time, maintenance and tool inventory. Neoprene seals are standard for refrigerant based applications but they are available with any elastomer required for your application.

Features and Benefits

“ST Series”

- Fits straight tubing sizes 1/4”, 5/16”, 3/8”
- Seals vacuum to 1000 psi, -40°F to +250°F
- Reliable leak tight sealing to 10-7 cc/sec
- Durable, replaceable seals with no connector disassembly
- Heat treated steel body assures long life and protection against mechanical damage
- Positive gripping - No operator adjustments!

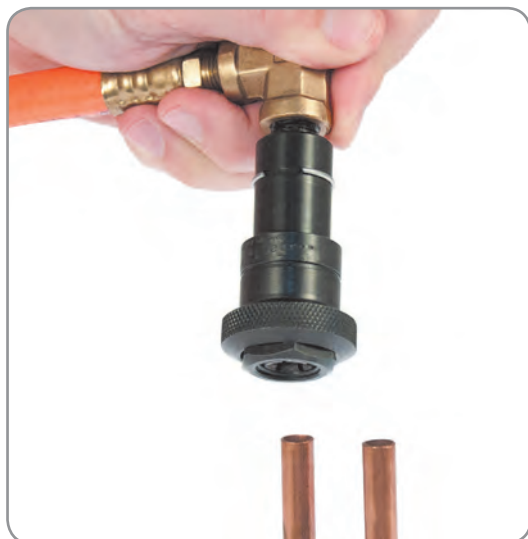

For Smooth / Swaged Tubes

“XT Series”

- Fits expanded tubing sizes 3/8”, 1/2”, 5/8”, 3/4”, 7/8”
- Seals vacuum to 625 psi, -40°F to +250°F
- Reliable leak tight sealing to 10-7 cc/sec
- Works well with tube size variation or rough cut ends
- Durable, replaceable seals with no connector disassembly
- Heat treated steel body assures long life and protection against mechanical damage
- Positive gripping - No operator adjustments!



For Formed / Expanded Tubes

ST - XT

“ST” and “XT” - Smooth & Formed Tube Connectors

FASTEST “ST SERIES” - CONNECTORS FOR EXTERNAL SMOOTH / SWAGED TUBES

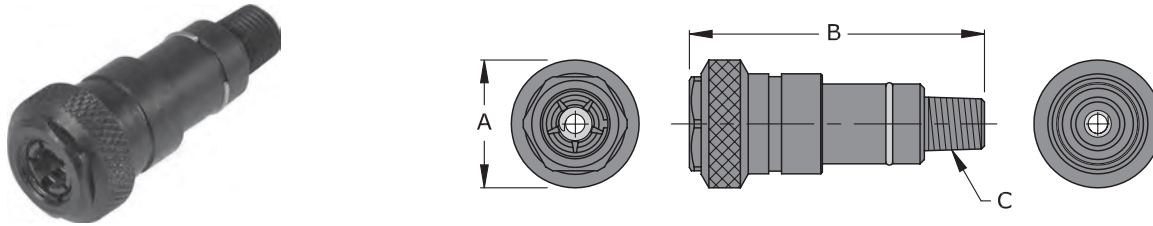

“ST Series” - Sleeve Actuated Connectors for Straight / Swaged Tubes

Part Number	Grip Size (+0.015”/-0.010”)	Rated PSI	Dim A	Dim B	Dim C	Insertion Depth	Seal Material	Replacement Collet Sets	Main Seals Package (5)
ST-04042	0.250”	Vacuum to 1000	1.14 (29.0)	2.75 (69.9)	1/4” NPT	0.62 (15.8)	Neoprene	STC04	STB04
ST-05042	0.312”		1.19 (30.3)					STC05	STB05
ST-06042	0.375”		1.50 (38.1)	3.23 (82.1)		0.75 (19.1)		STC06	STB06

Note: Not recommended for water dunk applications. Dimensions in inches (mm).

FASTEST “XT SERIES” - CONNECTORS FOR EXTERNAL FORMED / EXPANDED TUBES

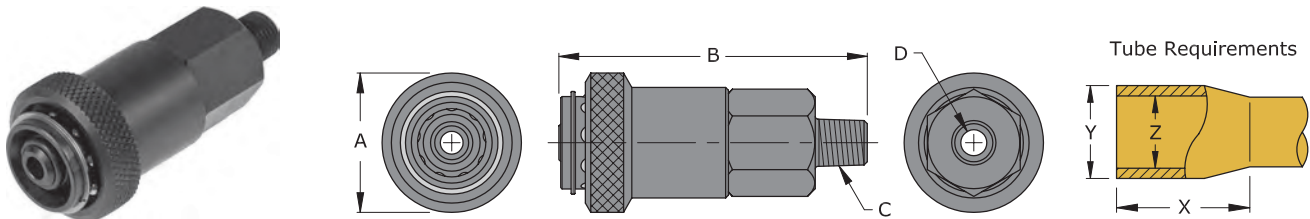

“XT Series” - Sleeve Actuated Connectors for Formed / Expanded Tubes

Part Number	Grip Size (±0.010”)	Rated PSI	Dim A	Dim B	Dim C	Flow Ø Dim D	Dim X	Dim Y	Dim Z	Seal Material	Repair Kit	Main Seals Package (5)
XT-06042	0.375”	Vacuum to 625	1.25 (31.8)	3.31 (84.1)	1/4” NPT	0.12 (3.0)	0.30”-1.00” (7.7 - 25.4)	0.500 (12.7)	0.368 (9.4)	Neoprene	XTR06	XTB06
XT-08042	0.500”		1.37 (34.8)			0.22 (5.5)		0.625 (15.9)	0.491 (12.5)		XTR08	XTB08
XT-10042	0.625”		1.50 (38.1)	0.25 (6.3)		0.730 (18.6)		0.616 (15.7)	XTR10		XTB10	
XT-12042	0.750”		1.62 (41.2)	3.33 (84.6)		0.27 (6.8)	0.37”-1.00” (9.4 - 25.4)	0.858 (21.8)	0.741 (18.9)		XTR12	XTB12
XT-14042	0.875”		1.72 (43.7)			0.28 (7.1)		0.996 (25.3)	0.867 (22.1)		XTR14	XTB14

Note: Not recommended for water dunk applications. Dimensions in inches (mm).

“MBE” & “MRE” Series Connectors for Expanded Tubes

FASTEST “MBE AND MRE SERIES” CONNECTORS FOR EXPANDED TUBES

Technology Overview



Custom, made to application samples and drawings required with application request.

The **MBE Series** (Ball Grip) and **MRE Series** (Ring Grip) connectors make reliable, leak tight connections for vacuum or pressure applications up to 625 psi. Designed for high flow applications such as run testing. Also ideal for helium leak testing, proof testing, pressure decay and other related processes. The sliding sleeve locks when pressurized to make safe secure instant connections with no operator adjustment.

To Connect: Insert the tube into the connector and push the external sleeve until it clicks into the locked position.

To Disconnect: Relieve pressure, push the connector toward the tube to release the safety lock and retract the external sleeve to withdraw the connector.

Features and Benefits



- High flow non-valved with pressure activated safety lock
- Unique design grips until pressure is dissipated, no operator adjustments for added safety
- Mating seal is easily replaced without disassembly cutting maintenance costs
- Ideal for high flow testing
- -40°F to +250°F operating temperature

“MBE and MRE Series” - Sleeve Actuated for Expanded Tubes - Sizing Guidelines

Body Size	Tube Ø	Expanded Tube Ø	Expansion Length Min.	Flow Ø	Termination (male)	Rated PSI	Housing Material	Seal Material	Main Seals Package (5)
04	1/4"	0.316 (8.03)	0.300 (7.62)	0.190 (4.82)	1/4" NPT	Vacuum to 625	Stainless Steel	Neoprene	Consult Factory
05	5/16"	0.382 (9.71)		0.248 (6.29)					
06	3/8"	0.444 (11.28)		0.311 (7.89)					
08	1/2"	0.570 (14.48)		0.436 (11.07)	3/8" NPT				
10	5/8"	0.700 (17.78)		0.555 (14.09)					
12	3/4"	0.840 (21.34)		0.666 (16.91)	3/4" NPT				
14	7/8"	0.970 (24.64)		0.785 (19.93)					
16	1"	1.120 (28.45)		0.940 (23.87)	1" NPT				
18	1-1/8"	1.230 (31.25)		1.025 (26.03)	1-1/4" NPT				
22	1-3/8"	1.490 (37.85)		1.265 (32.13)					

How to Order

The MBE and MRE Series connectors are designed for mechanical gripping on expanded tubing. Connectors are designed, engineered and manufactured to your specific application requirements.

For part number and a price quotation:

- 1) Identify the gripping and sealing areas of your test piece.
- 2) Contact FasTest with information on test pressure, media and provide detailed drawing, including tolerances of test piece.
- 3) Two sample parts will be required at the time of order for final design and testing purposes.

“RQD” - Refrigeration Quick Disconnect

FASTEST “RQD” CONNECTORS FOR HIGH PRESSURE REFRIGERATION FILLING

Technology Overview



FasTest's new Refrigeration Quick Disconnect (**RQD**) takes the pressure out of connecting to refrigerant lines for charging or evacuating cooling appliances and applications. The **RQD's** unique lever action minimizes the effort necessary for connecting to refrigerant lines under high pressure while adding the lever mechanical advantage to the valve opening. This simple two step connection process reduces worker fatigue and increases manufacturing productivity.

Features and Benefits

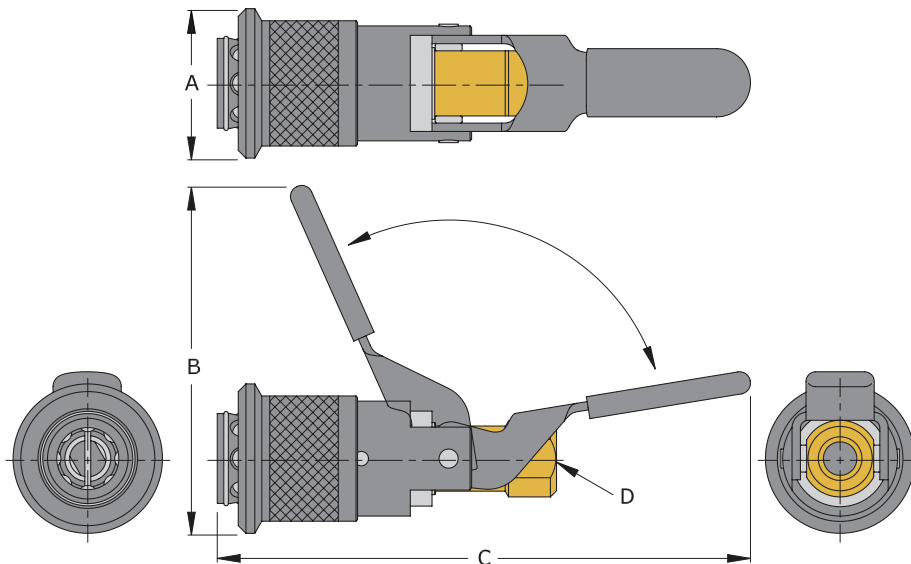

- Specifically designed for new higher pressure refrigerants
- Easy to operate connectors with unrestricted flow rate for male PCU, Hansen or equivalent style tips
- Disconnect vents trapped residual \ refrigerant with minimal media loss
- Pressure lock feature prevents accidental disconnect under pressure
- Heavy duty steel construction and easy maintenance for extended connector service life

RQD Lever Action Style for PCU Tips

Part Number	Connects to	Diameter Dim A	Height Dim B	Length Dim C	Term. Dim D	Rating PSI	Housing Material	Seal Material	Repair Kit	Main Seals Package (5)
KA04PB	1/4" PCU	1.75 (44.5)	4.39 (111.6)	7.00 (177.8)	1/4" NPT	750	Black Oxide Steel	Neoprene	KR04PB	KSM04
KA06PB	3/8" PCU	1.95 (49.6)	4.54 (115.4)		3/8" NPT	750			KR06PB	KSM06PB

Notes:
 1/4" PCU mates to PCU Model 61/62 and 71/72 or equivalent. 3/8" PCU mates to PCU Model 66/67 or equivalent.
 Dimensions in inches (mm).

RQD Lever Action Style for Hanson Tips

Part Number	Connects to	Diameter Dim A	Height Dim B	Length Dim C	Term. Dim D	Rating PSI	Housing Material	Seal Material	Repair Kit	Main Seals Package (5)
KA04HB	1/4" Hanson	1.75 (44.5)	4.39 (111.6)	7.00 (177.8)	1/4" NPT	750	Black Oxide Steel	Neoprene	KR04HB	KSM04
KA06HB	3/8" Hanson	1.95 (49.6)	4.54 (115.4)		3/8" NPT	750			KR06HB	KSM06HB

Notes:
 1/4" PCU mates to ISO standard 7241-1 Series B tips (Hanson 2-K series tips, Parker 60 series tips) or equivalent.
 3/8" PCU mates to ISO standard 7241-1 Series B tips (Hanson 3-K series tips, Parker 60 series tips) or equivalent.
 Dimensions in inches (mm).

“RQD” - Refrigeration Quick Disconnect

Operating Instructions

Connecting the **RQD** is a simple process that delivers a fast, safe and repeatable high pressure connection to 1/4” and 3/8” PCU and Hanson style tips with a minimal amount of physical effort.

1

Typical Service Valve

FasTest “XT” Connector

Male fitting

RQD sleeve and handle in retracted position →

Connect hose securely to NPT termination

Connector is in unlocked position and internal RQD valve is closed for flow.

2

RQD sleeve and handle in retracted position →

Male fitting inserted into RQD connector →

3

← RQD sleeve pushed forward to engage around male fitting, handle remains in retracted position →

← Exposed silver ring is visual indication that sleeve is fully connected

4

← RQD sleeve in forward position

← Handle rotated to forward position

RQD is now sealed on male fitting and internal RQD valve is open for flow. Sleeve is locked and will not disconnect under pressure.

To disconnect, simply reverse the RQD connection process. Rotating handle will close the internal RQD valve and vent the trapped media away from the handle.

TwistMate®

FasTest's complete product family of **TwistMate** connectors, plugs and caps provide fast leak tight threaded connections for testing, filling, flushing, plugging, calibrating or venting applications. Simply spin our connectors finger-tight onto thread until face seal contacts test piece.

TwistMates seal automatically when the system is pressurized. Air, gas or hydraulic pressure in the system provides a sealing force that presses the main seal against the face of the threads. This automatic internal piston action maintains the seal with minimum pressure.



Features and Benefits

- Pressure assisted grip and seal technology
- Available in NPT, BSPP, BSPT, SAE, Metric and special thread profiles
- Repair kits available for extended connector service life
- Finger-tight pneumatic or hydraulic connections from vacuum to 10,000 psi
- Stainless steel construction for corrosion resistance
- Reduce production losses, retest time, scrap and test damage repair costs

Applications

- Water dunk leak testing
- Leak, flow, flushing or washing
- Cylinders, manifolds, valves, pumps filters and assemblies
- Bubble, pressure decay and mass spectrometer testing
- Heat exchangers, brake and steering system assemblies
- Capping and plugging pipes, fittings or hose ends

The TwistMate Technology

The **TwistMate** family of products use an innovative “*twist to connect*” and pressure assisted grip and seal technology to deliver a fast, safe and repeatable high pressure or vacuum testing connection in threaded ports or tubing.

This sealing technique creates an improved seal as pressures increase and eliminates the traditional sealing methods using tape and wrenches that can damage internal or external threads.

“MIT Series” Connectors for Internal / Female Threads

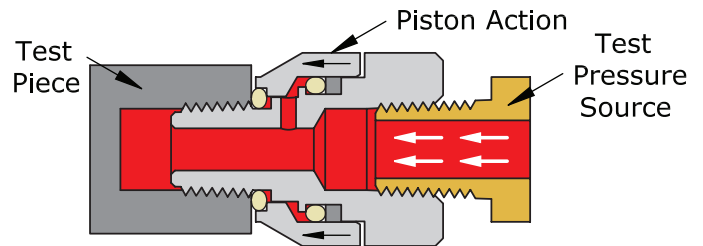
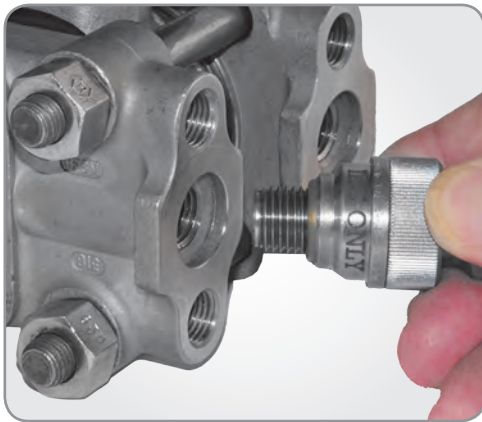

1. Spin **TwistMate** into the threaded port until the seal makes contact.
2. Introduce the media and pressure. The external sleeve automatically moves toward the test piece enhancing the seal squeeze. Vacuum applications will require finger tightening.

“MET Series” Connectors for External / Male Threads

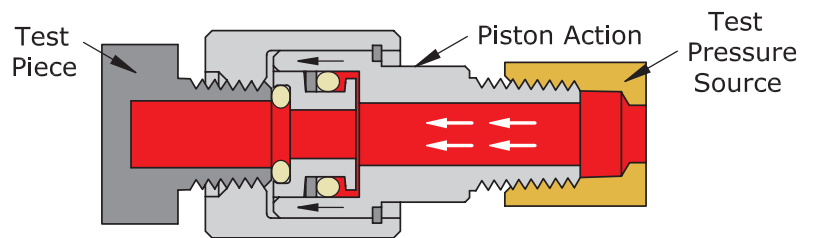

1. Spin **TwistMate** on to the threaded port until the seal makes contact.
2. Introduce the media and pressure. The internal piston automatically moves toward the test piece enhancing the seal squeeze. Vacuum applications will require finger tightening.

TwistMate

TwistMate® - Threaded Connectors

TWISTMATE PART NUMBER KEY



Model

MET - Mechanical External Thread
MIT - Mechanical Internal Thread

Optional Configurations

Blank = Standard
 C = For curved surfaces
 H = High pressure

Connector Size	NPT BSPP/T	SAE	Metric
02	1/8	--	--
03	--	3/8-24	--
04	1/4	7/16-20	--
05	--	1/2-20	--
06	3/8	9/16-18 or 5/8-18	--
08	1/2	3/4-16	--
10	--	7/8-14	M10 x 1
12	3/4	1 1/16-12	M12 x 1
14	--	1 3/16-12	M14 x 1
161	1 5/16-12	M16 x 1
18	--	--	M18 x 1.5
20	1-1/4	1 5/8-12	M20 x 1.5
22	--	--	M22 x 1.5
24	1-1/2	1 7/8-12	--
322	--	--
402-1/2	--	--
483	--	--
644	--	--

Connector Type

- 1 = Female NPT
- 2 = Male NPT
- 3 = Female SAE, O-ring Boss
- 4 = Male SAE O-ring Boss
- 5 = Female BSPP
- 5T = Female BSPT
- 6 = Male BSPP
- 6T = Male BSPT
- 7 = Female metric
- 8 = Male metric
- 9 = Female SAE 37° flare
- 0 = Male SAE 37° flare
- A = Female SAE 45° flare

Special Options

Blank = None
 PT = For thin walled pipe threads

Seal Material

Blank = Standard seal (see individual part numbers)
 B = Buna-N
 E = EPDM
 N = Neoprene
 S = Silicone
 U = Urethane
 V = Viton

Connector Configuration

Blank = Swivel style
 X = Non-Swivel connector

Termination Type

- 1 = Female NPT
- 2 = Male NPT
- 3 = Female SAE, O-ring Boss
- 4 = Male SAE O-ring Boss
- 5 = Female BSPP
- 5T = Female BSPT
- 6 = Male BSPP
- 6T = Male BSPT
- 7 = Female metric
- 8 = Male metric
- 9 = Female SAE 37° flare
- 0 = Male SAE 37° flare
- A = Female SAE 45° flare

Termination Size	NPT	SAE
02	1/8	--
04	1/4	7/16-20
06	3/8	9/16-18
08	1/2	3/4-16
10	--	7/8-14
12	3/4	1 1/16-12
16	1	--
20	1-1/4	--
24	1-1/2	--
C = Cap		
P = Plug		

Notes:

Part Number Keys are to assist in IDENTIFICATION ONLY.
 Verify new part numbers with factory; some configurations are not possible.

TwistMate® - Threaded Connectors

CONNECTORS FOR INTERNAL (FEMALE) NPT THREADS

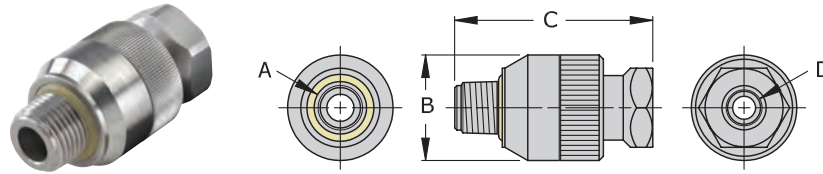

NPT - Swivel Style (per SAE J476 or ANSI B1.20)

Part Number	Dim A	Dim B	Dim C	Dim D	Rating PSI	Housing Style	Seal Material	Repair Kit	Main Seals Package (5)
MIT-022021	1/8" NPT	0.82 (20.9)	1.68 (42.7)	1/8" NPT	5000	Swivel	Urethane*	MITR-020	S1109-U70
MIT-042041	1/4" NPT	1.00 (25.4)	1.88 (47.8)	1/4" NPT				MITR-040	S1111-U70
MIT-062061	3/8" NPT	1.18 (30.0)	2.09 (53.1)	3/8" NPT	4000			MITR-060	S1113-U70
MIT-082081	1/2" NPT	1.36 (34.6)	2.57 (65.3)	1/2" NPT				MITR-080	S1209-U70
MIT-122121	3/4" NPT	1.68 (42.7)	2.73 (69.4)	3/4" NPT				MITR-12	S1109-U70
MIT-162161	1" NPT	2.00 (50.8)	3.27 (83.1)	1" NPT				MITR-16	S1010-U70

*Optional seal materials are FKM (Viton), EPDM and Buna N - Example: MIT-022021E = EPDM
Note: Dimensions in inches (mm).

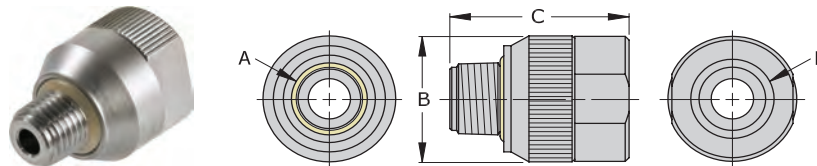

NPT - Non-Swivel Style (per SAE J476 or ANSI B1.20)

Part Number	Dim A	Dim B	Dim C	Dim D	Rating PSI	Housing Style	Seal Material	Repair Kit	Main Seals Package (5)
MIT-022021X	1/8" NPT	0.82 (20.9)	1.24 (31.5)	1/8" NPT	5000	Non Swivel	Urethane*	MITR-02	S1109-U70
MIT-042041X	1/4" NPT	1.00 (25.4)	1.41 (35.9)	1/4" NPT				MITR-04	S1111-U70
MIT-062061X	3/8" NPT	1.18 (30.0)	1.48 (37.6)	3/8" NPT	4000			MITR-06	S1113-U70
MIT-082081X	1/2" NPT	1.36 (34.6)	1.85 (47.0)	1/2" NPT				MITR-08	S1209-U70
MIT-122121X	3/4" NPT	1.68 (42.7)	1.94 (49.3)	3/4" NPT				MITR-12	S1213-U70
MIT-162161X	1" NPT	2.00 (50.8)	2.07 (52.6)	1" NPT				MITR-16	S1216-U70
MIT-202201X	1-1/4" NPT	2.38 (60.5)	2.13 (54.2)	1-1/4" NPT	3000			MITR-20	S1222-U70
MIT-242241X	1-1/2" NPT	2.74 (69.6)	2.40 (61.0)	1-1/2" NPT				MITR-24	S1327-U70
MIT-322161X	2" NPT	3.47 (88.2)	2.68 (68.1)	1" NPT	2500			MITR-32	S1331-U70
MIT-402161X	2-1/2" NPT	3.97 (100.9)	3.42 (86.9)	1" NPT	1500			MITR-40	S1335-U70
MIT-482161X	3" NPT	4.73 (120.2)	3.68 (93.5)	1" NPT		MITR-48	S1340-U70		
MIT-642161X	4" NPT	5.73 (145.6)	3.68 (93.5)	1" NPT		1000	MITR-64	S1348-U70	

*Optional seal materials are FKM (Viton), EPDM and Buna N - Example: MIT-022021XV = FKM (Viton)
Note: Dimensions in inches (mm).

TwistMate

TwistMate® - Threaded Connectors

CONNECTORS FOR EXTERNAL (MALE) NPT THREADS

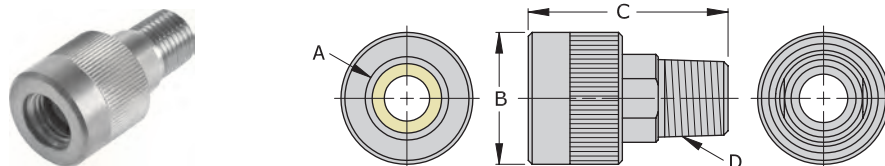

NPT Threads (per SAE J476 or ANSI B1.20)

Part Number	Dim A	Dim B	Dim C	Dim D	Rating PSI	Housing Style	Seal Material	Repair Kit	Main Seals Package (5)
MET-021022	1/8" NPT	0.82 (20.9)	1.51 (38.4)	1/8" NPT	5000	Swivel	Urethane*	METR-02	S1105-U70
MET-041042	1/4" NPT	0.94 (23.9)	1.74 (44.2)	1/4" NPT				METR-04	S1108-U70
MET-061062	3/8" NPT	1.18 (30.0)	1.78 (45.3)	3/8" NPT	4000			METR-06	S1110-U70
MET-081082	1/2" NPT	1.60 (40.7)	2.05 (52.1)	1/2" NPT				METR-08	S1112-U70
MET-121122	3/4" NPT	1.68 (42.7)	2.34 (59.5)	3/4" NPT				METR-12	S1115-U70
MET-161162	1" NPT	2.00 (69.6)	2.74 (60.2)	1" NPT	2500			METR-16	S1212-U70
MET-201202	1-1/4" NPT	2.37 (60.2)	3.27 (83.1)	1-1/4" NPT				METR-20	S1217-U70

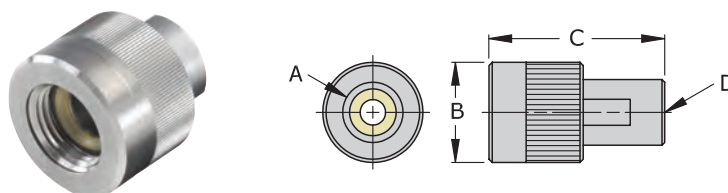

NPT Threads (per SAE J476 or ANSI B1.20)

Part Number	Dim A	Dim B	Dim C	Dim D	Rating PSI	Housing Style	Seal Material	Repair Kit	Main Seals Package (5)
MET-241161	1-1/2" NPT	2.37 (60.2)	3.27 (83.1)	1" NPT	1000	Swivel	Urethane*	METR-24	METB24
MET-321161	2" NPT	3.00 (76.2)	2.53 (64.3)	1" NPT	750			METR-32	METB32
MET-401161	2-1/2" NPT	3.40 (86.4)	2.54 (64.6)	1" NPT	500			METR-40	METB40
MET-481161	3" NPT	4.25 (108.0)	2.61 (66.3)	1" NPT				METR-48	METB48

*Optional seal materials are FKM (Viton), EPDM and Buna N - Example: MET-041042E = EPDM

Note: Dimensions in inches (mm).



- Connects to Internal Threads



- Connects to External Threads

TwistMate® - Threaded Connectors

CAPS FOR EXTERNAL (MALE) NPT, BSPP AND BSPT THREADS

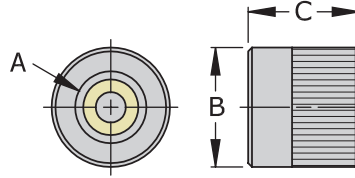

Cap Style for NPT Threads (per SAE J476 or ANSI B1.20)

Part Number	Dim A	Dim B	Dim C	Rating PSI	Housing Style	Seal Material	Repair Kit	Main Seals Package (5)
MET-021C	1/8" NPT	0.80 (20.4)	0.83 (21.1)	5000	Cap	Urethane*	METR-02	S1105-U70
MET-041C	1/4" NPT	0.93 (23.7)	0.88 (22.4)				METR-04	S1108-U70
MET-061C	3/8" NPT	1.20 (30.5)	0.90 (22.9)	4000			METR-06	S1110-U70
MET-081C	1/2" NPT	1.36 (34.6)	0.97 (24.7)				METR-08	S1112-U70

*Optional seal materials are FKM (Viton), EPDM and Buna N - Example: MET-041C**V** = FKM (Viton)

Note: Dimensions in inches (mm).

TwistMate Internal Repair Kits

Swivel style repair kits contains 2 internal Buna N O-rings, 2 backup rings and 1 snap ring.

Non-Swivel style repair kits contain 1 internal Buna N O-ring and 1 backup ring.

Repair kits do not include main seal replacement.

For additional kits consult factory.

*Date: _____

Application Evaluation Sheet

Evaluation and design will be based on information provided.
Please provide as much detail as possible.

*Company: _____ *Phone: _____

*Contact: _____ *Fax: _____

*Address: _____ *E-mail: _____

*City: _____ *State: _____ *Zip Code: _____

Product Manufactured: _____

1. Testing Specifications

Test Pressure _____ Flow Required _____

Test Temperatures _____ Acceptable Leak Rate _____

Test Medium _____ Available Pilot Pressure _____

Number of Connectors Required _____

Type of Test: Bubble Leak Water Dunk Pressure Decay Proof Test Tracer Gas
 Mass Spectrometer - Helium Concentration Other _____

2. Type of Application

Automated Manual Pneumatically Operated - Fixtured (Seal Only) Twist and Seal
 Pneumatically Operated - Grip and Seal Pneumatically Operated Lever Action / Sleeve Locking
 Other _____

3. Part Specifications

***Required Field**

2 prints detailing all dimensions, tolerances, features.
 2 actual production parts that are quality assurance approved.

Identify Surface to be Sealed:

Machined Cast Threaded Other _____

Diameter to Seal _____ Internal External

Identify Gripping Surface:

(Grip and Seal Connectors Only)

Smooth Tube Beaded Tube Flared Tube Threaded Tube
 Other _____

Diameter to Grip _____ Internal External

Hardness _____ *Date: _____

Connector Refurbishment Program

ReConnect



Extend the service life and warranty of your investment - Our connector refurbishment and competitor replacement program delivers the latest product improvements and ensures proper connector operation and performance in your application. Connectors routinely maintained can be refurbished or replaced economically relative to the cost of a new connector replacement.

Visit www.fastestinc.com or contact **FasTest** for details.

Warranty

Limited Express Warranty

FasTest Inc. warrants its products against defects in workmanship and materials for 12 months from the date of sale by FasTest Inc. or its authorized distributors. This warranty is void if the product is misused, tampered with or used in a manner that is contrary to FasTest Inc.'s written recommendations and/or instructions.

FasTest Inc. does not warrant the suitability of the product for any particular application. Determining product application suitability is solely the customer's responsibility. FasTest Inc. is not liable for consequential or other damages including, but not limited to, loss, damage, personal injury, or any other expense directly or indirectly arising from the use of or inability to use its products either separately or in combination with other products.

ALL OTHER WARRANTIES EXPRESS OR IMPLIED, WHETHER ORAL, WRITTEN OR IN ANY OTHER FORM, INCLUDING BUT NOT LIMITED TO WARRANTIES OF MERCHANTABILITY OR FITNESS FOR A PARTICULAR PURPOSE ARE EXPRESSLY EXCLUDED.

The sole and exclusive remedy under this warranty is limited to replacement of the product or an account credit in the amount of the original selling price, at the option of FasTest Inc. All allegedly defective products must be returned prepaid transportation to FasTest Inc., together with information describing the product's performance, unless disposition in the field is authorized in writing by FasTest Inc.

Notifications and Copyright

Notifications and Copyright

Specifications in this brochure are subject to change without notice. FasTest also reserves the right to make modifications and makes no guarantee of the accuracy of the information contained herein.

© 2012 FasTest Inc. All rights reserved. No part of this publication may be reproduced without written permission.



Calibration Connectors

The **FasCal** complete line of plug and play connectors for lab and field instrument calibration without the use of tapes, sealants and wrenches.



Medical Connectors

Versatile product line of connectors and systems for sealing and testing a wide variety of medical products and drug delivery devices.



Leak Test Connector Selection Guide

Features a wide variety of patented connector technologies that are typically used for leak and pressure testing manufacturing applications.

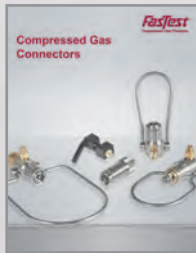

Compressed Gas Connectors

Innovative gas connectors for common CGA standards used in conventional and residual pressure valve filling applications.

FasTest[®]

1646 Terrace Drive • Roseville, MN 55113-1317

Phone: 651.645.6266 • Fax: 651.645.7390

Toll-free: 1.800.444.2373

www.fastestinc.com