

D47

S47



General Use Industrial

FLOATING BALL

DIVERTER
SIDE ENTRY - 3 PIECE

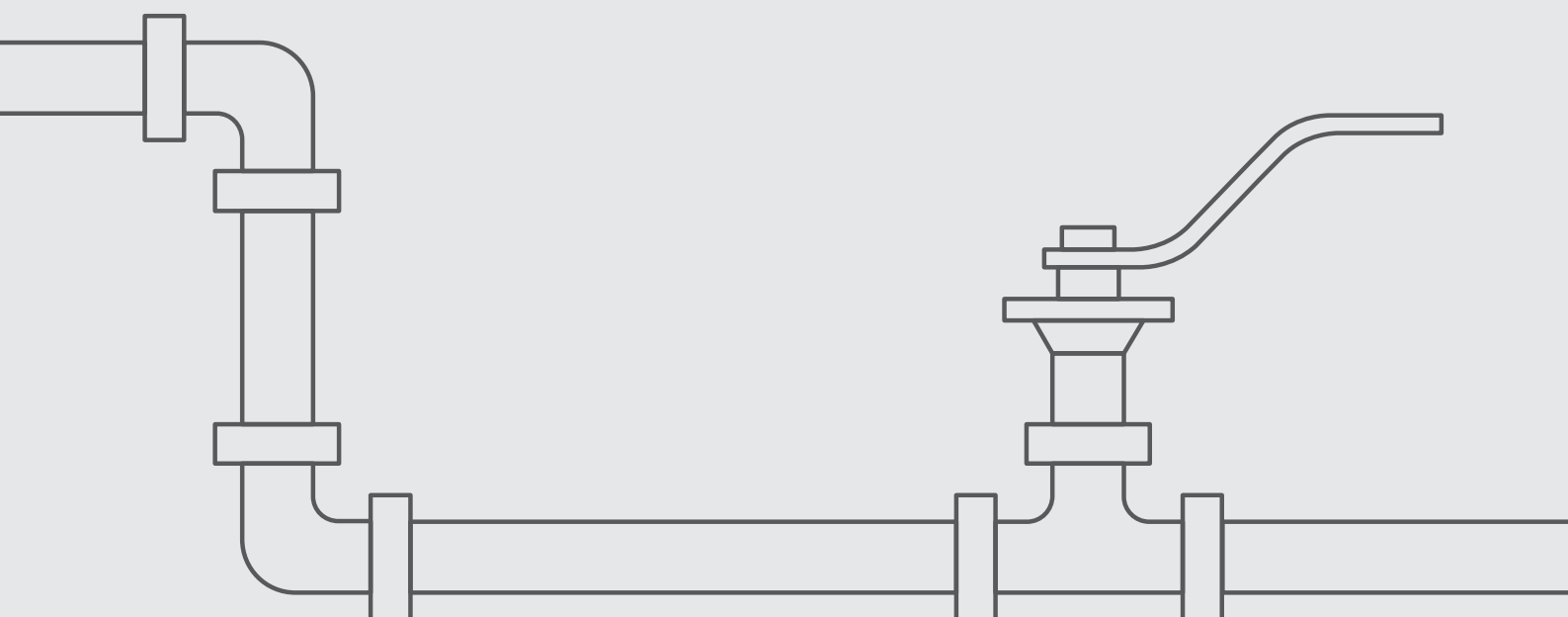

D47

S47

Diverter | Side Entry

Design features

Body

- Three piece design
- Forged or cast body
- Full compliance with ASME B16.34 (wall thickness)
- Easy in-line serviceable with swing-out body
- Large range of end connections for full or standard port valves
- Rugged top mounting platform compliant with ISO 5211 for easy mounting of actuator and other accessories

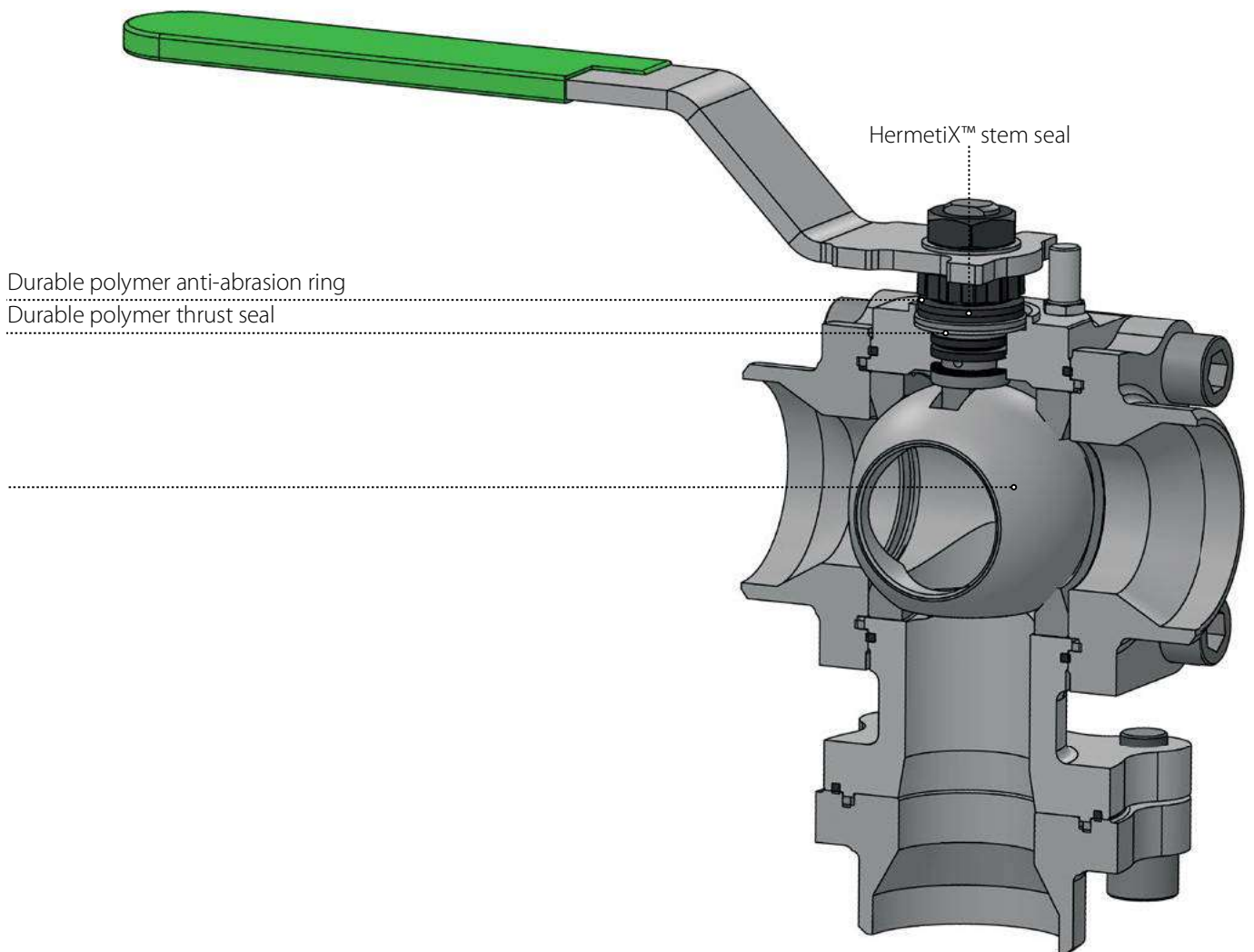

D47

S47



Side Entry - S47

Rotation: 90°

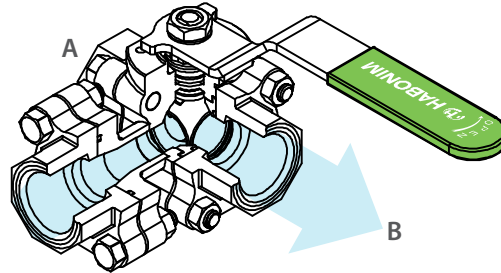
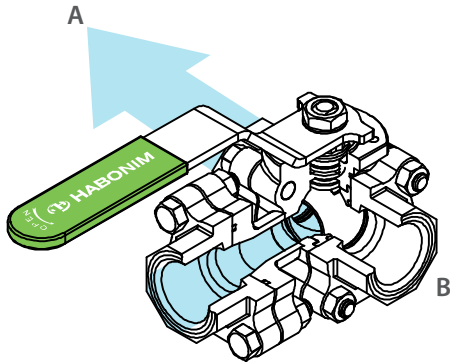

Bottom Entry - D47

Rotation: 90°

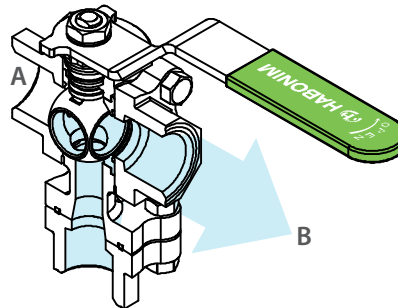
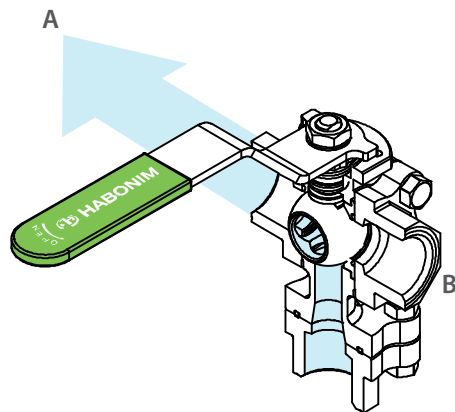

Bottom Entry - D47

Rotation: 180°

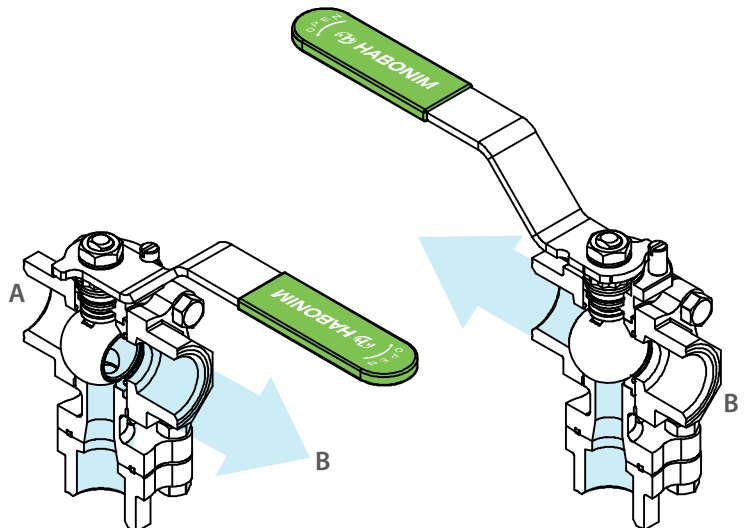
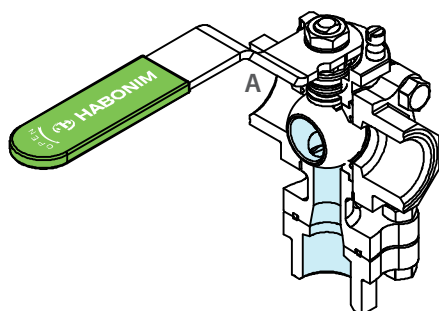

Diverter Floating Ball 3 Piece

Valve dimensions

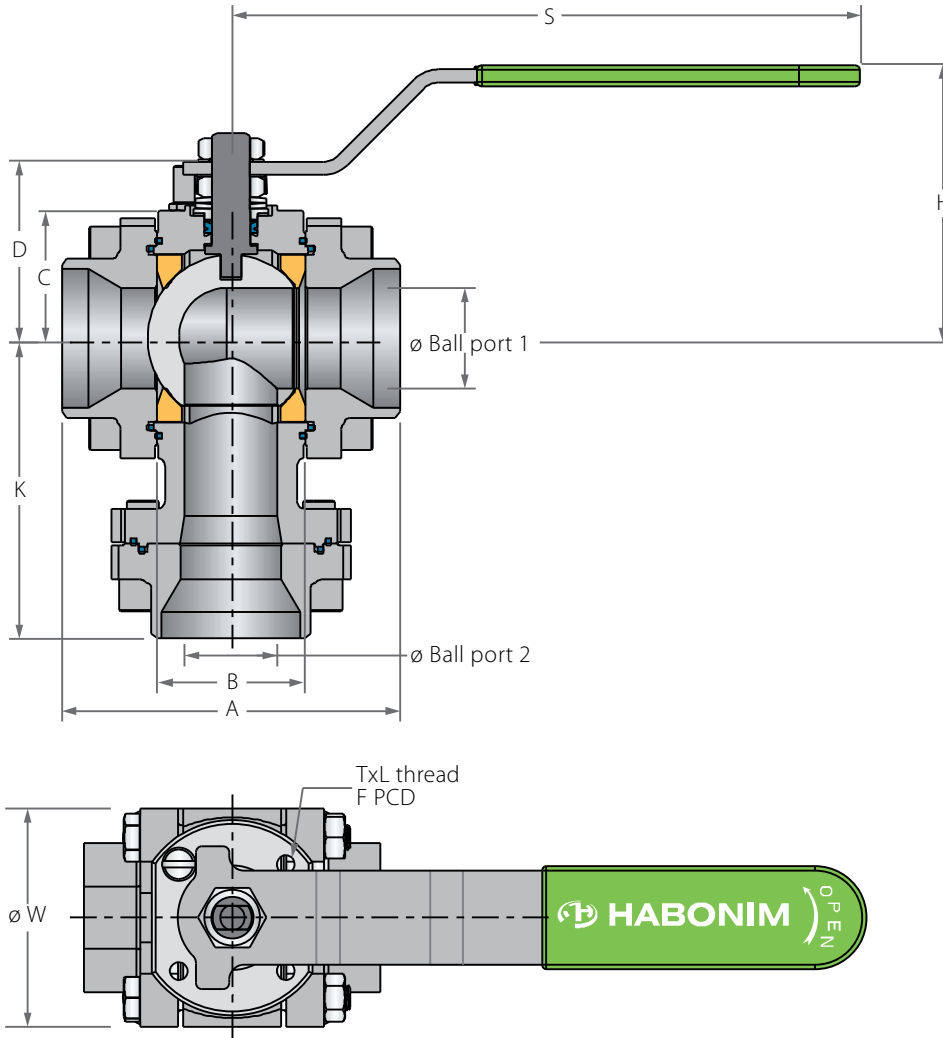

Preparation for actuation

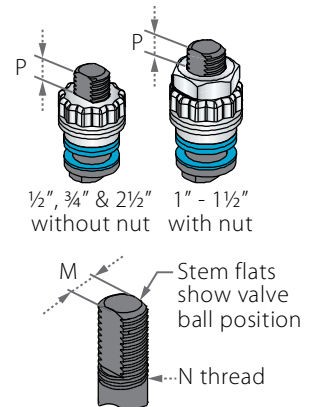

| Std. port | Full port | Unit | Ball port1 | Ball port2 | A | B | C | D | H | K | S | W | M | N | P | F | TxL | Weight kg/lb | Kv Cv |
|-----------|-----------|------|------------|------------|--------|-------|-------|-------|--------|--------|--------|--------|------|----------|-------------|-------|-------|--------------|-------|
| | DN8 | mm | 10.50 | 9.50 | 66.00 | 20.60 | 29.00 | 37.90 | 61.50 | 88.20 | 150.00 | 47.00 | 5.54 | | 6.65 (F03) | 36.00 | M5X10 | 1.00 | 2.4 |
| | 1/4" | inch | 0.41 | 0.37 | 2.60 | 0.81 | 1.14 | 1.49 | 2.42 | 3.48 | 5.91 | 1.85 | 0.22 | | 0.26 | 1.42 | M5X10 | 2.20 | 2.8 |
| DN15 | DN10 | mm | 10.50 | 9.50 | 66.00 | 20.60 | 29.00 | 37.90 | 61.50 | 88.20 | 150.00 | 47.00 | 5.54 | | 6.65 (F03) | 36.00 | M5X10 | 1.00 | 2.8 |
| 1/2" | 3/8" | inch | 0.41 | 0.37 | 2.60 | 0.81 | 1.14 | 1.49 | 2.42 | 3.48 | 5.91 | 1.85 | 0.22 | | 0.26 | 1.42 | M5X10 | 2.20 | 3.3 |
| DN20 | DN15 | mm | 14.30 | 11.90 | 70.60 | 24.50 | 31.40 | 40.30 | 63.90 | 93.70 | 150.00 | 53.70 | 5.54 | | 6.65 (F03) | 36.00 | M5X10 | 1.20 | 4 |
| 3/4" | 1/2" | inch | 0.56 | 0.47 | 2.78 | 0.97 | 1.24 | 1.59 | 2.52 | 3.68 | 5.91 | 2.11 | 0.22 | | 0.26 | 1.42 | M5X10 | 2.64 | 5 |
| DN25 | DN20 | mm | 20.60 | 15.90 | 93.70 | 31.70 | 38.10 | 55.60 | 79.40 | 119.00 | 187.00 | 63.70 | 7.54 | 7/16 UNF | 7.40 (F04) | 42.00 | M5X10 | 2.40 | 8 |
| 1" | 3/4" | inch | 0.81 | 0.63 | 3.69 | 1.25 | 1.50 | 2.19 | 3.13 | 4.68 | 7.36 | 2.51 | 0.30 | | 0.29 | 1.65 | M5X10 | 5.29 | 9 |
| DN32 | DN25 | mm | 25.40 | 20.50 | 108.00 | 41.30 | 42.70 | 60.20 | 84.10 | 130.15 | 187.00 | 71.70 | 7.54 | | 7.40 (F04) | 42.00 | M5X10 | 4.00 | 16 |
| 1 1/4" | 1" | inch | 1.00 | 0.81 | 4.25 | 1.62 | 1.68 | 2.37 | 3.31 | 5.13 | 7.36 | 2.82 | 0.30 | | 0.29 | 1.65 | M5X10 | 8.82 | 19 |
| DN40 | DN32 | mm | 31.80 | 26.60 | 115.50 | 48.40 | 43.60 | 73.00 | 97.00 | 139.05 | 237.00 | 86.70 | 8.71 | | 8.50 (F05) | 50.00 | M6X12 | 5.50 | 40 |
| 1 1/2" | 1 1/4" | inch | 1.25 | 1.05 | 4.55 | 1.91 | 1.72 | 2.87 | 3.82 | 5.47 | 9.33 | 3.41 | 0.34 | | 0.33 | 1.97 | M6X12 | 12.12 | 46 |
| DN50 | DN40 | mm | 38.10 | 35.00 | 128.00 | 56.30 | 48.30 | 77.80 | 101.80 | 149.45 | 237.00 | 96.90 | 8.71 | | 8.50 (F05) | 50.00 | M6X12 | 6.90 | 42 |
| 2" | 1 1/2" | inch | 1.50 | 1.38 | 5.04 | 2.22 | 1.90 | 3.06 | 4.01 | 5.88 | 9.33 | 3.82 | 0.34 | | 0.33 | 1.97 | M6X12 | 15.21 | 49 |
| DN65 | DN50 | mm | 50.80 | 48.00 | 158.00 | 72.60 | 70.00 | 88.10 | 115.10 | 175.40 | 237.00 | 108.00 | 8.71 | | 13.50 (F07) | 70.00 | M8X12 | 14.45 | 96 |
| 2 1/2" | 2" | inch | 2.00 | 1.89 | 6.22 | 2.86 | 2.76 | 3.47 | 4.53 | 6.90 | 9.33 | 4.25 | 0.34 | | 0.53 | 2.76 | M8X12 | 31.85 | 111 |



Diverter Floating Ball 3 Piece

Components & materials

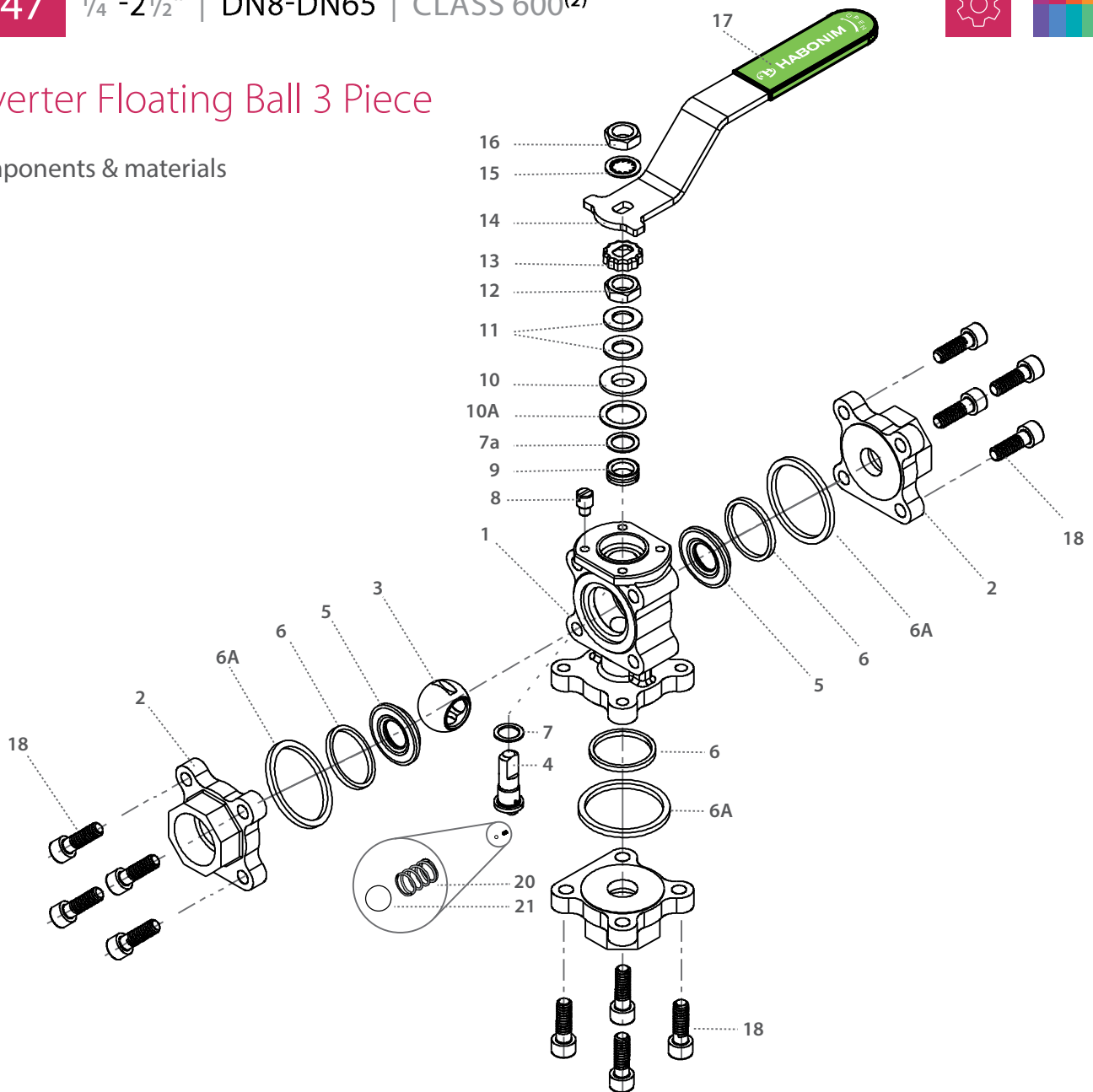

| Item | Description | Material specification | Qty. |
|------|--------------------|------------------------|------|
| 1 | Body | Acc. Ordering Code | 1 |
| 2 | Ends | Acc. Ordering Code | 3 |
| 3 | Ball | Acc. Ordering Code | 1 |
| 4 | Stem | Acc. Ordering Code | 1 |
| 5* | Seat | Acc. Ordering Code | 2 |
| 6* | Body seal | Acc. Ordering Code | 3 |
| 6A* | Outer seal | Acc. Ordering Code | 3 |
| 7* | Stem thrust seal | PEEK, CF PEEK, PCTFE | 1 |
| 7a** | Anti-abrasion ring | PEEK, CF PEEK, PCTFE | 1 |
| 8 | Stop pin | S. Steel | 1 |
| 9* | Stem seal | CF PTFE, TFM | 1 |
| 10 | Follower | S. Steel | 1 |

⁽¹⁾ 2 1/2" (DN65) size maximum pressure rating is Class 400.

| Item | Description | Material specification | Qty. |
|------|---------------------|------------------------|------|
| 10A | Slide bearing | S. Steel | 1 |
| 11 | Disc spring | S. Steel | 2 |
| 12 | Stem nut | S. Steel | 1 |
| 13 | Locking clip | S. Steel | 1 |
| 14 | Handle | S. Steel | 1 |
| 15 | Serrated washer | S. Steel | 1 |
| 16 | Handle nut | S. Steel | 1 |
| 17 | Sleeve | PVC | 1 |
| 18 | Body bolt | S. Steel | 12 |
| 20 | Anti-static spring | S. Steel | 1 |
| 21 | Anti-static plunger | S. Steel | 1 |
| 23 | Tag (not shown) | S. Steel | 1 |

* Repair kit components

Diverter Floating Ball 3 Piece

Valve dimensions

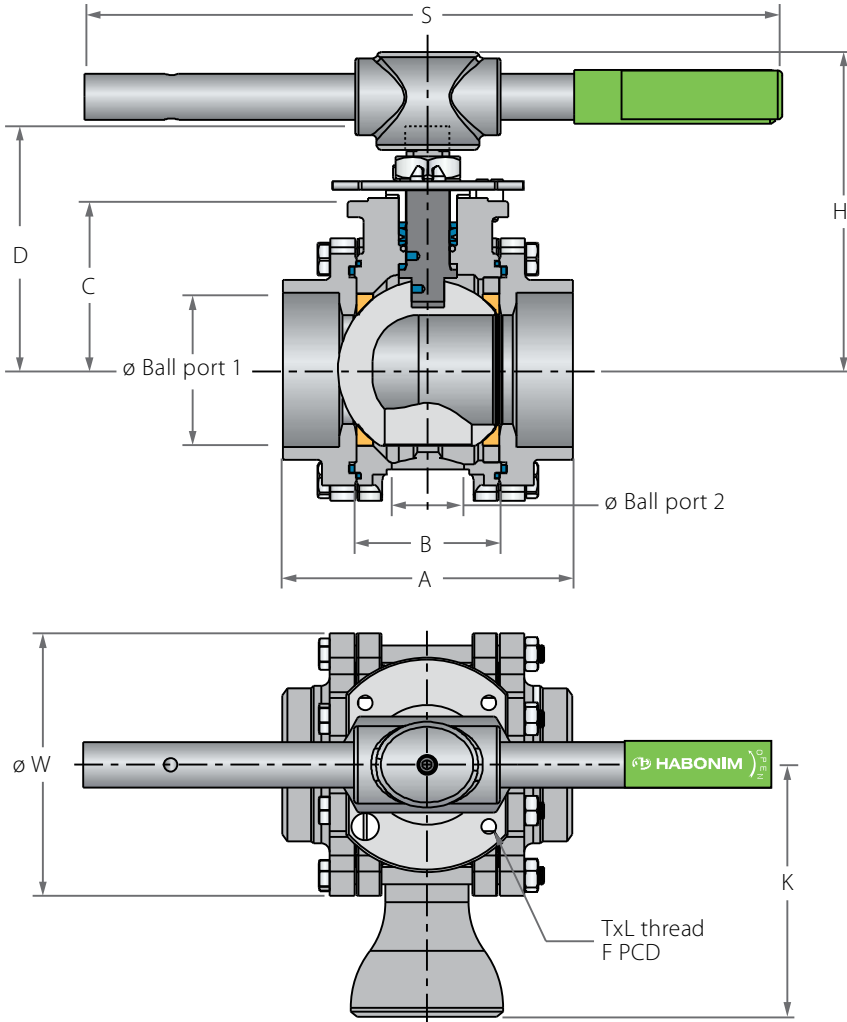

Preparation for actuation

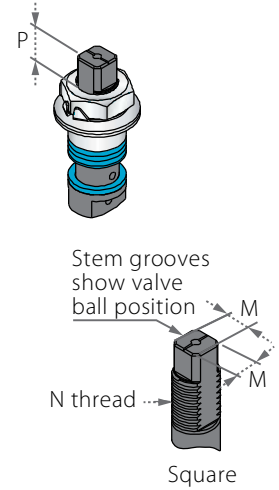

| Std. port | Full port | Unit | Ball port 1 | Ball port 2 | A | B | C | D | H | K | S | W | M | N | P | F | TxL | Weight kg/lb | Kv Cv |
|-----------|-----------|------|-------------|-------------|-------|-------|-------|-------|-------|------|-------|-------|-------|--------|-------------|--------|--------|--------------|-------|
| DN80 | DN65 | mm | 63.75 | 80.50 | 169 | 83.3 | 98.3 | 144.9 | 185 | 163 | 400 | 18.90 | 15.90 | 1"-14 | 16.70 (F10) | 102.00 | M10x20 | 18.00 | 129 |
| 3" | 2½" | inch | 2.51 | 3.17 | 6.65 | 3.28 | 3.87 | 5.70 | 7.28 | 6.42 | 15.75 | 0.74 | 0.63 | UNS-2A | 0.66 | 4.02 | M10x20 | 39.67 | 150 |
| DN100 | DN80 | mm | 80.00 | 63.25 | 214 | 108.8 | 114.1 | 160.7 | 200 | 183 | 600 | 18.90 | 15.90 | 1"-14 | 16.70 (F10) | 102.00 | M10x20 | 28.20 | 182 |
| 4" | 3" | inch | 3.15 | 2.49 | 8.43 | 4.28 | 4.49 | 6.33 | 7.87 | 7.20 | 23.62 | 0.74 | 0.63 | UNS-2A | 0.66 | 4.02 | M10x20 | 62.15 | 211 |
| | DN100 | mm | 92.00 | 67.00 | 239 | 123 | 124 | 170.5 | 211 | 200 | 600 | 18.90 | 15.90 | 1"-14 | 16.70 (F10) | 102.00 | M10x20 | 36.00 | 334 |
| | 4" | inch | 3.62 | 2.64 | 9.41 | 4.84 | 4.88 | 6.71 | 8.31 | 7.87 | 23.62 | 0.74 | 0.63 | UNS-2A | 0.66 | 4.02 | M10x20 | 79.34 | 388 |
| DN150 | | mm | 111.35 | 77.90 | 346 | 146 | 157 | 226 | 286 | 212 | 916 | 28.45 | 23.75 | 1½"-12 | 26.20 (F12) | 125.00 | M12x20 | 41.00 | 437 |
| 6" | | inch | 4.38 | 3.07 | 13.62 | 5.75 | 6.18 | 8.90 | 11.26 | 8.35 | 36.06 | 1.12 | 0.94 | UNF-2A | 1.03 | 4.92 | M12x20 | 90.36 | 507 |



Diverter Floating Ball 3 Piece

Components & materials

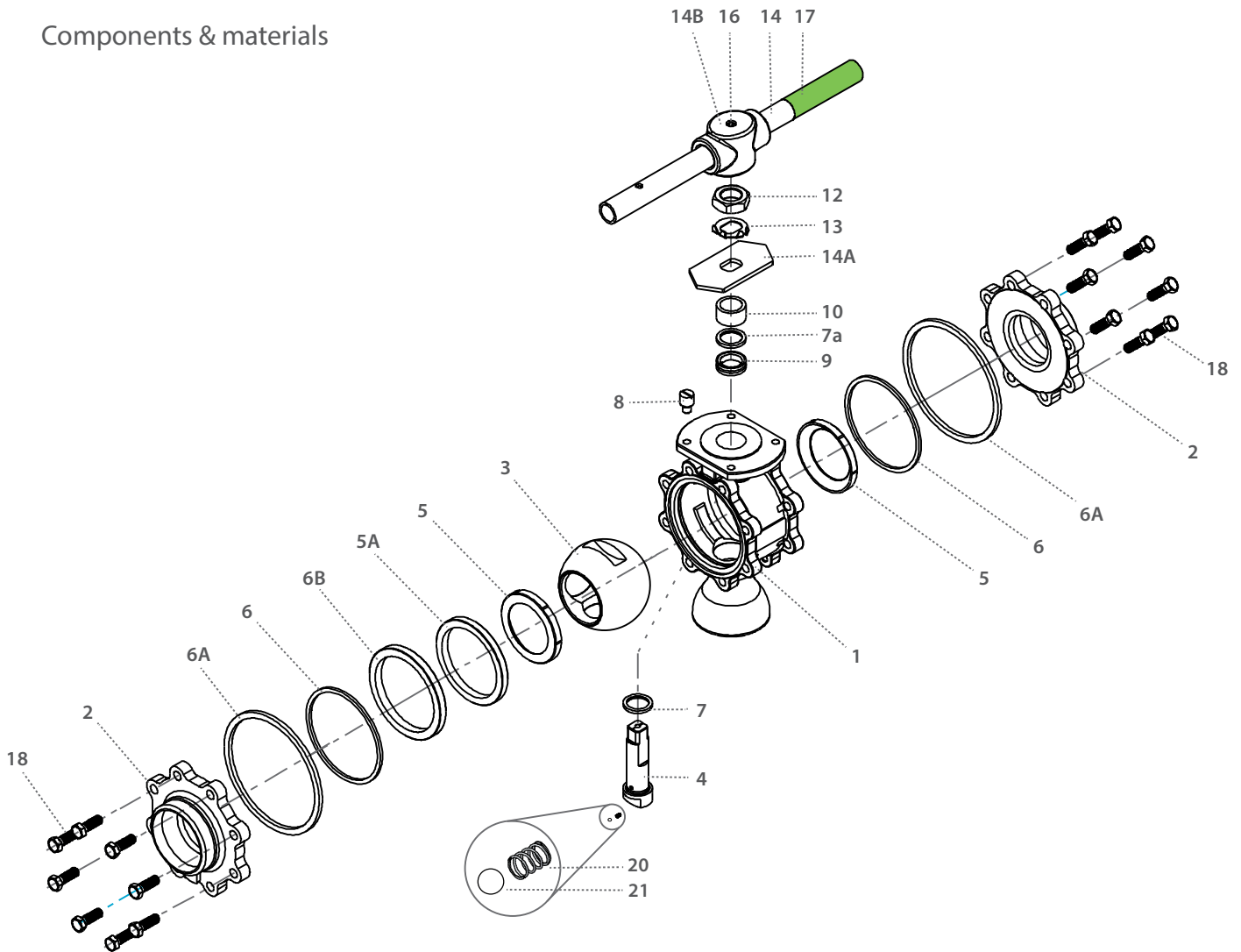

| Item | Description | Material specification | Qty. |
|------|--------------------|------------------------------|------|
| 1 | Body | Acc. Ordering Code | 1 |
| 2 | Plug | Acc. Ordering Code | 1 |
| 3 | Ball | Acc. Ordering Code | 1 |
| 4 | Stem | Acc. Ordering Code | 1 |
| 5* | Seat | Acc. Ordering Code | 2 |
| 6* | Body seal | Acc. Ordering Code | 2 |
| 6A* | Outer seal | Acc. Ordering Code | 2 |
| 6B | Support ring | S. Steel | 1 |
| 7* | Stem thrust seal | PEEK, CF PEEK, PCTFE (KEL-F) | 1 |
| 7a | Anti-abrasion ring | PEEK, CF PEEK, PCTFE (KEL-F) | 1 |
| 8 | Stop pin | S. Steel | 1 |
| 9* | Stem seal | CF PTFE, TFM | 1 |
| 10 | Follower | S. Steel | 1 |

| Item | Description | Material specification | Qty. |
|------|---------------------|------------------------|------|
| 11 | Disc spring | S. Steel | 2 |
| 12 | Stem nut | S. Steel | 1 |
| 13 | Tab lock washer | S. Steel | 1 |
| 14 | Handle | S. Steel | 1 |
| 14A | Stop plate | S. Steel | 1 |
| 14B | Wrench head | S. Steel | 1 |
| 16 | Wrench bolt | S. Steel | 1 |
| 17 | Sleeve | PVC | 1 |
| 18 | Body bolt | S. Steel | 16 |
| 20 | Anti-static spring | S. Steel | 2 |
| 21 | Anti-static plunger | S. Steel | 2 |
| 23 | Tag (not shown) | S. Steel | 1 |

* Repair kit components

Side Entry Floating Ball 3 Piece

Valve dimensions

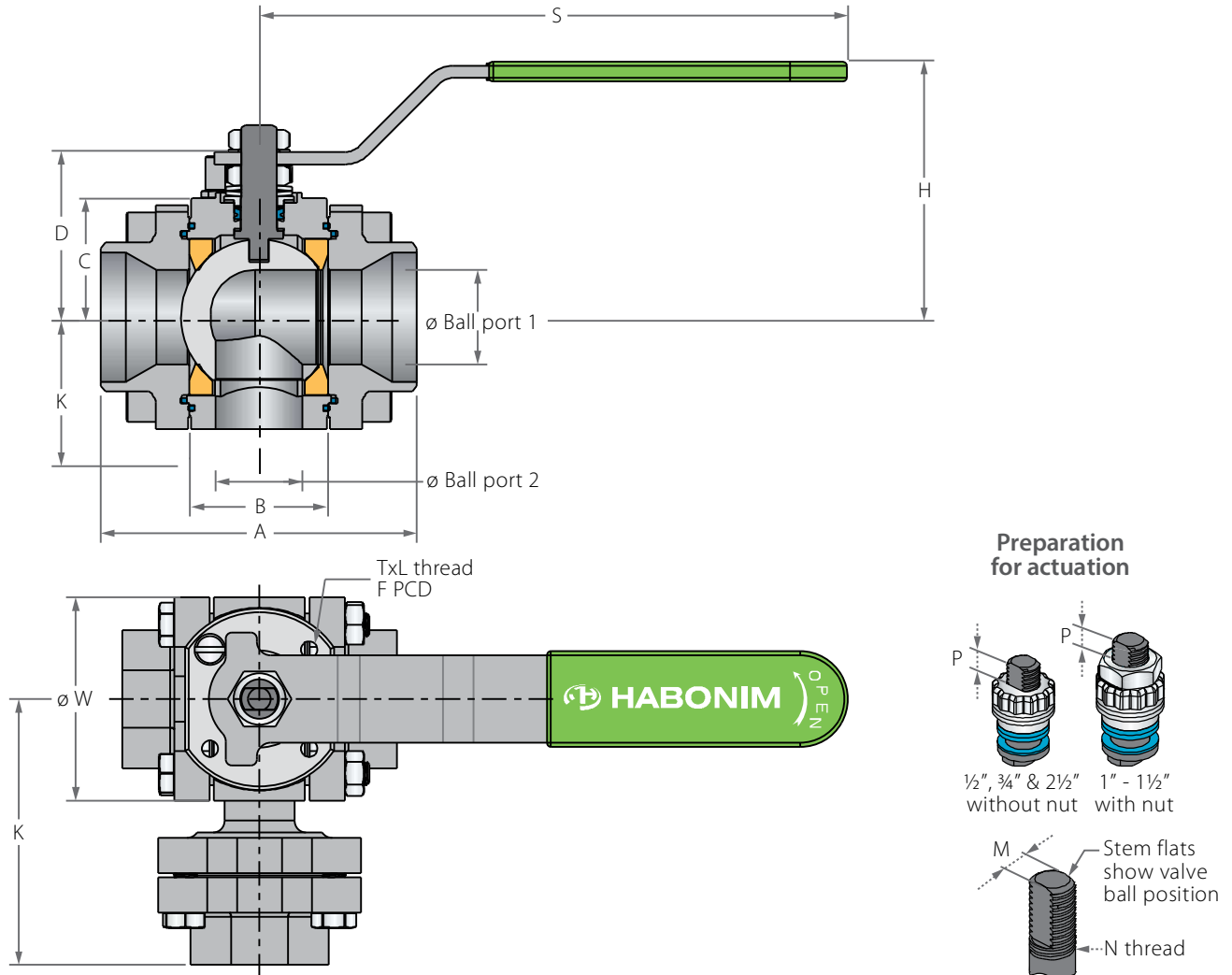

| Std. port | Full port | Unit | Ball port1 | Ball port2 | A | B | C | D | H | K | S | W | M | N | P | F | TxL | Weight kg/lb | Kv Cv |
|-----------|-----------|------|------------|------------|--------|-------|-------|-------|--------|--------|--------|--------|------|----------|-------------|-------|-------|--------------|-------|
| | DN8 | mm | 10.50 | 9.50 | 66.00 | 20.60 | 29.00 | 37.90 | 61.50 | 88.20 | 150.00 | 47.00 | 5.54 | | 6.65 (F03) | 36.00 | M5X10 | 1.00 | 2.4 |
| | 1/4" | inch | 0.41 | 0.37 | 2.60 | 0.81 | 1.14 | 1.49 | 2.42 | 3.48 | 5.91 | 1.85 | 0.22 | | 0.26 | 1.42 | M5X10 | 2.20 | 2.8 |
| DN15 | DN10 | mm | 10.50 | 9.50 | 66.00 | 20.60 | 29.00 | 37.90 | 61.50 | 88.20 | 150.00 | 47.00 | 5.54 | | 6.65 (F03) | 36.00 | M5X10 | 1.00 | 2.8 |
| 1/2" | 3/8" | inch | 0.41 | 0.37 | 2.60 | 0.81 | 1.14 | 1.49 | 2.42 | 3.48 | 5.91 | 1.85 | 0.22 | | 0.26 | 1.42 | M5X10 | 2.20 | 3.3 |
| DN20 | DN15 | mm | 14.30 | 11.90 | 70.60 | 24.50 | 31.40 | 40.30 | 63.90 | 93.70 | 150.00 | 53.70 | 5.54 | | 6.65 (F03) | 36.00 | M5X10 | 1.20 | 4 |
| 3/4" | 1/2" | inch | 0.56 | 0.47 | 2.78 | 0.97 | 1.24 | 1.59 | 2.52 | 3.68 | 5.91 | 2.11 | 0.22 | | 0.26 | 1.42 | M5X10 | 2.64 | 5 |
| DN25 | DN20 | mm | 20.60 | 15.90 | 93.70 | 31.70 | 38.10 | 55.60 | 79.40 | 119.00 | 187.00 | 63.70 | 7.54 | 7/16 UNF | 7.40 (F04) | 42.00 | M5X10 | 2.40 | 8 |
| 1" | 3/4" | inch | 0.81 | 0.63 | 3.69 | 1.25 | 1.50 | 2.19 | 3.13 | 4.68 | 7.36 | 2.51 | 0.30 | | 0.29 | 1.65 | M5X10 | 5.29 | 9 |
| DN32 | DN25 | mm | 25.40 | 20.50 | 108.00 | 41.30 | 42.70 | 60.20 | 84.10 | 130.15 | 187.00 | 71.70 | 7.54 | | 7.40 (F04) | 42.00 | M5X10 | 4.00 | 16 |
| 1 1/4" | 1" | inch | 1.00 | 0.81 | 4.25 | 1.62 | 1.68 | 2.37 | 3.31 | 5.13 | 7.36 | 2.82 | 0.30 | | 0.29 | 1.65 | M5X10 | 8.82 | 19 |
| DN40 | DN32 | mm | 31.80 | 26.60 | 115.50 | 48.40 | 43.60 | 73.00 | 97.00 | 139.05 | 237.00 | 86.70 | 8.71 | | 8.50 (F05) | 50.00 | M6X12 | 5.50 | 40 |
| 1 1/2" | 1 1/4" | inch | 1.25 | 1.05 | 4.55 | 1.91 | 1.72 | 2.87 | 3.82 | 5.47 | 9.33 | 3.41 | 0.34 | | 0.33 | 1.97 | M6X12 | 12.12 | 46 |
| DN50 | DN40 | mm | 38.10 | 35.00 | 128.00 | 56.30 | 48.30 | 77.80 | 101.80 | 149.45 | 237.00 | 96.90 | 8.71 | | 8.50 (F05) | 50.00 | M6X12 | 6.90 | 42 |
| 2" | 1 1/2" | inch | 1.50 | 1.38 | 5.04 | 2.22 | 1.90 | 3.06 | 4.01 | 5.88 | 9.33 | 3.82 | 0.34 | | 0.33 | 1.97 | M6X12 | 15.21 | 49 |
| DN65 | DN50 | mm | 50.80 | 48.00 | 158.00 | 72.60 | 70.00 | 88.10 | 115.10 | 175.40 | 237.00 | 108.00 | 8.71 | | 13.50 (F07) | 70.00 | M8X12 | 14.45 | 96 |
| 2 1/2" | 2" | inch | 2.00 | 1.89 | 6.22 | 2.86 | 2.76 | 3.47 | 4.53 | 6.90 | 9.33 | 4.25 | 0.34 | | 0.53 | 2.76 | M8X12 | 31.85 | 111 |



Side Entry Floating Ball 3 Piece

Components & materials

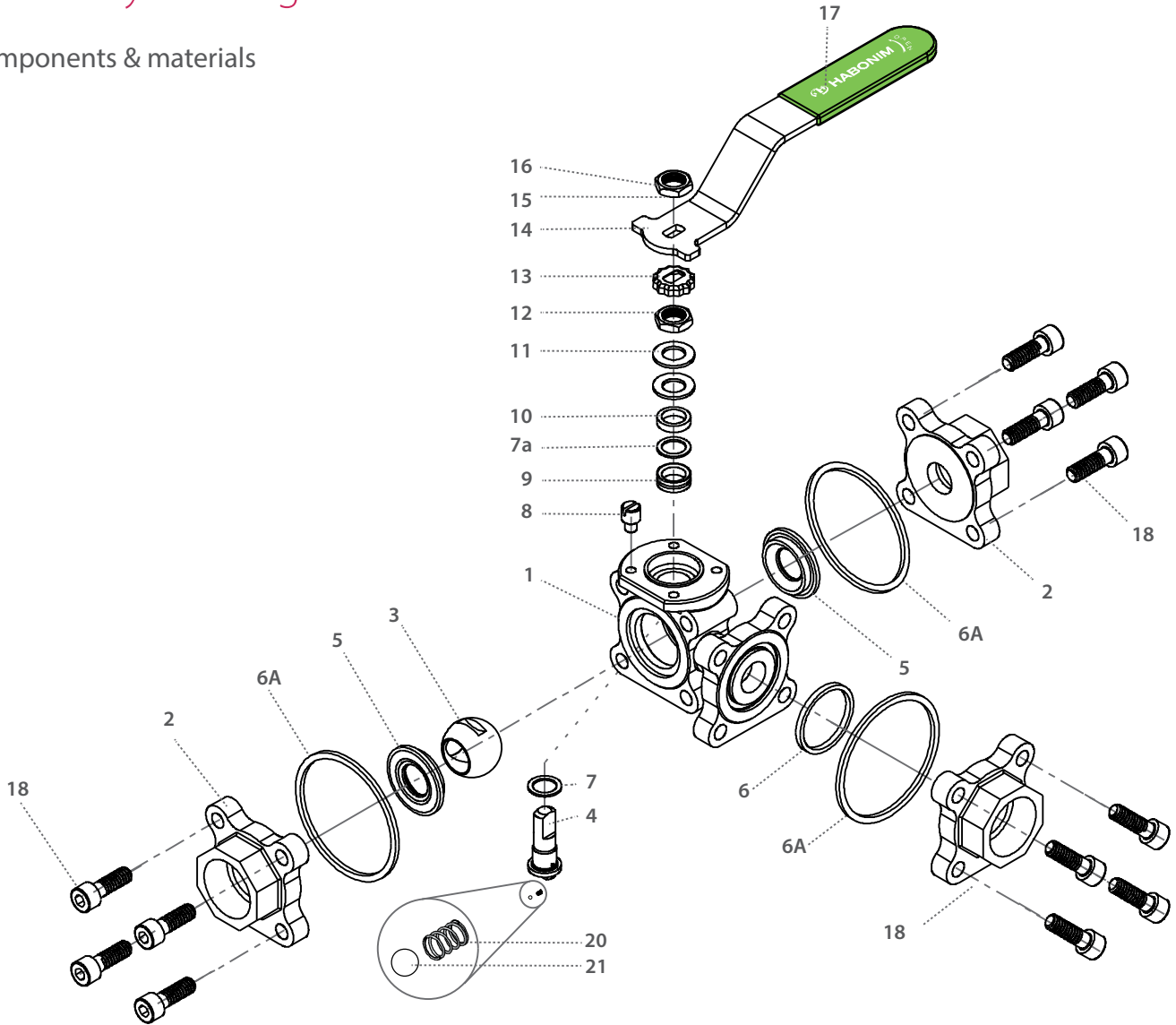

| Item | Description | Material specification | Qty. |
|------|--------------------|------------------------|------|
| 1 | Body | Acc. Ordering Code | 1 |
| 2 | Ends | Acc. Ordering Code | 3 |
| 3 | Ball | Acc. Ordering Code | 1 |
| 4 | Stem | Acc. Ordering Code | 1 |
| 5* | Seat | Acc. Ordering Code | 2 |
| 6* | Body seal | Acc. Ordering Code | 3 |
| 6A | Outer seal | Acc. Ordering Code | 3 |
| 7* | Stem thrust seal | PEEK, CF PEEK, PCTFE | 1 |
| 7a | Anti-abrasion ring | PEEK, CF PEEK, PCTFE | 1 |
| 8 | Stop pin | S. Steel | 1 |
| 9* | Stem seal | CF PTFE, TFM | 1 |
| 10 | Follower | S. Steel | 1 |

⁽¹⁾ One body seal is used in case of Seat-Seal one piece construction (item #5), otherwise three body seals are used

| Item | Description | Material specification | Qty. |
|------|---------------------|------------------------|------|
| 10A | Slide bearing | S. Steel | 1 |
| 11 | Disc spring | S. Steel | 2 |
| 12 | Stem nut | S. Steel | 1 |
| 13 | Locking clip | S. Steel | 1 |
| 14 | Handle | S. Steel | 1 |
| 15 | Serrated washer | S. Steel | 1 |
| 16 | Handle nut | S. Steel | 1 |
| 17 | Sleeve | PVC | 1 |
| 18 | Body bolt | S. Steel | 4 |
| 20 | Anti-static spring | S. Steel | 1 |
| 21 | Anti-static plunger | S. Steel | 1 |
| 23 | Tag (not shown) | S. Steel | 1 |

* Repair kit components

Side Entry Floating Ball 3 Piece

Valve dimensions

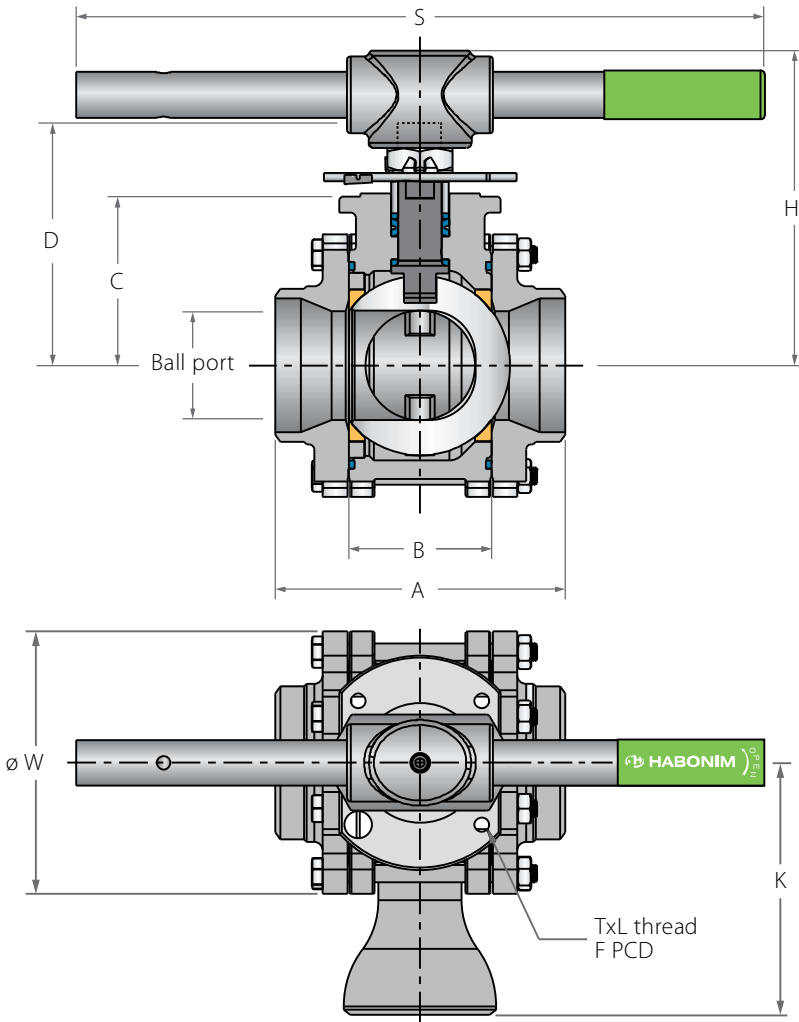

Preparation for actuation

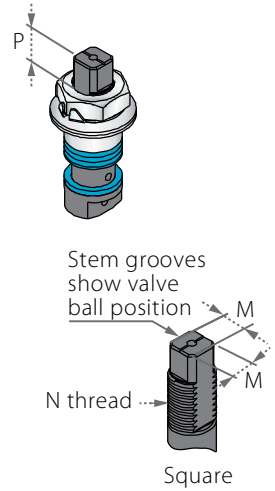

| Std. port | Full port | Unit | Ball port 1 | Ball port 2 | A | B | C | D | H | K | S | W | M | N | P | F | TxL | Weight kg/lb | Kv Cv |
|-----------|-----------|------|-------------|-------------|-------|-------|-------|-------|-------|------|-------|--------|-------|--------|-------------|--------|--------|--------------|-------|
| DN80 | DN65 | mm | 63.75 | 80.50 | 169 | 83.3 | 98.3 | 144.9 | 185 | 163 | 400 | 140.00 | 18.90 | 1"-14 | 16.70 (F10) | 102.00 | M10x20 | 18.00 | 129 |
| 3" | 2½" | inch | 2.51 | 3.17 | 6.65 | 3.28 | 3.87 | 5.70 | 7.28 | 6.42 | 15.75 | 5.50 | 0.74 | UNS-2A | 0.66 | 4.02 | M10x20 | 39.67 | 150 |
| DN100 | DN80 | mm | 80.00 | 63.25 | 214 | 108.8 | 114.1 | 160.7 | 200 | 183 | 600 | 177.00 | 18.90 | 1"-14 | 16.70 (F10) | 102.00 | M10x20 | 28.20 | 182 |
| 4" | 3" | inch | 3.15 | 2.49 | 8.43 | 4.28 | 4.49 | 6.33 | 7.87 | 7.20 | 23.62 | 6.97 | 0.74 | UNS-2A | 0.66 | 4.02 | M10x20 | 62.15 | 211 |
| | DN100 | mm | 92.00 | 67.00 | 239 | 123 | 124 | 170.5 | 211 | 200 | 600 | 217.00 | 18.90 | 1"-14 | 16.70 (F10) | 102.00 | M10x20 | 36.00 | 334 |
| | 4" | inch | 3.62 | 2.64 | 9.41 | 4.84 | 4.88 | 6.71 | 8.31 | 7.87 | 23.62 | 8.54 | 0.74 | UNS-2A | 0.66 | 4.02 | M10x20 | 79.34 | 388 |
| DN150 | | mm | 111.35 | 77.90 | 346 | 146 | 157 | 226 | 286 | 212 | 916 | 266.00 | 28.45 | 1½"-12 | 26.20 (F12) | 125.00 | M12x20 | 41.00 | 437 |
| 6" | | inch | 4.38 | 3.07 | 13.62 | 5.75 | 6.18 | 8.90 | 11.26 | 8.35 | 36.06 | 10.47 | 1.12 | UNF-2A | 1.03 | 4.92 | M12x20 | 90.36 | 507 |



Side Entry Floating Ball 3 Piece

Components & materials

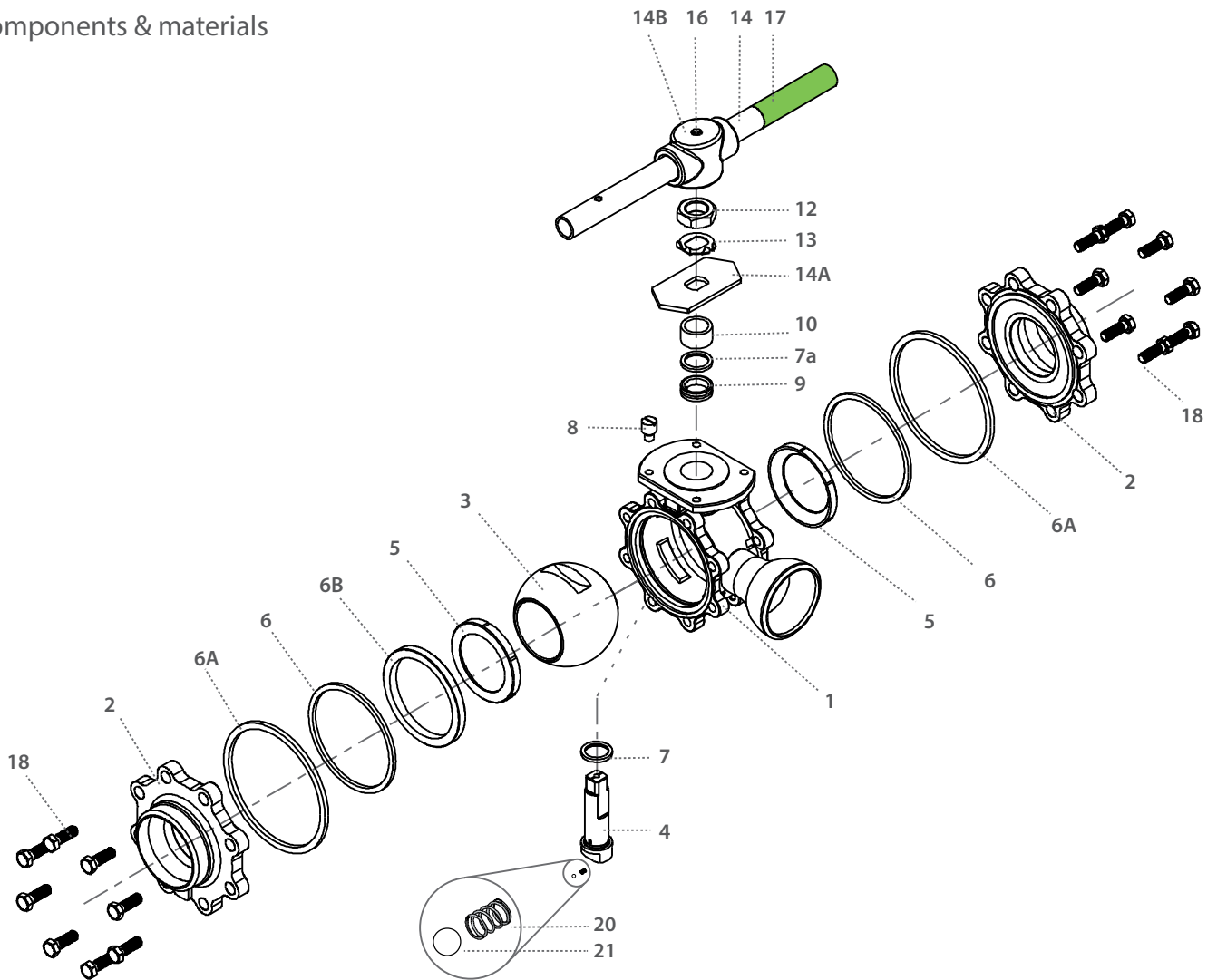

| Item | Description | Material specification | Qty. |
|------|--------------------|------------------------------|------|
| 1 | Body | Acc. Ordering Code | 1 |
| 2 | Plug | Acc. Ordering Code | 1 |
| 3 | Ball | Acc. Ordering Code | 1 |
| 4 | Stem | Acc. Ordering Code | 1 |
| 5* | Seat | Acc. Ordering Code | 2 |
| 6* | Body seal | Acc. Ordering Code | 1 |
| 6A | Outer seal | Acc. Ordering Code | |
| 6B | Support ring | Acc. Ordering Code | |
| 7* | Stem thrust seal | PEEK, CF PEEK, PCTFE (KEL-F) | 1 |
| 7a | Anti-abrasion ring | PEEK, CF PEEK, PCTFE (KEL-F) | 1 |
| 8 | Stop pin | Acc. Ordering Code | 1 |
| 9* | Stem seal | CF PTFE, TFM, Graphite | 1 |
| 10 | Follower | S. Steel | 1 |

| Item | Description | Material specification | Qty. |
|------|--------------------|------------------------|------|
| 11 | Disc spring | S. Steel | 2 |
| 12 | Stem nut | S. Steel | 1 |
| 13 | Tab lock washer | S. Steel | 1 |
| 14 | Handle | S. Steel | 1 |
| 14A | Stop plate | S. Steel | 1 |
| 14B | Wrench head | S. Steel | 1 |
| 16 | Wrench bolt | S. Steel | 1 |
| 17 | Sleeve | PVC | 1 |
| 20 | Antistatic spring | S. Steel | 2 |
| 21 | Antistatic plunger | S. Steel | 2 |
| 23 | Tag (not shown) | S. Steel | 1 |

* Repair kit components



Diverter | Side Entry 3 Piece - Ordering Code System

"Mandatory option" options are marked with **green background** | "Standard offer" options are marked with **light green background**

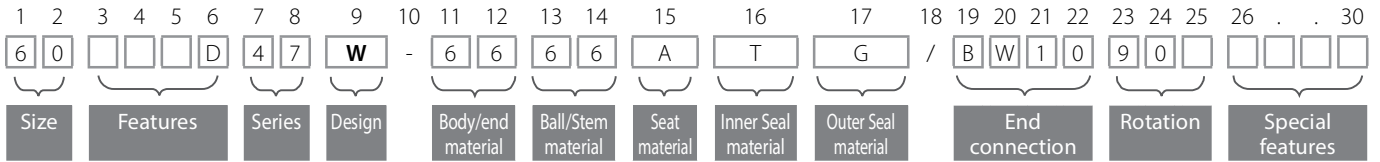

| Size (1-2) | | |
|------------|------|-----|
| Code | inch | mm |
| 02 | ¼" | 8 |
| 03 | ⅜" | 10 |
| 05 | ½" | 15 |
| 07 | ¾" | 20 |
| 10 | 1" | 25 |
| 12 | 1¼" | 32 |
| 15 | 1½" | 40 |
| 20 | 2" | 50 |
| 25 | 2½" | 65 |
| 30 | 3" | 80 |
| 40 | 4" | 100 |
| 60 | 6" | 150 |
| 80 | 8" | 200 |

| Features (3-6) | |
|----------------|-------------------------------|
| D | Diverter bottom entry |
| B | Full port |
| O | Clean assembly for O2 service |
| K | Chlorine service |
| F | Shell only - fire safe |

| Series (7-8) | |
|--------------|----------------------|
| D47 | 3 piece bottom entry |
| S47 | 3 piece side entry |

| Design (9) | |
|------------|----------------------------------|
| W | Total HermetiX Integrity package |

| Body/Ends material (11-12) | |
|----------------------------|------------------------|
| 6 | S. SteelCF8M/CF3M |
| 1 | Bronze |
| 4 | C. steel A216 WCB/A105 |
| 9 | C. steel A352 LCB |
| 7 | Monel |
| A | Alloy-20 A351 CN7M |
| W | Alloy-C22 B574 |
| D | Duplex A479 |
| K | Super Duplex A479 |
| S | 254SMO A479 |

| Ball material (13) | |
|--------------------|-------------------|
| 6 | S. SteelCF8M/CF3M |
| W | Hasteloy-C22 |
| S | 254SMO |
| D | Duplex |
| 1 | Bronze |
| K | Super Duplex |
| 7 | Monel |
| A | Alloy-20 |
| C | Hasteloy-C276 |

| Stem material (14) | |
|--------------------|------------------------|
| 6 | S. Steel316L |
| M | High Strength S. Steel |
| Z | Inconel 718 B637 |
| W | Alloy-C22 B574 |
| S | 254SMO A479 |
| A | Alloy-20 A351 CN7M |
| D | Duplex A479 |
| K | Super Duplex A479 |
| 7 | Monel |
| C | Hasteloy-C276 |

| Seat material (15) | |
|--------------------|-------------|
| A | TFM(3) |
| U | UHMWPE |
| T | PTFE(3) |
| P | CF PTFE(3) |
| C | PCTFE |
| K | CF PEEK |
| L | Virgin Peek |
| Y | Delrin |
| W | PVDF |

| Inner Seal Material (16) | |
|--------------------------|-------------------|
| T | PTFE |
| A | TFM |
| U | UHMWPE |
| V | Viton |
| B | NBR |
| G | Expanded graphite |

| Outer Seal Material (17) | |
|--------------------------|-------------------|
| G | Expanded graphite |
| T | PTFE |
| A | TFM |
| U | UHMWPE |
| V | Viton |
| B | NBR |

| End Connection (19-22) | |
|------------------------|----------------------------|
| Welded ends | |
| BW10 | Buttweld schd. 10 |
| BW | Buttweld schd. 40 |
| SW | Socket weld |
| XBW10 | Extended buttweld schd. 10 |
| XBW | Extended buttweld schd. 40 |
| XSW | Extended socket weld |
| BW5 | Buttweld schd. 5 |
| BW80 | Buttweld schd. 80 |
| BWO | Buttweld tube OD |
| BWD | Buttweld DIN 11850 |
| BWI | buttweld ISO |
| SWO | Socket weld tube OD |
| ETO | Extended tube OD |
| ETI | Extended buttweld ISO |
| ETD | Extended buttweld DIN |

| Threaded | |
|----------|---|
| NPT | ASME B1.20.1 - National Pipe Taper thread |
| BSPT | EN 10226 - Pipe Taper thread |
| BSPP | ISO228-1, DIN3852 - Pipe Parallel thread |
| DIN3852 | DIN3852 - Pipe Parallel thread |
| AS5202 | SAE internal straight thread |
| MNPT | Male NPT |
| MBSPT | Male BSPT |

| Flanged | |
|---------|--------------------|
| 150 | ASME B16.5 #150 RF |
| 300 | ASME B16.5 #300 RF |
| 600 | ASME B16.5 #600 RF |
| 900 | ASME B16.5 #900 RF |
| PN16 | EN1092 PN16 RF |
| PN40 | EN1092 PN40 RF |
| PN64 | EN1092 PN64 RF |
| PN100 | EN1092 PN100 RF |
| PN160 | EN1092 PN160 RF |

| Clamp | |
|-------|--|
| LL | Compression fitting (Imperial) - No Nuts & Ferrules |
| LM | Compression fitting (metric) - No Nuts & Ferrules |
| LL-NF | Compression fitting (Imperial) - with Nuts & Ferrules |
| LM-NF | Compression fitting (metric) - with Nuts & Ferrules |
| TC | Tri-Clamp |
| GR | Grayloc® compatible hub (Grayloc® is a registered trademark of Grayloc Products, L.L.C.) |

| Rotation (23 -25) | |
|-------------------|---|
| 90 | 90 degrees rotation |
| 180 | 180 degrees rotation applicable for bottom entry diverter valve L |

| Special Features (24-30) | |
|--------------------------|------------------------------------|
| B | Body made from rolled bar |
| EP | Electropolished |
| WR | DD stem |
| G... | Internal surface finish (G24, G32) |

| Valve Special Stem Seals | |
|--------------------------|--|
| AAX | FDA compliant stem seal. TFM thrust bearing and X shape gasket |
| PPX | CF PTFE thrust and X shape gasket |
| CAX | PCTFE thrust and TFM X shape gasket |
| CPX | PCTFE thrust and CF PTFE X shape gasket |
| HC | High Cycle service |
| HYD | Hydrogen |

D31

S31

D32

S32



General Use Industrial

FLOATING BALL

DIVERTER
SIDE ENTRY FLANGED

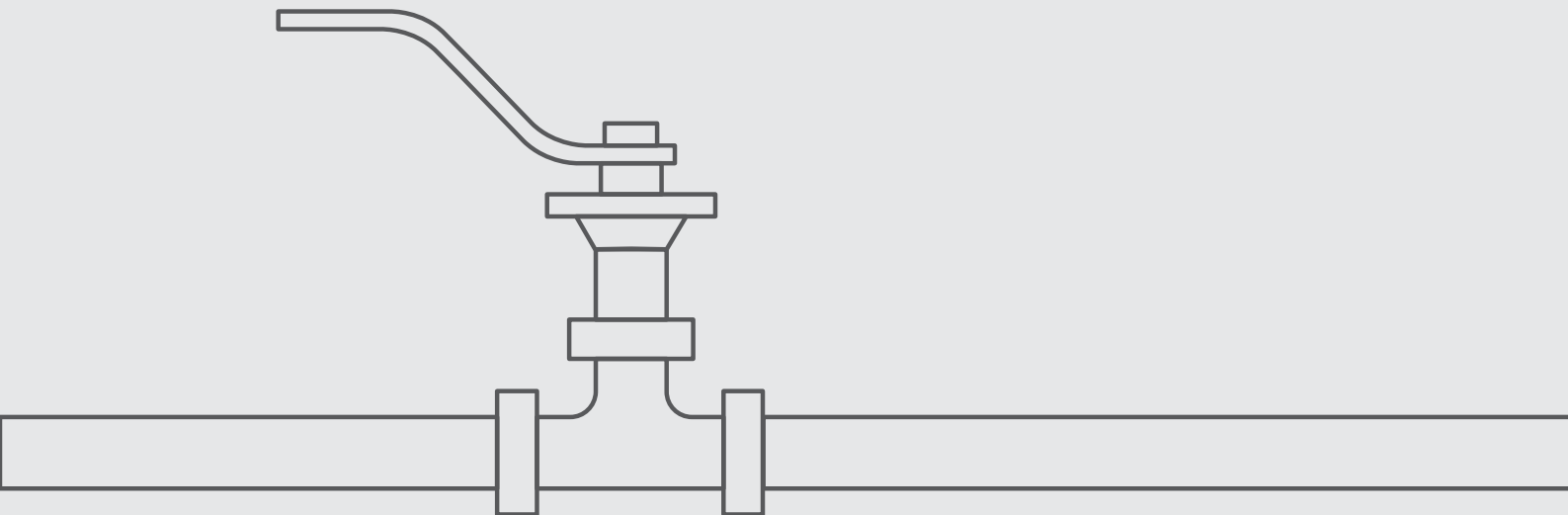



D31

S32

D32

S32



Side Entry - S31, S32

Rotation: 90°

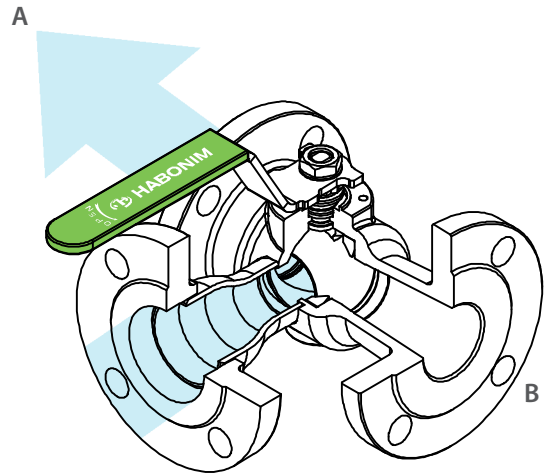
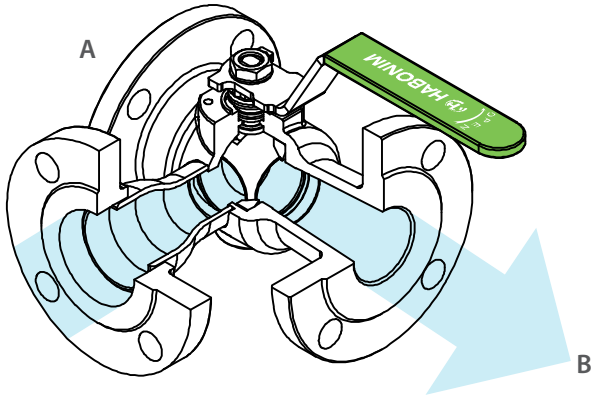

Bottom Entry - D31, D32

Rotation: 90°

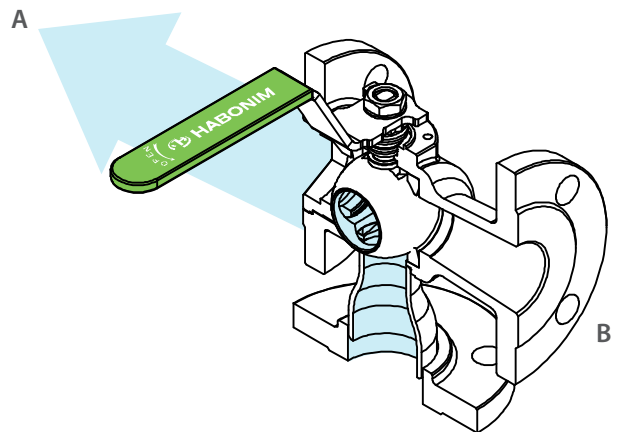
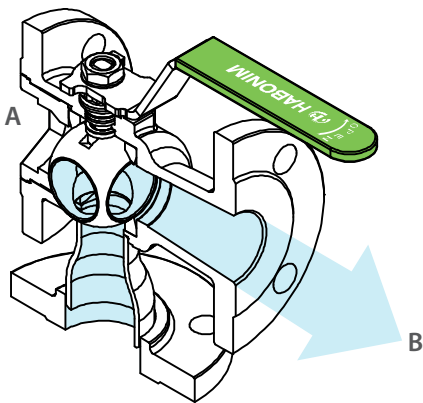

Bottom Entry - D31, D32

Rotation: 180°

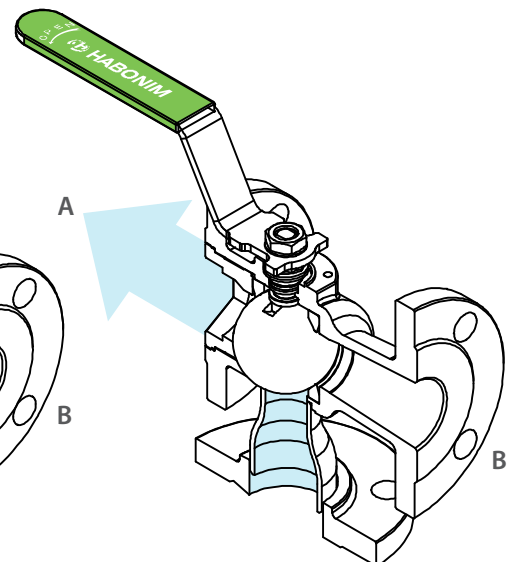
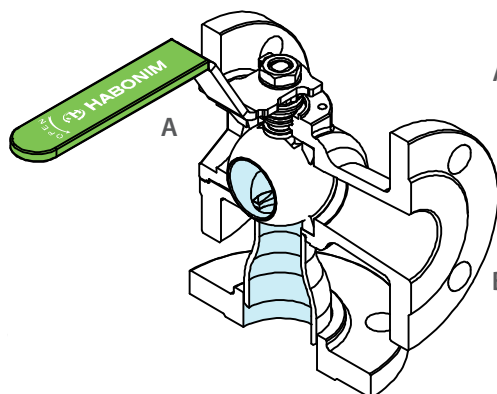
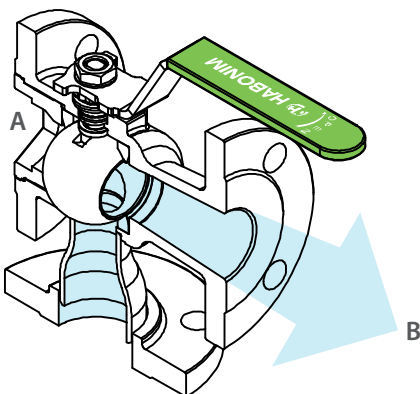

D31

D32

1/2"-2" | DN15-DN50 | CLASS 150/300

Diverter Floating Ball Flanged

Valve dimensions

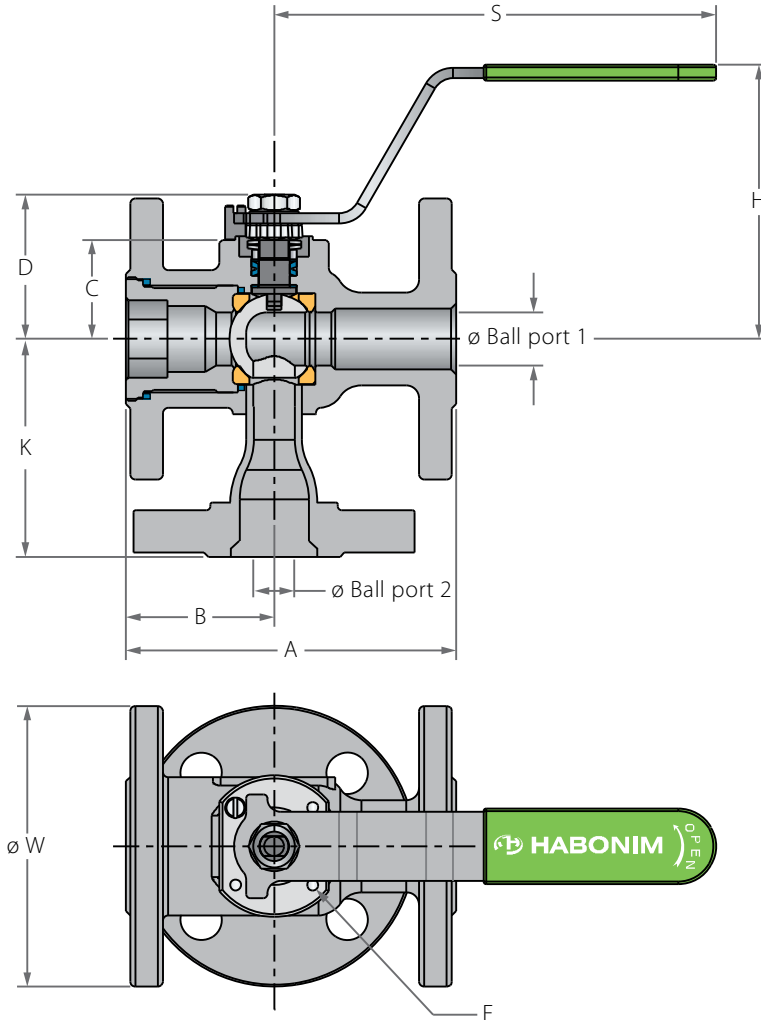

Preparation for actuation

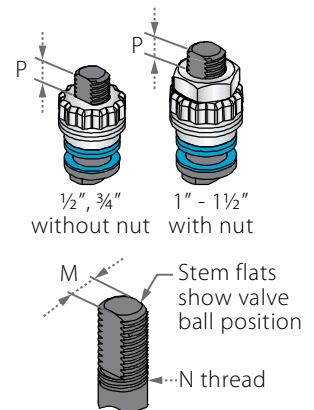

| Std. port | Unit | Ball port1 | Ball port2 | A | | B | C | D | H | K | S | W | | M | N | P | F | Weight kg/lb | | Kv |
|-----------|------|------------|------------|--------|--------|-------|-------|-------|--------|--------|--------|--------|--------|------|------|------------|-------|--------------|------|-----|
| | | | | 150 | 300 | | | | | | | 150 | 300 | | | | | 150 | 300 | |
| DN15 | mm | 10.5 | 9.5 | 108.00 | 140.00 | 46.00 | 29.00 | 38.00 | 92.00 | 70.00 | 151.00 | 88.90 | 95.25 | 5.54 | 3/8 | 6.65 (F03) | 36.00 | 1.7 | 2.4 | 2.8 |
| 1/2" | inch | 0.41 | 0.37 | 4.25 | 5.50 | 1.81 | 1.14 | 1.50 | 3.62 | 2.76 | 5.94 | 3.50 | 3.75 | 0.22 | UNF | 0.26 | 1.42 | 3.8 | 5.3 | 3.3 |
| DN20 | mm | 14.3 | 11.9 | 117.00 | 152.00 | 49.00 | 31.40 | 40.30 | 94.00 | 85.00 | 151.00 | 98.55 | 163.07 | 5.54 | 3/8 | 6.65 (F03) | 36.00 | 2.3 | 3.3 | 4 |
| 3/4" | inch | 0.56 | 0.47 | 4.61 | 6.00 | 1.93 | 1.24 | 1.59 | 3.70 | 3.35 | 5.94 | 3.88 | 6.42 | 0.22 | UNF | 0.26 | 1.42 | 5.1 | 7.3 | 5 |
| DN25 | mm | 20.6 | 15.9 | 127.00 | 165.00 | 57.00 | 38.20 | 55.60 | 103.50 | 90.00 | 170.00 | 107.95 | 123.95 | 7.54 | 7/16 | 7.40 (F04) | 42.00 | 3.1 | 4.6 | 8 |
| 1" | inch | 0.81 | 0.63 | 5.00 | 6.50 | 2.25 | 1.50 | 2.19 | 4.07 | 3.54 | 6.69 | 4.25 | 4.88 | 0.30 | UNF | 0.29 | 1.65 | 7.3 | 10.2 | 9 |
| DN40 | mm | 31.8 | 26.6 | 165.00 | 190.00 | 62.00 | 43.60 | 73.10 | 119.20 | 161.00 | 220.50 | 127.00 | 155.52 | 8.71 | 1/2 | 8.50 (F05) | 50.00 | 5.5 | 8.7 | 40 |
| 1 1/2" | inch | 1.25 | 1.05 | 6.50 | 7.50 | 2.44 | 1.72 | 2.88 | 4.70 | 6.34 | 8.68 | 5.00 | 6.10 | 0.34 | UNF | 0.33 | 1.97 | 12.2 | 19.3 | 46 |
| DN50 | mm | 38.1 | 35.0 | 178.00 | 216.00 | 68.00 | 48.30 | 77.80 | 123.90 | 130.00 | 220.50 | 152.40 | 165.10 | 8.71 | 9/16 | 8.50 (F05) | 50.00 | 8.1 | 10.8 | 42 |
| 2" | inch | 1.5 | 1.38 | 7.00 | 8.50 | 2.67 | 1.90 | 3.06 | 4.88 | 5.12 | 8.68 | 6.00 | 6.50 | 0.34 | UNF | 0.33 | 1.97 | 18 | 24 | 49 |

D31

D32

1/2"-2" | DN15-DN50 | CLASS 150/300



Diverter Floating Ball Flanged

Components & materials

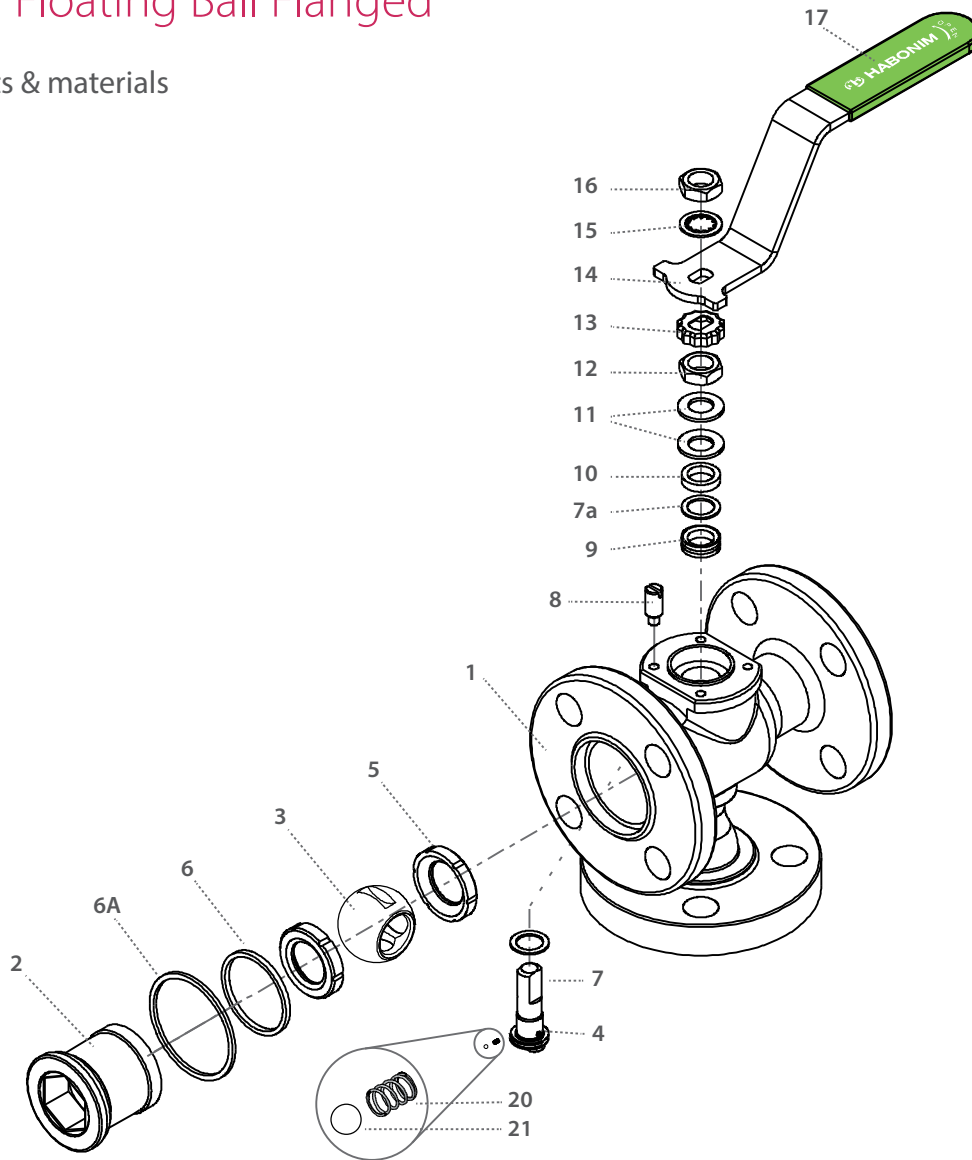

| Item | Description | Material specification | Qty. |
|------|--------------------|------------------------------|------|
| 1 | Body | Acc. Ordering Code | 1 |
| 2 | Plug | Acc. Ordering Code | 1 |
| 3 | Ball | Acc. Ordering Code | 1 |
| 4 | Stem | Acc. Ordering Code | 1 |
| 5* | Seat | Acc. Ordering Code | 2 |
| 6* | Inner seal | PTFE | 1 |
| 6A | Outer seal | Acc. Ordering Code | |
| 7* | Stem thrust seal | PEEK, CF PEEK, PCTFE (KEL-F) | 1 |
| 7a | Anti-abrasion ring | PEEK, CF PEEK, PCTFE (KEL-F) | 1 |
| 8 | Stop pin | S. Steel | 1 |
| 9* | Stem seal | CF PTFE, TFM | 1 |
| 10 | Follower | S. Steel | 1 |

| Item | Description | Material specification | Qty. |
|------|---------------------|------------------------|------|
| 11 | Disc spring | S. Steel | 2 |
| 12 | Stem nut | S. Steel | 1 |
| 13 | Locking clip | S. Steel | 1 |
| 14 | Handle | S. Steel | 1 |
| 15 | Serrated washer | S. Steel | 1 |
| 16 | Handle nut | S. Steel | 1 |
| 17 | Sleeve | PVC | 1 |
| 20 | Anti-static spring | S. Steel | 1 |
| 21 | Anti-static plunger | S. Steel | 1 |
| 23 | Tag (not shown) | S. Steel | 1 |

* Repair kit components

D3 1

D32

3"-8" | DN80-DN200 | CLASS 150/300

Diverter Floating Ball Flanged

Valve dimensions

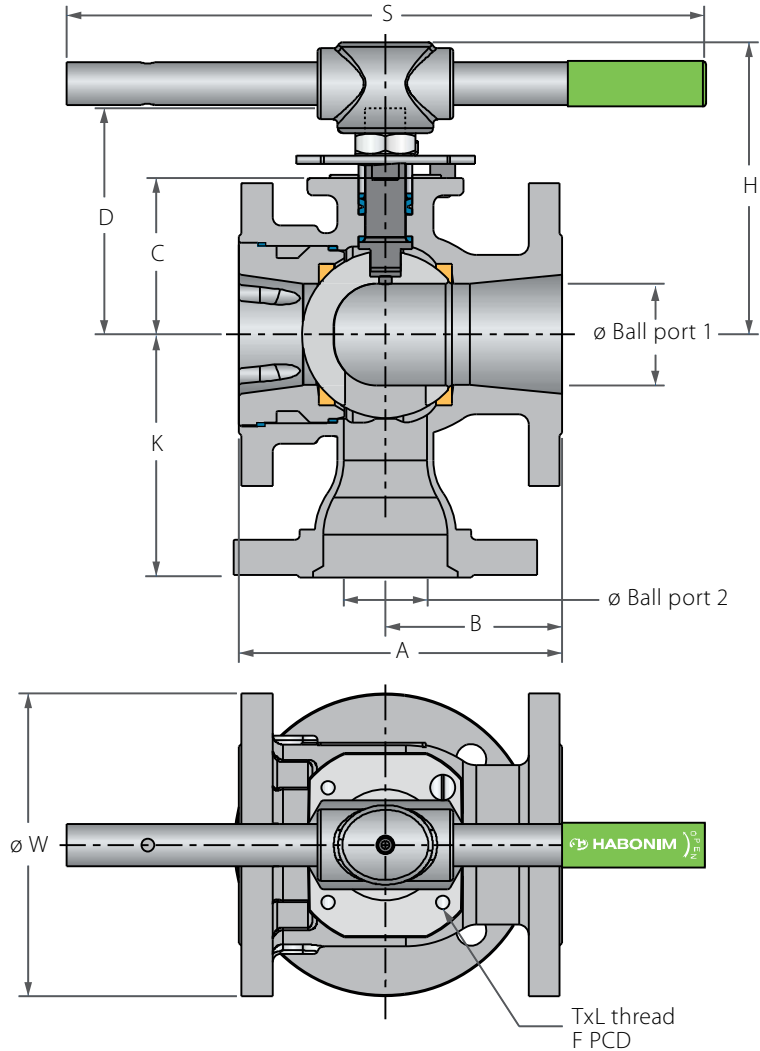

Preparation for actuation

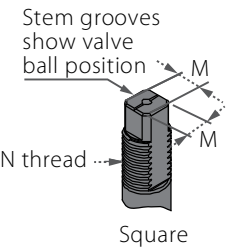
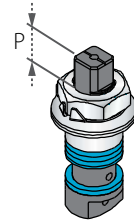

| Std. port | Unit | Ball port1 | Ball port2 | A | | B | C | D | H | K | S | W | | M | M-DD | N | P | F | TxL | Weight kg/lb | | Kv |
|-----------|------|------------|------------|--------|--------|--------|--------|--------|--------|--------|--------|--------|--------|-------|-------|--------|-------------|--------|--------|--------------|--------|-----|
| | | | | 150 | 300 | | | | | | | 150 | 300 | | | | | | | 150 | 300 | |
| DN80 | mm | 63.50 | 50.00 | 203.00 | 284.00 | 92.00 | 98.40 | 145.00 | 185.10 | 153.00 | 400.00 | 190.50 | 209.55 | 18.90 | 15.90 | 1"-14 | 16.70 (F10) | 102.00 | M10x20 | 18.00 | 22.70 | 129 |
| 3" | inch | 2.50 | 1.97 | 8.00 | 11.18 | 3.62 | 3.88 | 5.72 | 7.28 | 6.02 | 15.75 | 7.50 | 8.25 | 0.74 | 0.63 | UNS-2A | 0.66 | 4.02 | M10x20 | 40.00 | 50.40 | 150 |
| DN100 | mm | 82.60 | 63.00 | 229.00 | 305.00 | 102.00 | 114.10 | 161.00 | 201.00 | 185.00 | 610.00 | 228.60 | 254.00 | 18.90 | 15.90 | 1"-14 | 16.70 (F10) | 102.00 | M10x20 | 28.20 | 36.30 | 182 |
| 4" | inch | 3.25 | 2.48 | 9.00 | 12.00 | 4.00 | 4.49 | 6.34 | 7.91 | 7.28 | 24.01 | 9.00 | 10.00 | 0.74 | 0.63 | UNS-2A | 0.66 | 4.02 | M10x20 | 62.80 | 80.60 | 211 |
| DN150 | mm | 111.10 | 78.00 | 267.00 | 403.20 | 108.00 | 157.40 | 226.00 | 285.90 | 250.00 | 916.00 | 279.40 | 317.50 | 28.45 | 23.75 | 1½"-12 | 26.20 (F12) | 125.00 | M12x20 | 41.00 | 69.00 | 437 |
| 6" | inch | 4.38 | 3.07 | 10.50 | 15.88 | 4.25 | 6.20 | 8.91 | 11.25 | 9.84 | 36.08 | 11.00 | 12.50 | 1.12 | 0.94 | UNF-2A | 1.03 | 4.92 | M12x20 | 91.00 | 153.00 | 507 |
| DN200 | mm | 144.40 | 98.00 | 292.00 | 419.00 | 163.50 | 185.20 | 254.00 | 313.60 | 300.00 | 916.00 | 342.90 | 381.00 | 28.45 | 23.75 | 1½"-12 | 26.20 (F12) | 125.00 | M12x20 | 82.00 | 105.00 | 698 |
| 8" | inch | 5.68 | 3.86 | 11.50 | 16.50 | 5.37 | 7.30 | 10.00 | 12.34 | 11.81 | 36.08 | 13.50 | 15.00 | 1.12 | 0.94 | UNF-2A | 1.03 | 4.92 | M12x20 | 182.00 | 233.00 | 810 |



Diverter Floating Ball Flanged

Components & materials

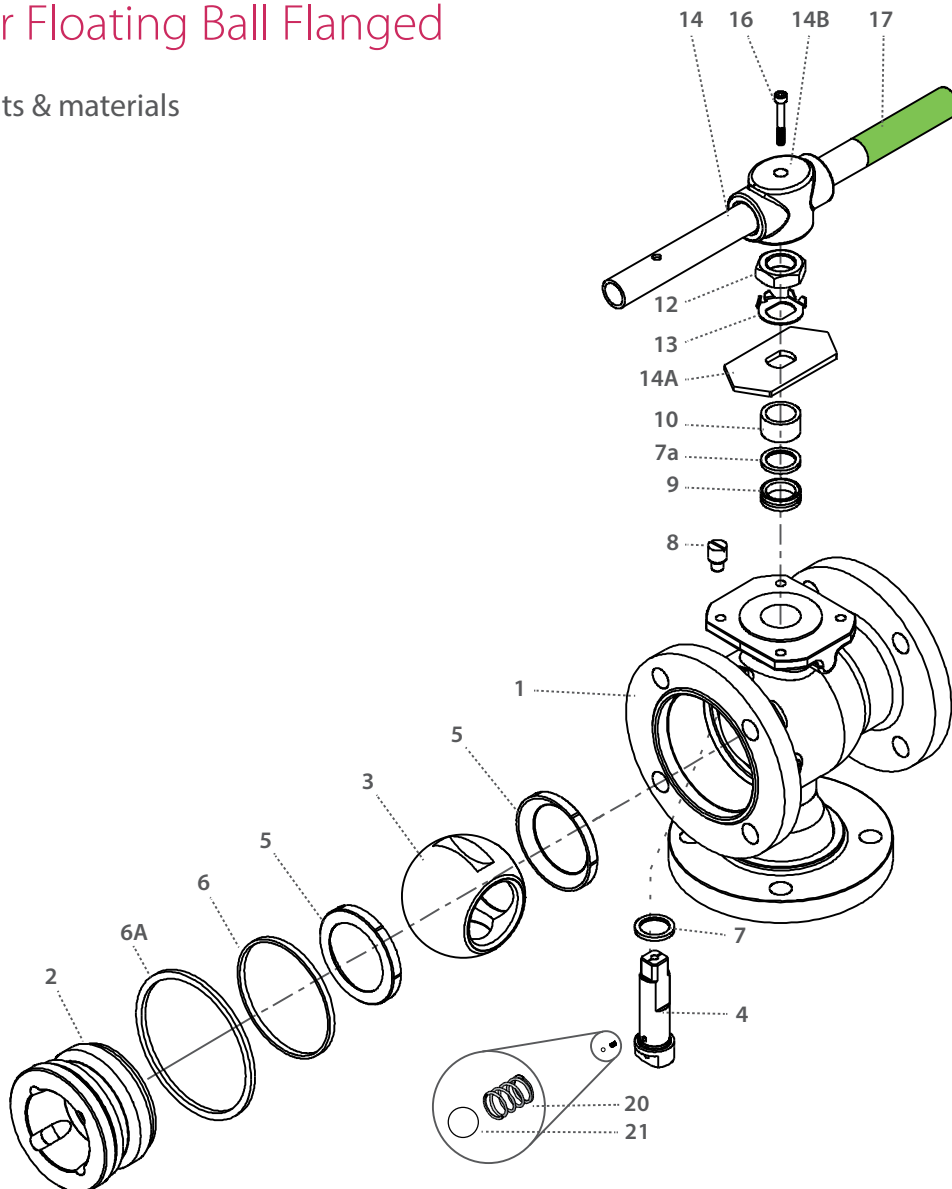

| Item | Description | Material specification | Qty. |
|------|--------------------|------------------------------|------|
| 1 | Body | Acc. Ordering Code | 1 |
| 2 | Plug | Acc. Ordering Code | 1 |
| 3 | Ball | Acc. Ordering Code | 1 |
| 4 | Stem | Acc. Ordering Code | 1 |
| 5* | Seat | Acc. Ordering Code | 2 |
| 6* | Body seal | PTFE | 1 |
| 6A | Outer seal | Acc. Ordering Code | |
| 7* | Stem thrust seal | PEEK, CF PEEK, PCTFE (KEL-F) | 1 |
| 7a | Anti-abrasion ring | PEEK, CF PEEK, PCTFE (KEL-F) | 1 |
| 8 | Stop pin | S. Steel | 1 |
| 9* | Stem seal | CF PTFE, TFM | 1 |
| 10 | Follower | S. Steel | 1 |

| Item | Description | Material specification | Qty. |
|------|---------------------|------------------------|------|
| 11 | Disc spring | S. Steel | 2 |
| 12 | Stem nut | S. Steel | 1 |
| 13 | Tab lock washer | S. Steel | 1 |
| 14 | Handle | S. Steel | 1 |
| 14A | Stop plate | S. Steel | 1 |
| 14B | Wrench head | S. Steel | 1 |
| 16 | Wrench bolt | S. Steel | 1 |
| 17 | Sleeve | PVC | 1 |
| 20 | Anti-static spring | S. Steel | 2 |
| 21 | Anti-static plunger | S. Steel | 2 |
| 23 | Tag (not shown) | S. Steel | 1 |

* Repair kit components

Side Entry Floating Ball Flanged

Valve dimensions

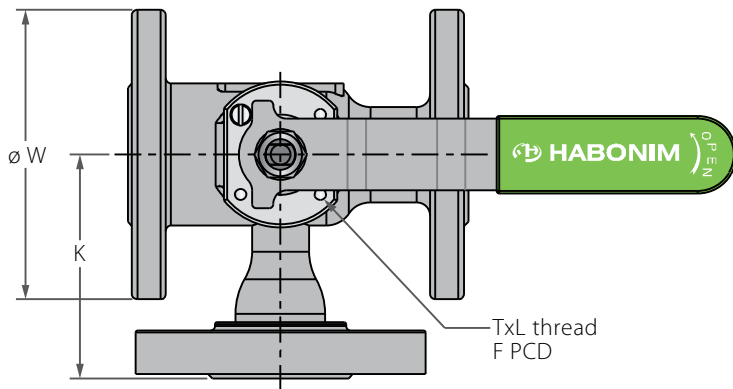
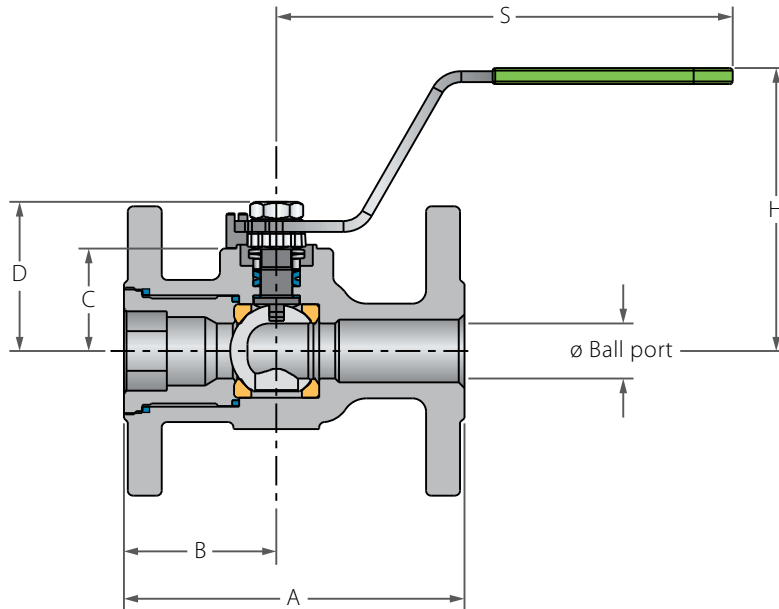

Preparation for actuation

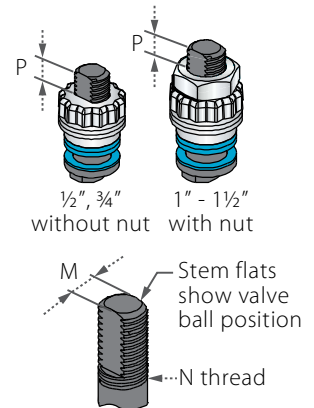

| Std. port | Unit | Ball port1 | Ball port2 | A | | B | C | D | H | K | S | W | | M | N | P | F | Weight kg/lb | | | Kv |
|-----------|------|------------|------------|--------|--------|-------|-------|-------|--------|--------|--------|--------|--------|------|------|------------|-------|--------------|------|-----|----|
| | | | | 150 | 300 | | | | | | | 150 | 300 | | | | | 150 | 300 | Cv | |
| DN15 | mm | 13.50 | 11.15 | 108.00 | 140.00 | 46.00 | 29.00 | 38.00 | 92.00 | 70.00 | 151.00 | 88.90 | 95.25 | 5.54 | 3/8 | 6.65 (F03) | 36.00 | 1.7 | 2.4 | 2.8 | |
| 1/2" | inch | 0.53 | 0.44 | 4.25 | 5.50 | 1.81 | 1.14 | 1.50 | 3.62 | 2.76 | 5.94 | 3.50 | 3.75 | 0.22 | UNF | 0.26 | 1.42 | 3.8 | 5.3 | 3.3 | |
| DN20 | mm | 17.50 | 14.30 | 117.00 | 152.00 | 49.00 | 31.40 | 40.30 | 94.00 | 85.00 | 151.00 | 98.55 | 163.07 | 5.54 | 3/8 | 6.65 (F03) | 36.00 | 2.3 | 3.3 | 4 | |
| 3/4" | inch | 0.69 | 0.56 | 4.61 | 6.00 | 1.93 | 1.24 | 1.59 | 3.70 | 3.35 | 5.94 | 3.88 | 6.42 | 0.22 | UNF | 0.26 | 1.42 | 5.1 | 7.3 | 5 | |
| DN25 | mm | 23.50 | 20.60 | 127.00 | 165.00 | 57.00 | 38.20 | 55.60 | 103.50 | 90.00 | 170.00 | 107.95 | 123.95 | 7.54 | 7/16 | 7.40 (F04) | 42.00 | 3.1 | 4.6 | 8 | |
| 1" | inch | 0.93 | 0.81 | 5.00 | 6.50 | 2.25 | 1.50 | 2.19 | 4.07 | 3.54 | 6.69 | 4.25 | 4.88 | 0.30 | UNF | 0.29 | 1.65 | 7.3 | 10.2 | 9 | |
| DN40 | mm | 39.00 | 31.80 | 165.00 | 190.00 | 62.00 | 43.60 | 73.10 | 119.20 | 110.00 | 220.50 | 127.00 | 155.52 | 8.71 | 1/2 | 8.50 (F05) | 50.00 | 5.5 | 8.7 | 40 | |
| 1 1/2" | inch | 1.54 | 1.25 | 6.50 | 7.50 | 2.44 | 1.72 | 2.88 | 4.70 | 4.33 | 8.68 | 5.00 | 6.10 | 0.34 | UNF | 0.33 | 1.97 | 12.2 | 19.3 | 46 | |
| DN50 | mm | 48.00 | 38.20 | 178.00 | 216.00 | 68.00 | 48.30 | 77.80 | 123.90 | 130.00 | 220.50 | 152.40 | 165.10 | 8.71 | 9/16 | 8.50 (F05) | 50.00 | 8.1 | 10.8 | 42 | |
| 2" | inch | 1.89 | 1.50 | 7.00 | 8.50 | 2.67 | 1.90 | 3.06 | 4.88 | 5.12 | 8.68 | 6.00 | 6.50 | 0.34 | UNF | 0.33 | 1.97 | 18 | 24 | 49 | |



Side Entry Floating Ball Flanged

Components & materials

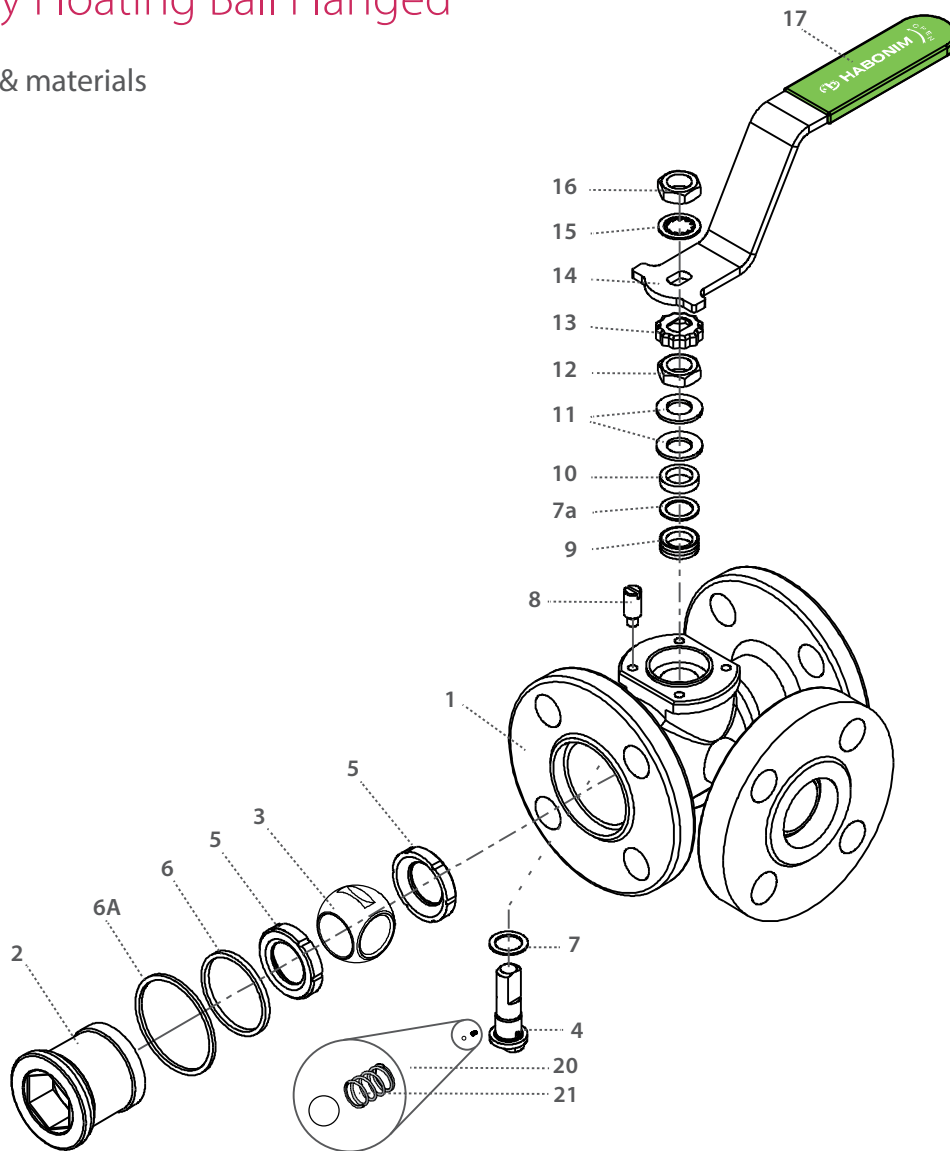

| Item | Description | Material specification | Qty. |
|------|--------------------|------------------------------|------|
| 1 | Body | Acc. Ordering Code | 1 |
| 2 | Plug | Acc. Ordering Code | 1 |
| 3 | Ball | Acc. Ordering Code | 1 |
| 4 | Stem | Acc. Ordering Code | 1 |
| 5* | Seat | Acc. Ordering Code | 2 |
| 6* | Body seal | PTFE | 1 |
| 6A | Outer seal | Acc. Ordering Code | 1 |
| 7* | Stem thrust seal | PEEK, CF PEEK, PCTFE (KEL-F) | 1 |
| 7a | Anti-abrasion ring | PEEK, CF PEEK, PCTFE (KEL-F) | 1 |
| 8 | Stop pin | S. Steel | 1 |
| 9* | Stem seal | CF PTFE, TFM | 1 |
| 10 | Follower | S. Steel | 1 |

| Item | Description | Material specification | Qty. |
|------|---------------------|------------------------|------|
| 11 | Disc spring | S. Steel | 2 |
| 12 | Stem nut | S. Steel | 1 |
| 13 | Locking clip | S. Steel | 1 |
| 14 | Handle | S. Steel | 1 |
| 15 | Serrated washer | S. Steel | 1 |
| 16 | Handle nut | S. Steel | 1 |
| 17 | Sleeve | PVC | 1 |
| 20 | Anti-static spring | S. Steel | 1 |
| 21 | Anti-static plunger | S. Steel | 1 |
| 23 | Tag (not shown) | S. Steel | 1 |

* Repair kit components

Side Entry Floating Ball Flanged

Valve dimensions

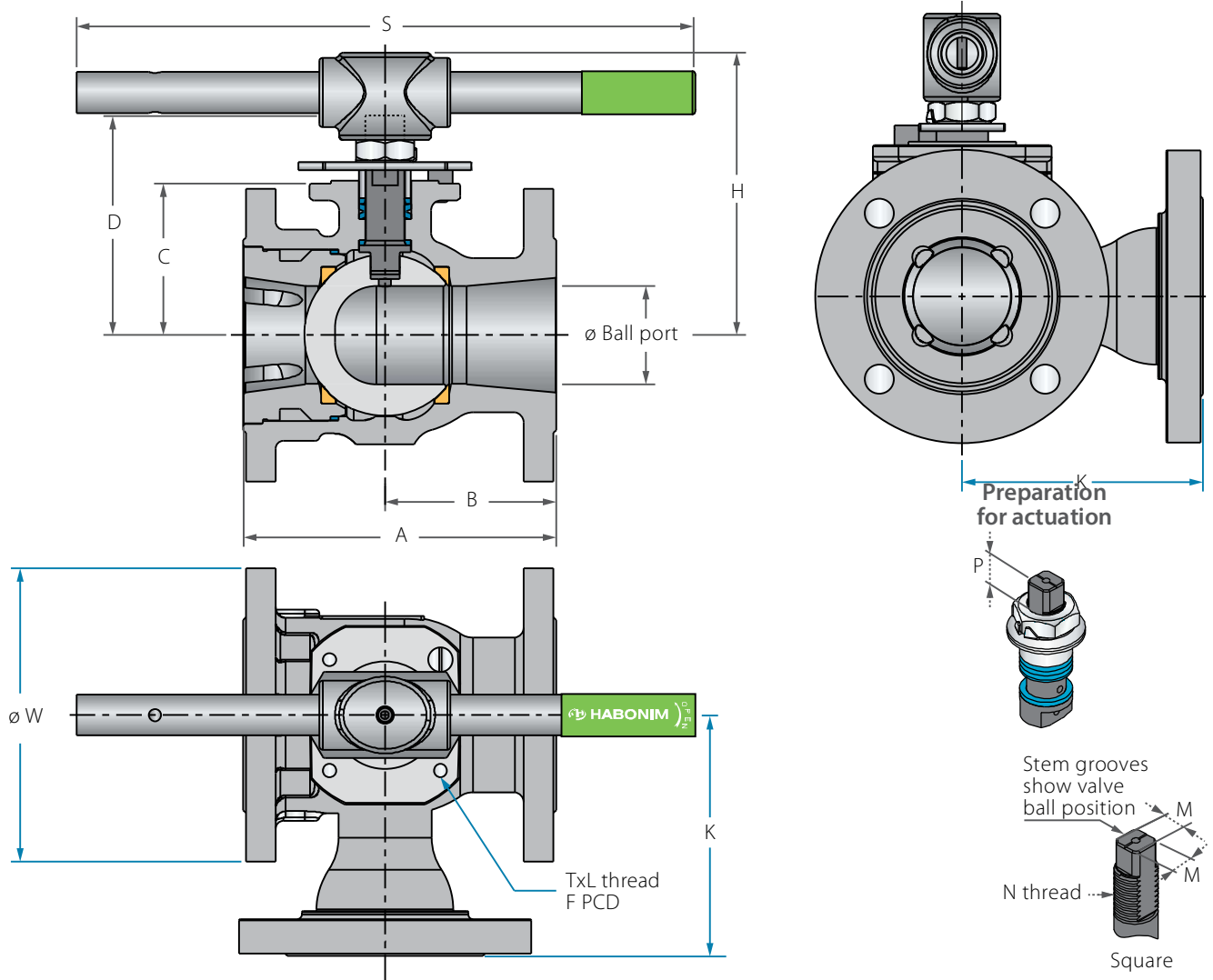

| Std. port | Unit | Ball port1 | Ball port2 | A | | B | C | D | H | K | S | W | | M | M-DD | N | P | F | TxL | Weight kg/lb | | Kv |
|-----------|------|------------|------------|--------|--------|--------|--------|--------|--------|--------|--------|--------|--------|-------|-------|--------|-------------|--------|--------|--------------|--------|-----|
| | | | | 150 | 300 | | | | | | | 150 | 300 | | | | | | | 150 | 300 | |
| DN80 | mm | 63.50 | 50.00 | 203.00 | 284.00 | 92.00 | 98.40 | 145.00 | 185.10 | 153.00 | 400.00 | 190.50 | 209.55 | 18.90 | 15.90 | 1"-14 | 16.70 (F10) | 102.00 | M10x20 | 18.00 | 22.70 | 129 |
| 3" | inch | 2.50 | 1.97 | 8.00 | 11.18 | 3.62 | 3.88 | 5.72 | 7.28 | 6.02 | 15.75 | 7.50 | 8.25 | 0.74 | 0.63 | UNS-2A | 0.66 | 4.02 | M10x20 | 40.00 | 50.40 | 150 |
| DN100 | mm | 82.60 | 63.00 | 229.00 | 305.00 | 102.00 | 114.10 | 161.00 | 201.00 | 185.00 | 610.00 | 228.60 | 254.00 | 18.90 | 15.90 | 1"-14 | 16.70 (F10) | 102.00 | M10x20 | 28.20 | 36.30 | 182 |
| 4" | inch | 3.25 | 2.48 | 9.00 | 12.00 | 4.00 | 4.49 | 6.34 | 7.91 | 7.28 | 24.01 | 9.00 | 10.00 | 0.74 | 0.63 | UNS-2A | 0.66 | 4.02 | M10x20 | 62.80 | 80.60 | 211 |
| DN150 | mm | 111.10 | 78.00 | 267.00 | 403.20 | 108.00 | 157.40 | 226.00 | 285.90 | 250.00 | 916.00 | 279.40 | 317.50 | 28.45 | 23.75 | 1½"-12 | 26.20 (F12) | 125.00 | M12x20 | 41.00 | 69.00 | 437 |
| 6" | inch | 4.38 | 3.07 | 10.50 | 15.88 | 4.25 | 6.20 | 8.91 | 11.25 | 9.84 | 36.08 | 11.00 | 12.50 | 1.12 | 0.94 | UNF-2A | 1.03 | 4.92 | M12x20 | 91.00 | 153.00 | 507 |
| DN200 | mm | 144.40 | 98.00 | 292.00 | 419.00 | 163.50 | 185.20 | 254.00 | 313.60 | 300.00 | 916.00 | 342.90 | 381.00 | 28.45 | 23.75 | 1½"-12 | 26.20 (F12) | 125.00 | M12x20 | 82.00 | 105.00 | 698 |
| 8" | inch | 5.68 | 3.86 | 11.50 | 16.50 | 5.37 | 7.30 | 10.00 | 12.34 | 11.81 | 36.08 | 13.50 | 15.00 | 1.12 | 0.94 | UNF-2A | 1.03 | 4.92 | M12x20 | 182.00 | 233.00 | 810 |



Side Entry Floating Ball Flanged

Components & materials

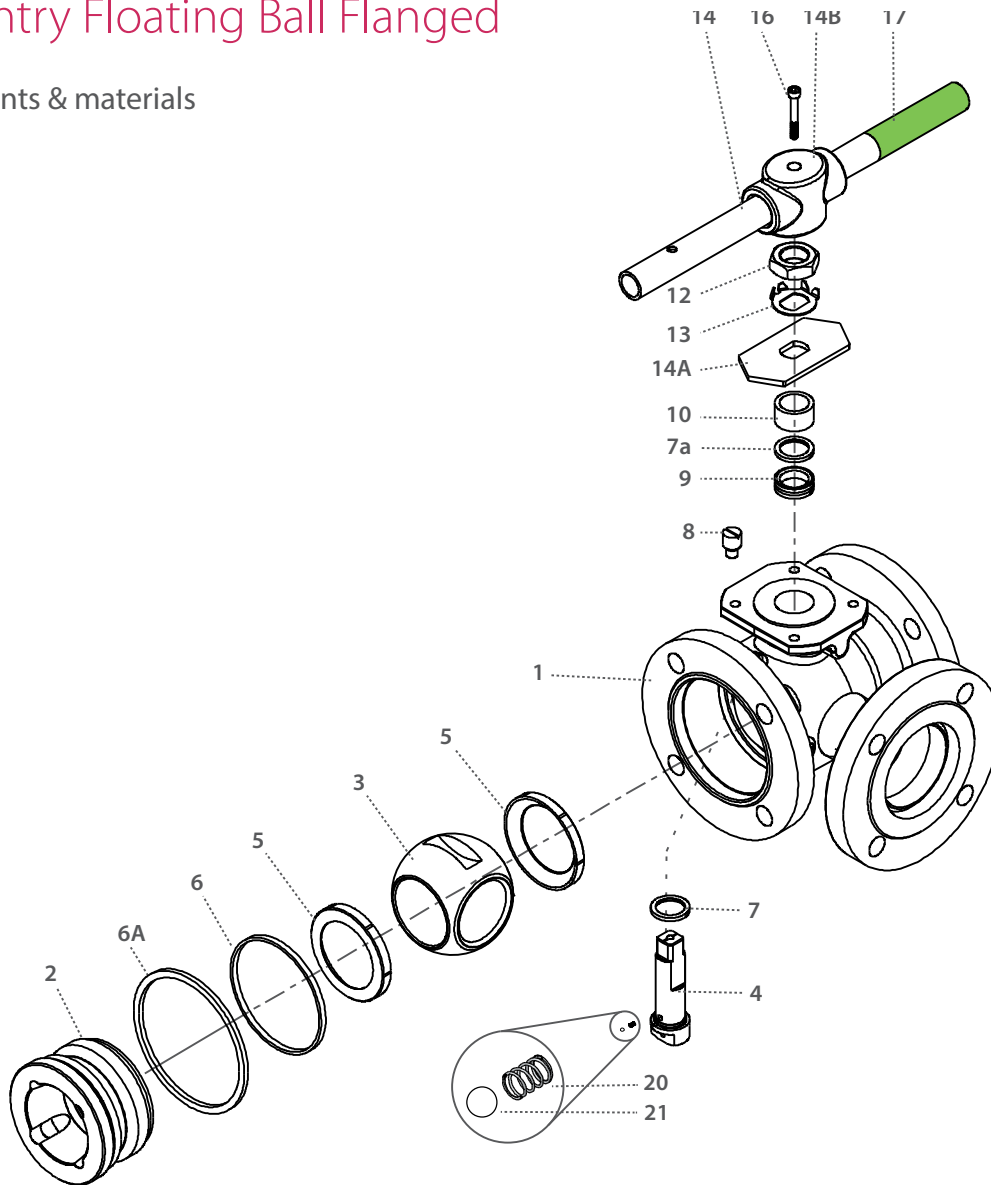

| Item | Description | Material specification | Qty. |
|------|--------------------|------------------------------|------|
| 1 | Body | Acc. Ordering Code | 1 |
| 2 | Plug | Acc. Ordering Code | 1 |
| 3 | Ball | Acc. Ordering Code | 1 |
| 4 | Stem | Acc. Ordering Code | 1 |
| 5* | Seat | Acc. Ordering Code | 2 |
| 6* | Body seal | PTFE | 1 |
| 6A | Outer seal | Acc. Ordering Code | |
| 7* | Stem thrust seal | PEEK, CF PEEK, PCTFE (KEL-F) | 1 |
| 7a | Anti-abrasion ring | PEEK, CF PEEK, PCTFE (KEL-F) | 1 |
| 8 | Stop pin | S. Steel | 1 |
| 9* | Stem seal | CF PTFE, TFM | 1 |
| 10 | Follower | S. Steel | 1 |

| Item | Description | Material specification | Qty. |
|------|---------------------|------------------------|------|
| 11 | Disc spring | S. Steel | 2 |
| 12 | Stem nut | S. Steel | 1 |
| 13 | Tab lock washer | S. Steel | 1 |
| 14 | Handle | S. Steel | 1 |
| 14A | Stop plate | S. Steel | 1 |
| 14B | Wrench head | S. Steel | 1 |
| 16 | Wrench bolt | S. Steel | 1 |
| 17 | Sleeve | PVC | 1 |
| 20 | Anti-static spring | S. Steel | 2 |
| 21 | Anti-static plunger | S. Steel | 2 |
| 23 | Tag (not shown) | S. Steel | 1 |

* Repair kit components

D31

S31

D32

S32



Diverter I Side Entry Floating Ball Flanged - Ordering Code System

"Mandatory option" options are marked with **green background** | "Standard offer" options are marked with **light green background**

| | | | | | | | | | | | | | | | | | | | | | | | | | | | | |
|------|---|----------|---|---|---|--------|---|--------|----|-------------------|----|--------------------|----|---------------|---------------------|---------------------|----|----------------|----|----|----------|----|------------------|---|----|---|---|----|
| 1 | 2 | 3 | 4 | 5 | 6 | 7 | 8 | 9 | 10 | 11 | 12 | 13 | 14 | 15 | 16 | 17 | 18 | 19 | 20 | 21 | 22 | 23 | 24 | # | 26 | . | . | 30 |
| 6 | 0 | | | | D | 3 | 1 | X | - | 6 | 6 | 6 | 6 | A | T | G | / | B | W | 1 | 0 | 9 | 0 | | | | | |
| Size | | Features | | | | Series | | Design | | Body/end material | | Ball/Stem material | | Seat material | Inner Seal material | Outer Seal material | | End connection | | | Rotation | | Special features | | | | | |

| Size (1-2) | | |
|------------|------|-----|
| Code | inch | mm |
| 05 | ½" | 15 |
| 07 | ¾" | 20 |
| 10 | 1" | 25 |
| 15 | 1½" | 40 |
| 20 | 2" | 50 |
| 30 | 3" | 80 |
| 40 | 4" | 100 |
| 60 | 6" | 150 |
| 80 | 8" | 200 |

| Features (3-6) | |
|----------------|--------------------------------|
| D | Diverter bottom entry |
| O | Clean assembly for O2 service |
| Series (7-8) | |
| D31 | ANSI #150 flanged bottom entry |
| S31 | ANSI #150 flanged side entry |
| D32 | ANSI #300 flanged bottom entry |
| D32 | ANSI #300 flanged side entry |

| Design (9) | |
|------------|----------------------------------|
| X | Total HermetiX Integrity package |

| Body/Ends material (11-12) | |
|----------------------------|------------------------|
| 6 | S. SteelCF8M/CF3M |
| 4 | C. steel A216 WCB/A105 |
| D | Duplex A479 |
| K | Super Duplex A479 |
| S | 254SMO A479 |

| Ball material (13) | |
|--------------------|------------------------|
| 6 | S. SteelCF8M/CF3M |
| M | High Strength S. Steel |
| S | 254SMO |
| D | Duplex |
| K | Super Duplex |

| Stem material (14) | |
|--------------------|------------------------|
| 6 | S. Steel316L |
| M | High Strength S. Steel |
| Z | Inconel 718 B637 |
| D | Duplex A479 |
| K | Super Duplex A479 |
| S | 254SMO A479 |

| Seat material (15) | |
|--------------------|-------------|
| A | TFM |
| P | CF PTFE |
| K | CF PEEK |
| L | Virgin Peek |
| U | UHMWPE |
| C | PCTFE |
| Y | Delrin |
| W | PVDF |
| T | PTFE |

| Inner Seal Material (16) | |
|--------------------------|-------------------|
| T | PTFE |
| A | TFM |
| G | Expanded graphite |
| U | UHMWPE |
| V | Viton |
| B | NBR |

| Outer Seal (17) | |
|-----------------|-------------------|
| G | Expanded graphite |
| T | PTFE |
| A | TFM |
| U | UHMWPE |
| V | Viton |
| B | NBR |

| End Connection (19-22) | |
|------------------------|--------------------|
| Flanged | |
| 150 | ASME B16.5 #150 RF |
| 300 | ASME B16.5 #300 RF |
| PN16 | EN1092 PN16 RF |
| PN40 | EN1092 PN40 RF |

| Rotation (23 -25) | |
|-------------------|---|
| 90 | 90 degrees rotation |
| 180 | 180 degrees rotation applicable for bottom entry diverter valve L |

| Special Features (24-30) | |
|--------------------------|--|
| Valve Special Stem Seals | |
| HC | High Cycle service |
| AAX | FDA compliant stem seal. TFM thrust bearing and X shape gasket |
| PPX | CF PTFE thrust and X shape gasket |
| CAX | PCTFE thrust and TFM X shape gasket |
| CPX | PCTFE thrust and CF PTFE X shape gasket |
| HYD | Hydrogen |